

REMAINING PORTION

Process ~~22~~ 66368
R.P.O. Vol. 206 Fol. 33
C.T. Vol. 1975 Fol. 297

Vol. 4587 fol. 259

Ward of Siparia
County of St. Patrick
Cadastral Sheet (G.18.C. & D.) 73.C.
2/a

sent to registry

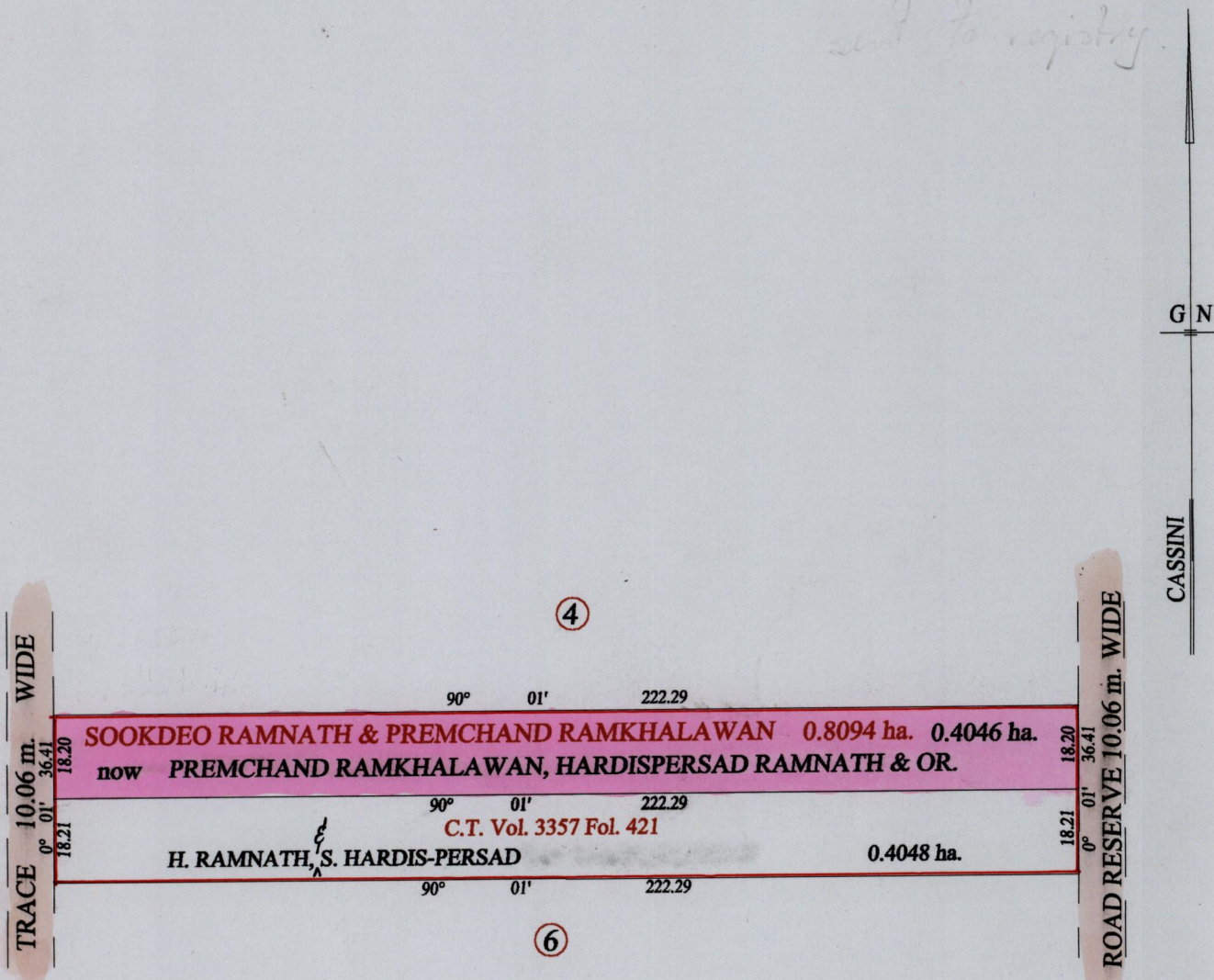

*Original E G 105
Premchand Ramkhalawan
Hardispersad Ramnath & or
Vide Bk. 1189 fol. 91*

Approved *[Signature]*
Director of Surveys
2004-07-01

SCALE : 1:1500

Note: Bearings are cassini grid based on solar observations

Distances are in metres

This is a true copy of a diagram of zero point eight zero nine four hectare, originally transferred to Sookdeo Ramnath & Premchand Ramkhalawan, shewing a portion coloured pink and containing zero point four zero four six hectare being the remainder after one (1) previous transfer of another portion of the land.

In accordance with Regulation 25 (1) of the Land Surveyors' Regulations 1998, I certify that this plan is correct.

Checked by *[Signature]* *[Signature]*

Entered on *[Signature]* ... Trinidad & Tobago Land Surveyor ... *18.05.2004*

