

R.P.O. Vol. 43
 C.T. Vol. 3714

Vol. 4581 fol. 101
 Original

Ref. Bk. 980 / 70
 Bk. 1155 / 308
 Bk. 1110 / 160
 Bk. 1148 / 64
 Bk. 1053 / 899

Process ID# 66252

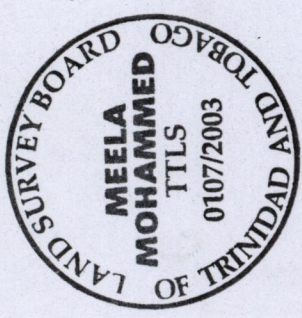

Approved *[Signature]*
 Director of Surveys
 1994.1.16

Bearings are Cassini Grid based on Solar Obs.

PLAN of a Parcel of land coloured PINK in the Ward of Savana Grande
 Containing eight hundred and six point seven square metres
 Surveyed by me, with due authority, in August 2003 for Kenrick Charles
 In accordance with Regulation 25 (1) of the Land Surveyors' Regulations 1998, I certify that this plan is correct.

Checked by *[Signature]*

Entered *[Signature]* 21.05.2013

Ward of Savana Grande
 County of Victoria
 Cadastral Sheet 6. 10. N., 64B
 4/c

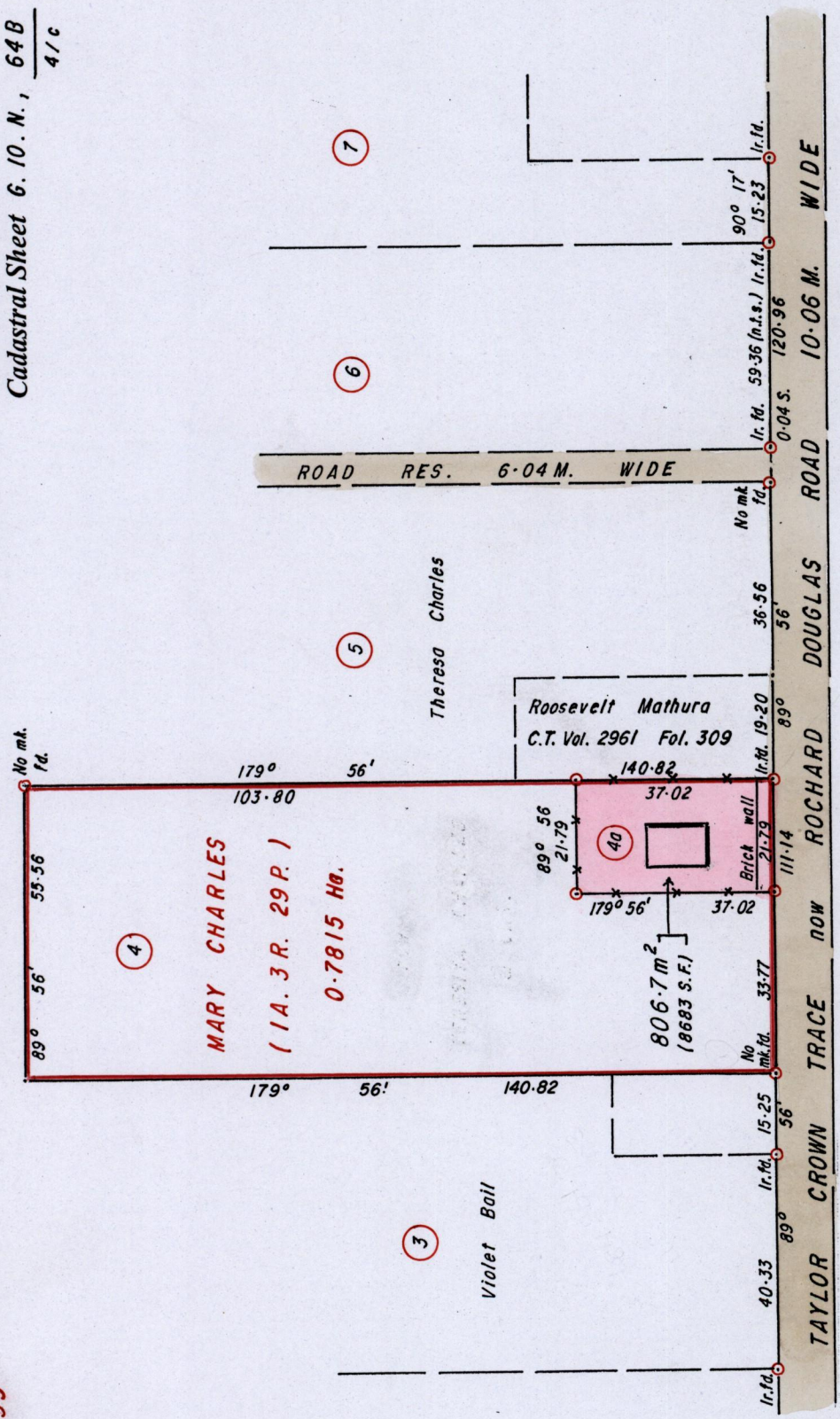

SCALE 1 / 1250

Distances are in METRES

○ Denotes Iron put unless otherwise stated

Tenesuja & Kenrick Charles

--- Chain Link Fence

Checked by *[Signature]*

Trinidad and Tobago Land Surveyor *[Signature]* 26th August 2003.

1308

65

Original Sur. Bk 980:70

4a - TENESIYA + KENRICK CHARLES.

26 AUG 2003
Lands and
Surveys
Division



1279/287