

Process ~~50~~ 66241  
R.P.O. Vol. 426 Fol. 371  
C.T. Vol. 2815 Fol. 231

1308

Ward of Savana Grande  
County of Victoria  
Cadastral Sheet G. 14. H., 64E  
1/a & 1/c

Vol. 4624 fol. 491

Original Ref. Bk. 385 fol. 183  
Bk. 722 fol. 133  
Bk. 1179 fol. 100

Petd for by  
Ballack

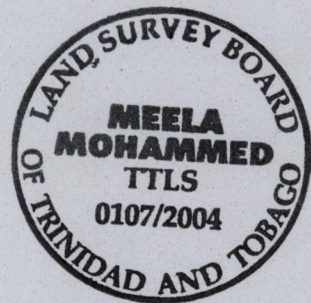
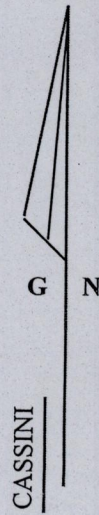
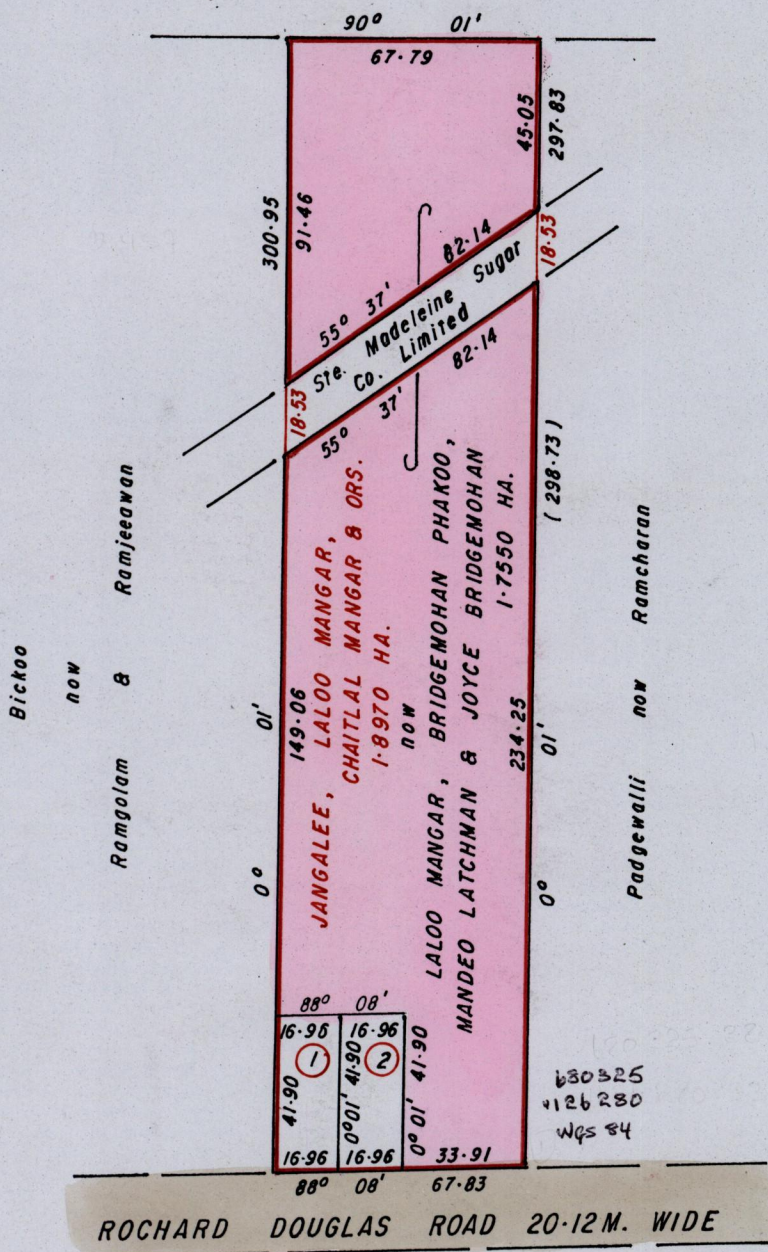

- Lot 1 Mandeo Latchman 710.2 m C.T. Vol. 3272 fol. 445
- Lot 2 Thackoorial Lutchman 710.2 m C.T. Vol. 3272 fol. 453

Approved *[Signature]*  
Director of Surveys  
2004.10.15

Sherry Bissoondai Bridgemohan  
Akai & Parbatie Bridgemohan

Note: To Obtain compass bearings add/subtract minutes

SCALE 1 / 2000  
Distances are in METRES

This is a true copy of a diagram of one point eight nine seven zero hectares originally transferred to Jangalee and Others, showing a portion coloured pink and containing one point seven five five zero hectares being the remainder after two previous transfers of another portion of the land. In accordance with Regulation 25[1] of the Land Surveyors Regulations 1998, I certify that this plan correct.

Checked by *[Signature]*

*Meele Mohammed*

Entered S.M.S. 22.08.2013

Trinidad and Tobago Land Surveyor... 17th. August 2004