

REMAINING PORTION

R.P.O. Vol. 69 Fol. 125

C.T. Vol. 1931 Fol. 239

Vol. 4626 Fol. 225

Process 50#66285

Ward of Turure

County of St. Andrew

Cadastral Sheet E.2.I, 3/d

Ref. Bk. 1211 fol. 76 (Bk. 171 fol. 26)

(Original)

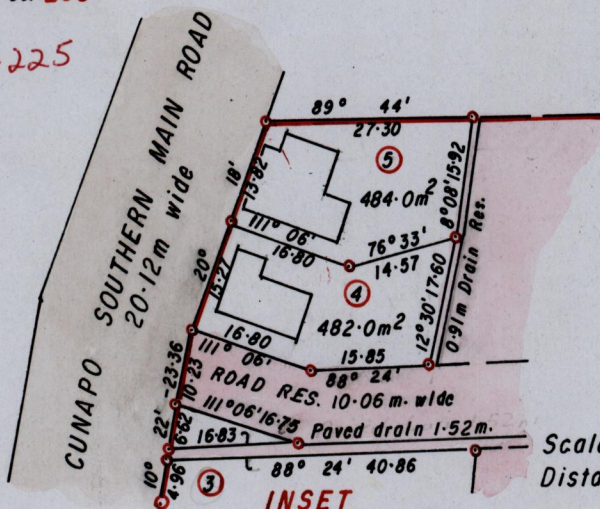

Scale 1/1000
Distances are in metres

Cassini
GN

Ramkissoon Maharade then Ali

STATE
then
Morales

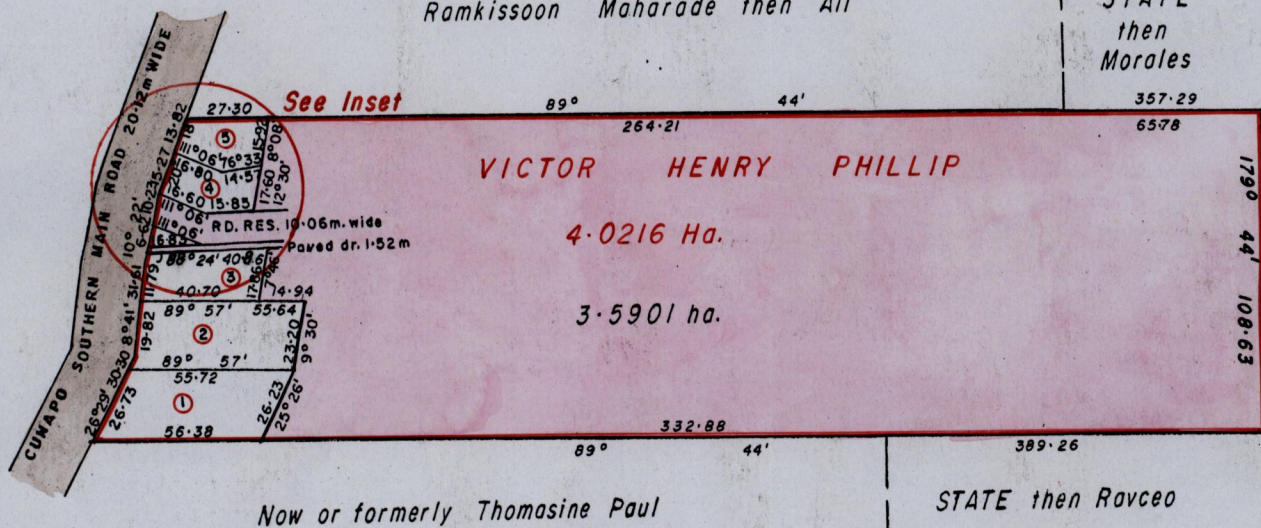

Now or formerly Thomasine Paul

STATE then Ravceo

- ① C.T. Vol. 3584 fol. 495 1333.0m² Olive Phillip
- ② C.T. Vol. 3584 fol. 497 1262.0m² Theodore Charles Phillip
- ③ C.T. Vol. 3584 fol. 499 753.9m² Ausie John Phillip
- ④ C.T. Vol. 3584 fol. 501 482.0m² Zita Francis
- ⑤ C.T. Vol. 3584 fol. 503 484.0m² Dulcie Phillip

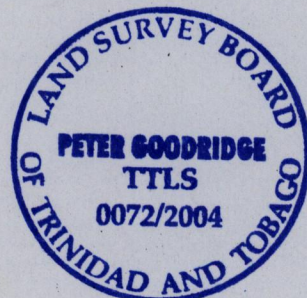

Approved

[Signature]
 Director of Surveys
 2004-11-12

Zita Phillip
Sam, Cidy Lou
Vallentine
 SCALE 1/2500
 Distances are in metres

This is a true copy of a diagram of four point zero two one six hectares

originally

granted to VICTOR HENRY PHILLIP, shewing a portion coloured pink and containing three point five nine zero one hectares being the remainder after 5 previous transfer of another portion of the land. In accordance with regulation 25 (1) of the Land Surveyors' Regulations 1998, I certify that this plan is correct.

Checked by M.M. 27/10/04

Entered on Belmate

[Signature]
 TTLS

Trinidad & Tobago Land Surveyor... 10th August 2004