

REMAINING PORTION

Process ID#66275  
R.P.O. Vol. 800 Fol. 309  
C.T. Vol. 2656 Fol. 501  
VOL. 4590 Fol. 129

Ward of Siparia.  
County of St. Patrick.  
Cadastral Sheet G.17.E. 73A  
1/a

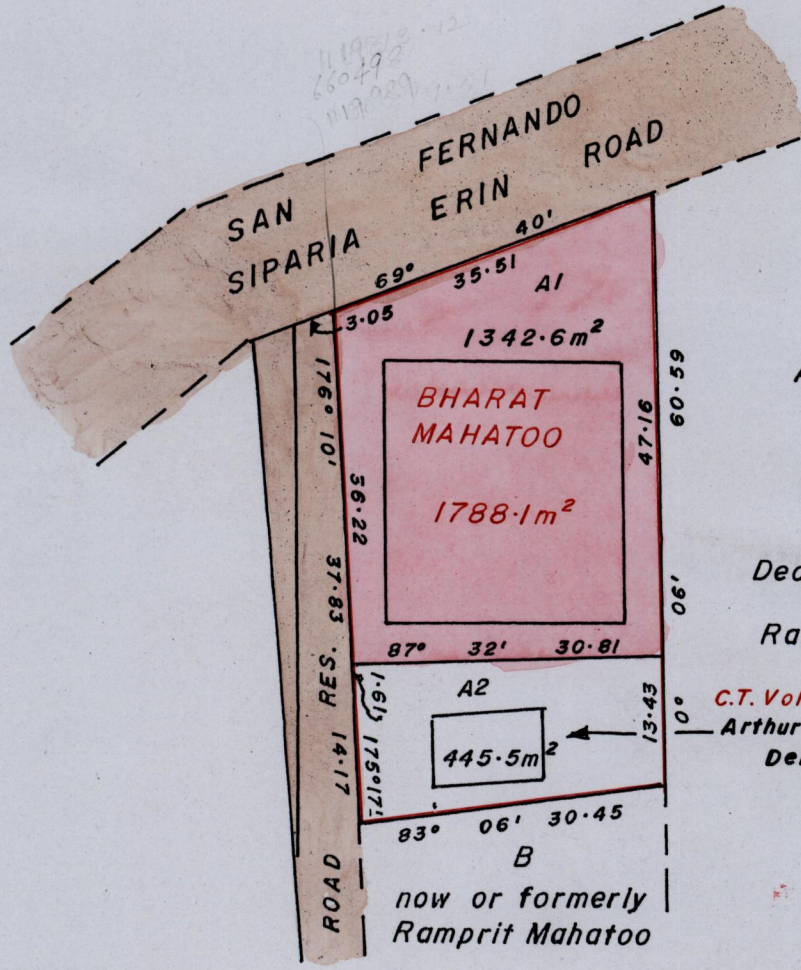

Allotment  
6  
now

Deokiesingh &  
Ramdoolarie

C.T. Vol. 4301 Fol. 169  
Arthur Chen Noel &  
Debby Leben

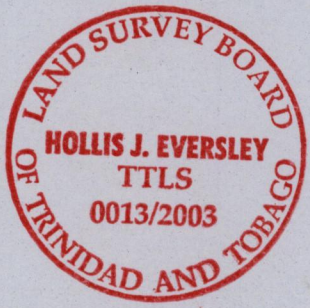
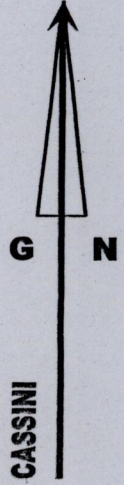

Rajesh & Bhagwandayee Harry

Approved *[Signature]*  
Director of Surveys.  
25 Feb 2013

Orig: Bk. 1128 :36  
" 1256:77  
Distances are in METRES.  
Scale 1 : 750.

This is a true copy of a diagram of one thousand seven hundred and eighty eight point one square metres originally transferred to BHARAT MAHATOO, showing a portion coloured pink and containing one thousand three hundred and forty two point six square metres being the remainder after one previous transfer of another portion of the land In accordance with Reg. 25(1) of the Land Surveyors' Regulations 1998, I certify that this plan is correct.

Checked by *M.I. 19.1.04*  
Entered *[Signature]* Trinidad and Tobago Land Surveyor. *10<sup>th</sup> Oct 2003*