

R.P.O. Vol. 14 Fol. 173

Cadastral Sheet G.12.A. $\frac{63D}{2/a}$

C.T. Vol. 2967 Fol. 381

Ward of Siparia

Vol. 4610 Fol. 487

County of St. Patrick

Original Sko 1148:80

Process ID 46615

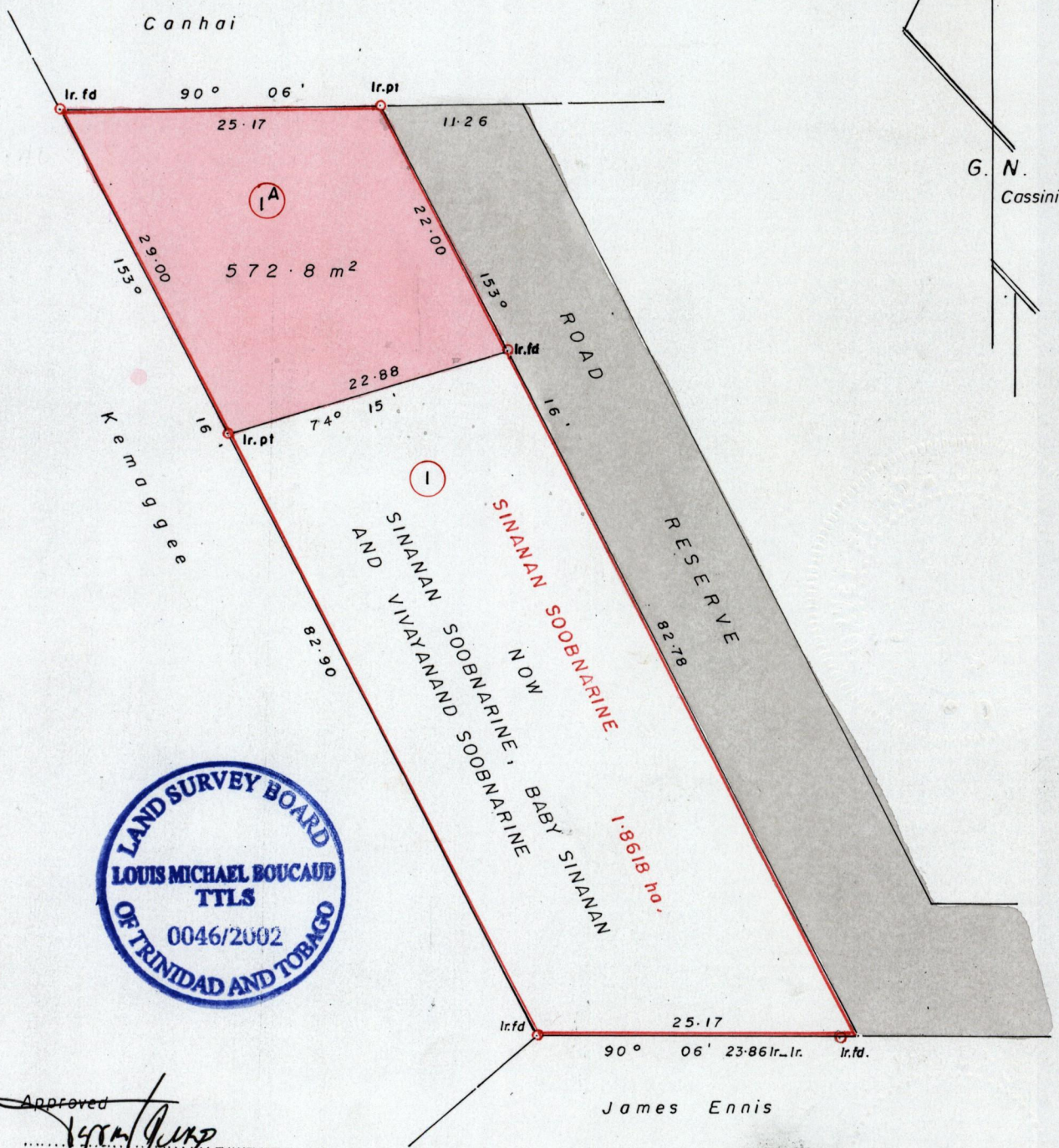

Approved
[Signature]
 Director of Surveys
 15/04/13

James Ennis

cf : L&S Bks. 456 Fol. 174
1148 " 80

Baby Sinanan, Sinanan Soobnarine, Vivayanand Soobnarine
 SCALE : 1/500

Note: To obtain compass bearings subtract 6 minutes.

Distances are in metres

PLAN of a Parcel of land coloured pink in the Ward of Siparia
 Containing five hundred and seventy two point eight square metres

Prepared
~~Surveyed~~ by me with due authority in June 2002 from a survey by Mr. G.R. Jardine in August 2001.
 In accordance with Regulation 25(1) of the Land Surveyors' Regulations 1998,
 I certify that this plan is correct.

Checked by *[Signature]* 19/11/02

[Signature]
 Trinidad & Tobago Land Surveyor

Entered *[Signature]* 19.09.2002

Trinidad & Tobago Land Surveyor 28th June 2002