

Vol 4556 Fol 421

R.P.O. Vol. 59 Fol. 323

C.T. Vol. 2643 Fol. 321

Vide Bk. 1137 fol. 186

" " 1197 " 98

Process ID# 6603

Original

Remaining Portion

Cadastral Sheet G.13.B. & F. 63F
1/a & 1/c

Ward of Naparima
County of Victoria

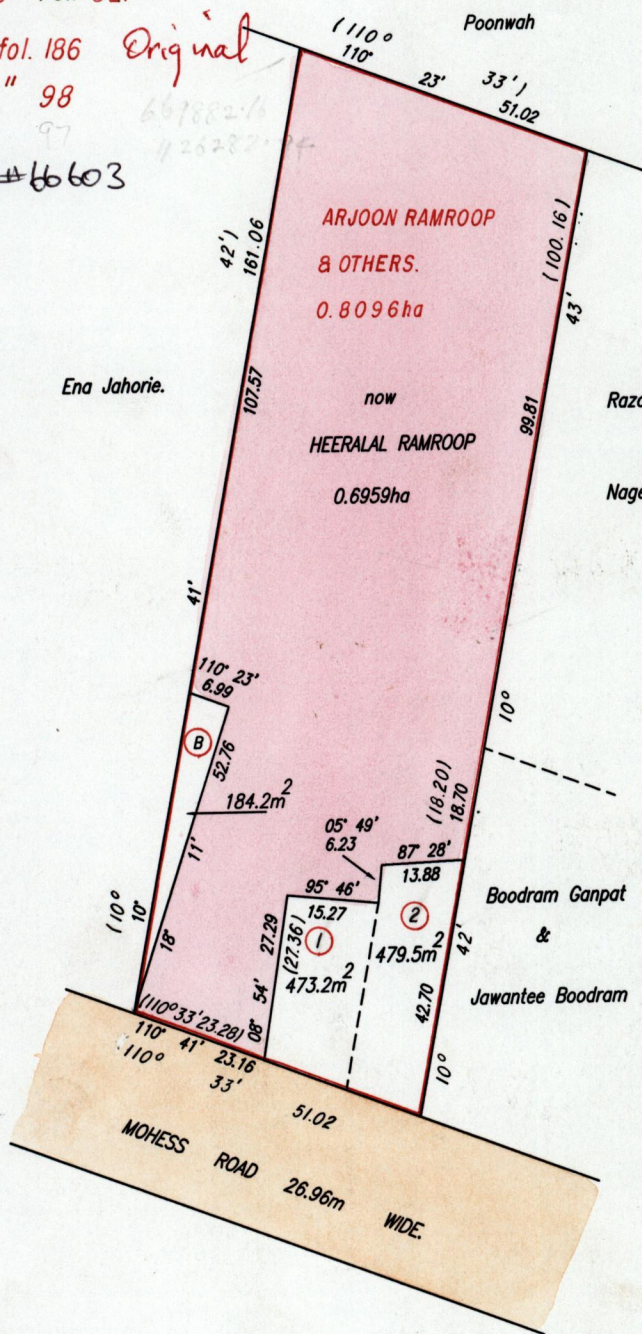

| Lot No. | Name | Ref |
|---------|---------------------|--------------------------|
| 1 | D. & S. Harripersad | C.T.Vol.2806 Fol 391 |
| 2 | S. & P. Mohammed | C.T.Vol.3296 Fol. 223 |
| B | Ena Jahorie | C.T.Vol.3377 Fol 195 |

Andrew Bridgell

Approved

[Signature]
Director of Surveys

SCALE 1:1250

Distances are in Metres

Bearings are based on Solar Observations

This is a true copy of a diagram of zero point eight zero nine six hectare originally transferred to Arjoon Ramroop & Others, showing a portion coloured pink and containing zero point six nine five nine hectare being the remainder after three previous transfer of other portions of land.

In accordance with Regulation 25(1) of the Land Surveyors' Regulations 1998, I certify that this plan is correct.

Checked by *[Signature]* 27/01/04 .. *[Signature]* ..

Entered on *[Signature]* 27/01/04 .. Trinidad & Tobago Land Surveyor *[Signature]* 16th January .. 2003

