

No 27523

Process ~~LD~~ 66319

R.P.O. Vol. 19
C.T. Vol. 1113

Fol. 453
Fol. 177

Ward of La Brea
County of St. Patrick
Cadastral Sheet G.6.0. $\frac{62.C.}{4/c}$

Vol. 4516

Fol. 231

Vide: Bk. 712 Fol. 151

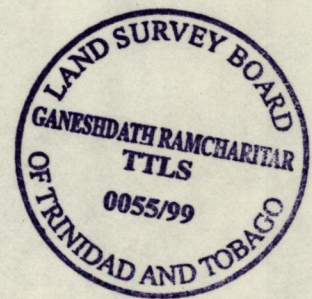
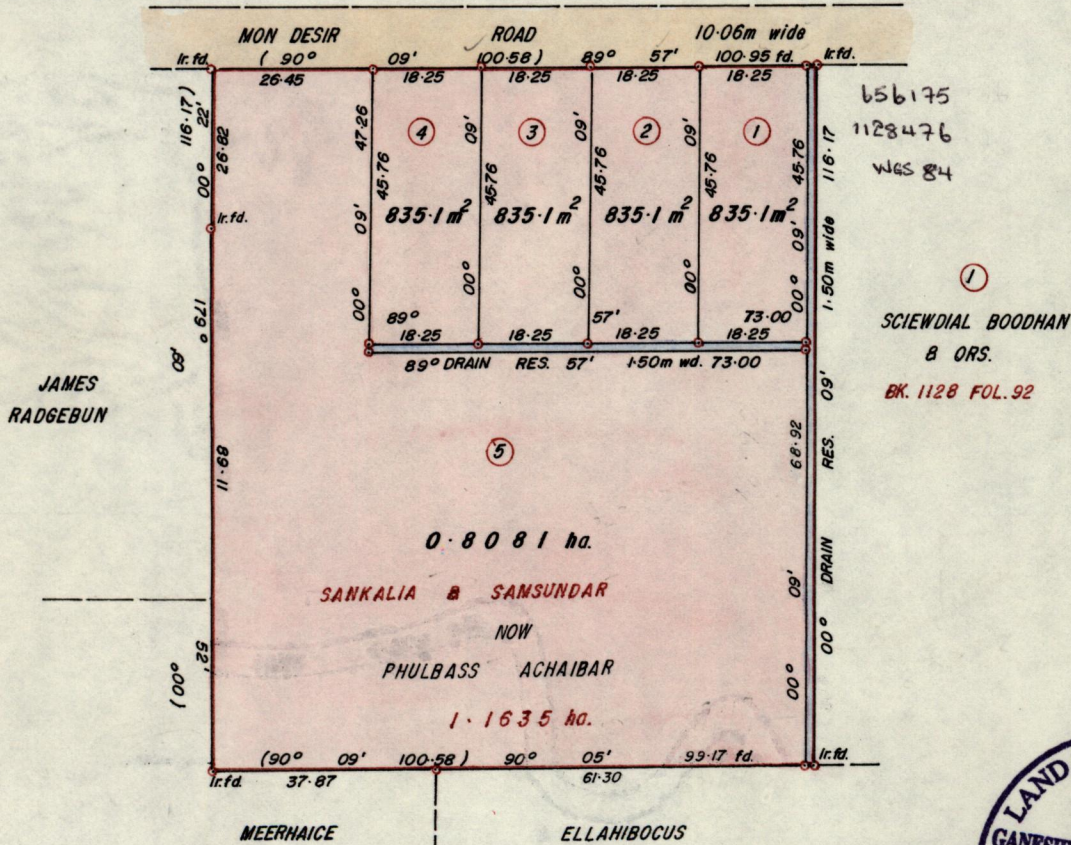

Approved

[Signature]
 Director of Surveys
 99.8.11

Bearings are Cassini Grid, based on Solar Observations
 Note: To obtain compass bearings add/subtract

• Denotes Iron put except otherwise stated

SCALE 1:1250

minutes

Distances are in metres

PLAN of 5 Parcels of land coloured pink in the Ward of La Brea
 Containing together eleven thousand, four hundred and twenty one point four square metres
 Surveyed by me, with due authority, in July 20th. 1994

I certify that I have complied with rule 76 under section 14(2)(d) of the
 Land Surveyors' Ordinance 1952, and that this plan is correct.

Checked by *AP 99/07/16*

[Signature]
 Land Surveyor, Trinidad and Tobago

Entered CHS *R-09-2015*

12/8/94
 Land Surveyor, Trinidad and Tobago

Original Survey Bk. 715 fol. 100

Lot 1 Vol. 4516 fol. 237 Cecilia & Sheldon Baboolal /

Lot 2 Vol. 4516 fol. 245 Indra Baboolal -

Lot 3 Vol. 4516 fol. 253 Lalchand & Vidya Rambharose -

Lot 4 Vol. 4516 fol. 261 Lalchand & Vidya Rambharose -

Lot 5 Vol. 4516 fol. 269 Phulbas Sita Ramlogan -

