

Process JDA 66345  
 R.P.O. Vol. 219 Fol. 605  
 C.T. Vol. 941 Fol. 77

REMAINING PORTION

Ward of Siparia  
 County of St. Patrick  
 Cadastral Sheet G. 13. G.,  $\frac{63F}{11d}$

VOL 4589 FOL 115

Ref. Bk. 1197 fol. 103  
 Bk. 957 fol. 771  
 Bk. 798 fol. 206

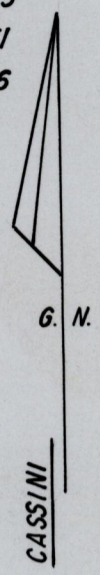
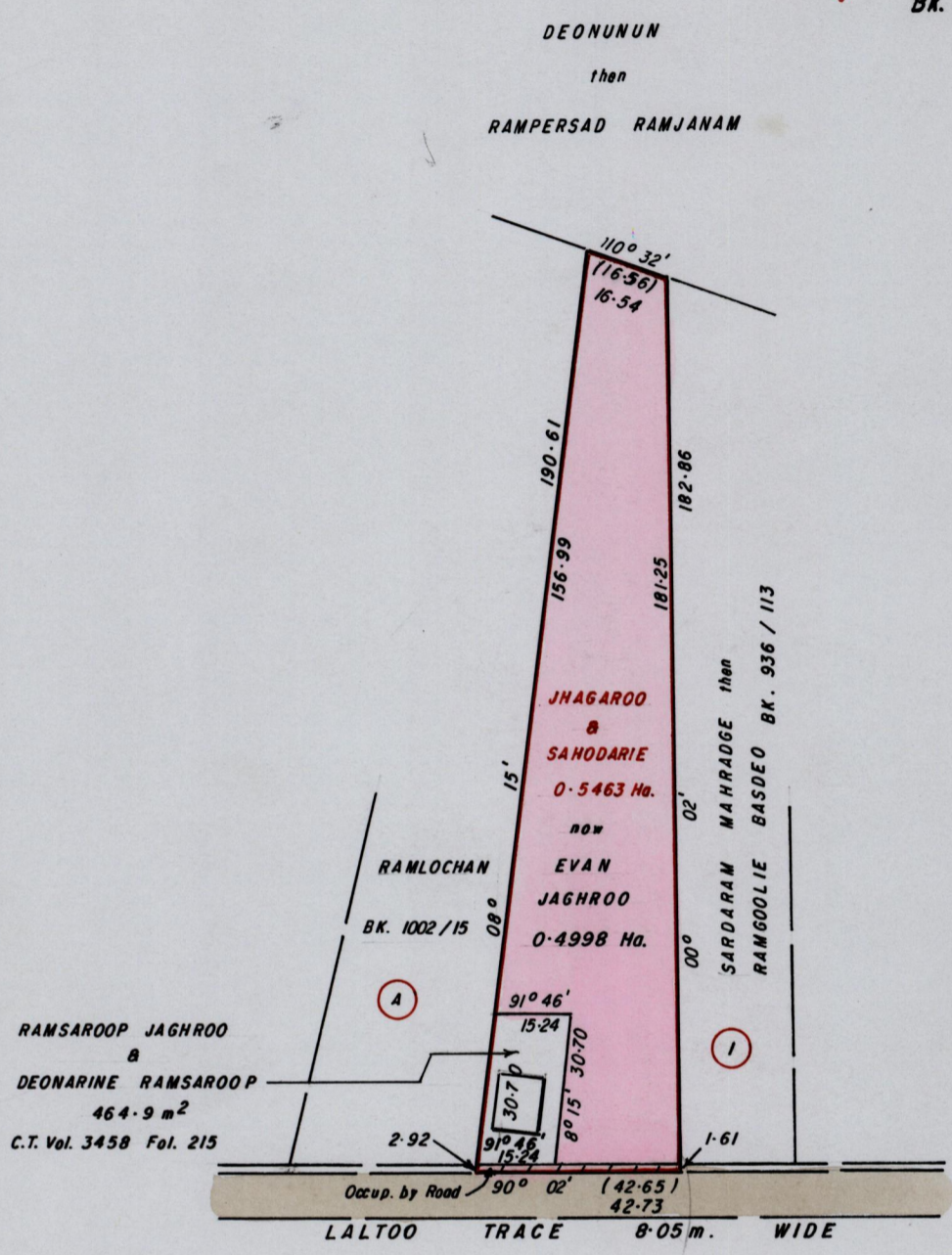

Approved *[Signature]*  
 Director of Surveys  
 2024.8.4

Evan Jaghroo

Note: To Obtain compass bearings add/subtract

minutes

SCALE 1/1500  
 Distances are in METRES

This is a true copy of a diagram of zero point five four six three hectare originally transferred to Jhagaroo & Sahodarie, showing a portion coloured pink and containing zero point four nine nine eight hectare being the remainder after one (1) previous transfer of another portion of the land. In accordance with Regulation 25[1] of the Land Surveyors' Regulations 1998, I certify that this plan correct.

Checked by *[Signature]* Meela Mohammed  
 Entered *[Signature]* Trinidad and Tobago Land Surveyor 25th June 2004