

Vol 4554 Fol 509.

1308

114

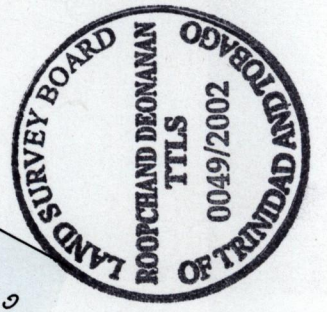

Ward of Naparima
County of Victoria
Cadastral Sheet G.13.G. 63F
1/b,1/d

R.P.O. Vol. 308 fol. 633
C.T. Vol. 1170 fol. 103
Vide Bk. 1010 fol. 135
" " 980 " 23
" " 427 " 178

Process No. 66288

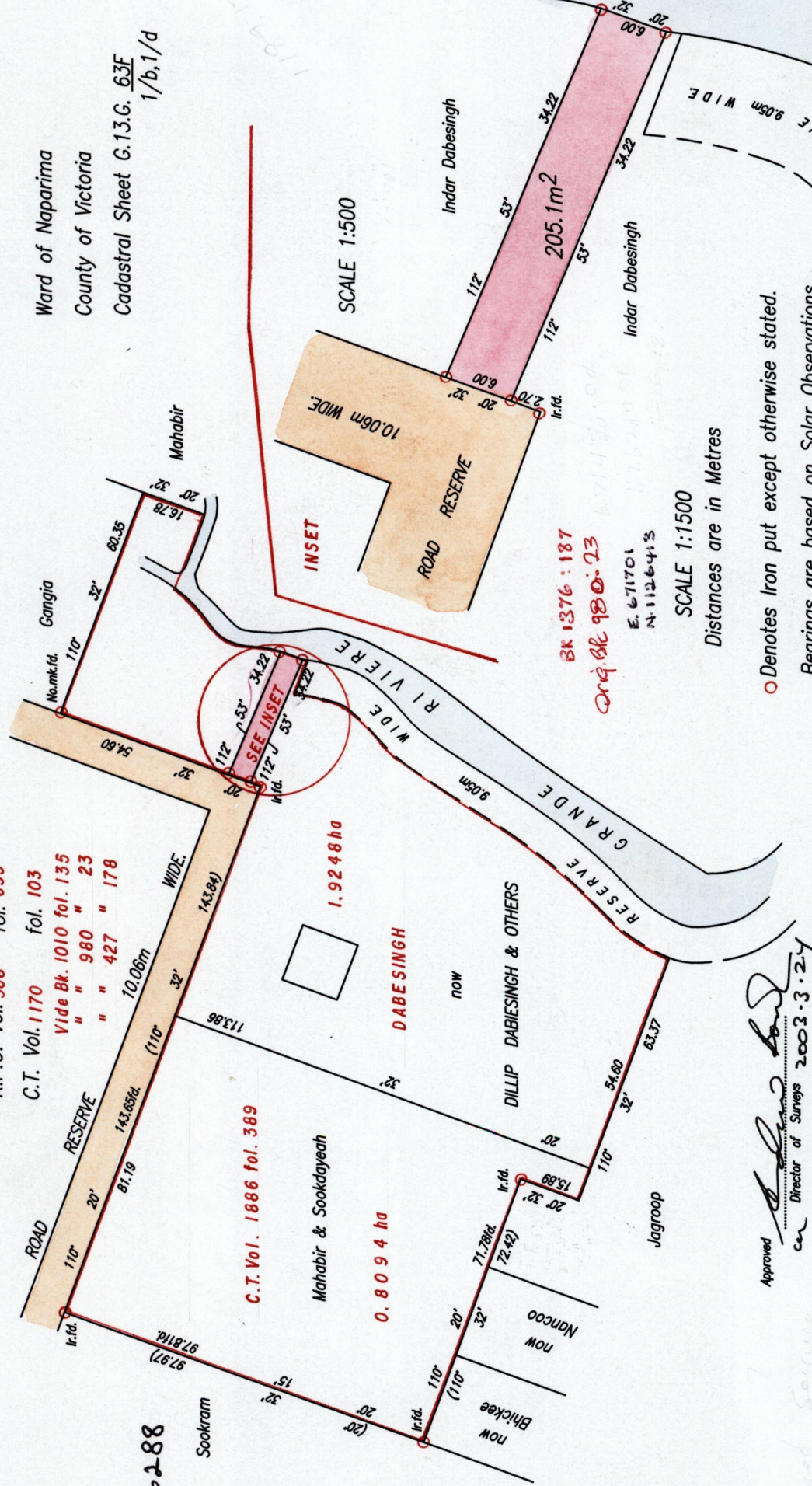

BK 1376 : 187
Orig. Bl. 980 : 23
E. 671701
N. 112641'S

SCALE 1:1500
Distances are in Metres

○ Denotes Iron put except otherwise stated.
Bearings are based on Solar Observations

Approved
[Signature]
Director of Surveys 2003.3.24

Plan of a Parcel of land coloured pink in the Ward of Naparima
Containing two hundred and five point one square metres.
Surveyed by me, with due authority, in September, 2001
In accordance with regulation 25(1) of the Land Surveyors Regulations 1998,

I certify that this plan is correct.

[Signature]
Checked by.....
Entered on.....

Trinidad & Tobago Land Surveyor . . . 31st May .2002
PATH = E:\700 C:\Drawings\0abesingh.dwg.