

REMAINING PORTION

R.P.O. Vol. 211 Fol. 249

C.T. Vol. 956 Fol. 9

Remaining Portion Plan R.P.O. Vol. 956 Fol. 7

Cadastral Sheet G.13.J 63E 63F  
Ward of Siparia  
County of St. Patrick

Vol 4554 fol 491

Process 52+ 66258

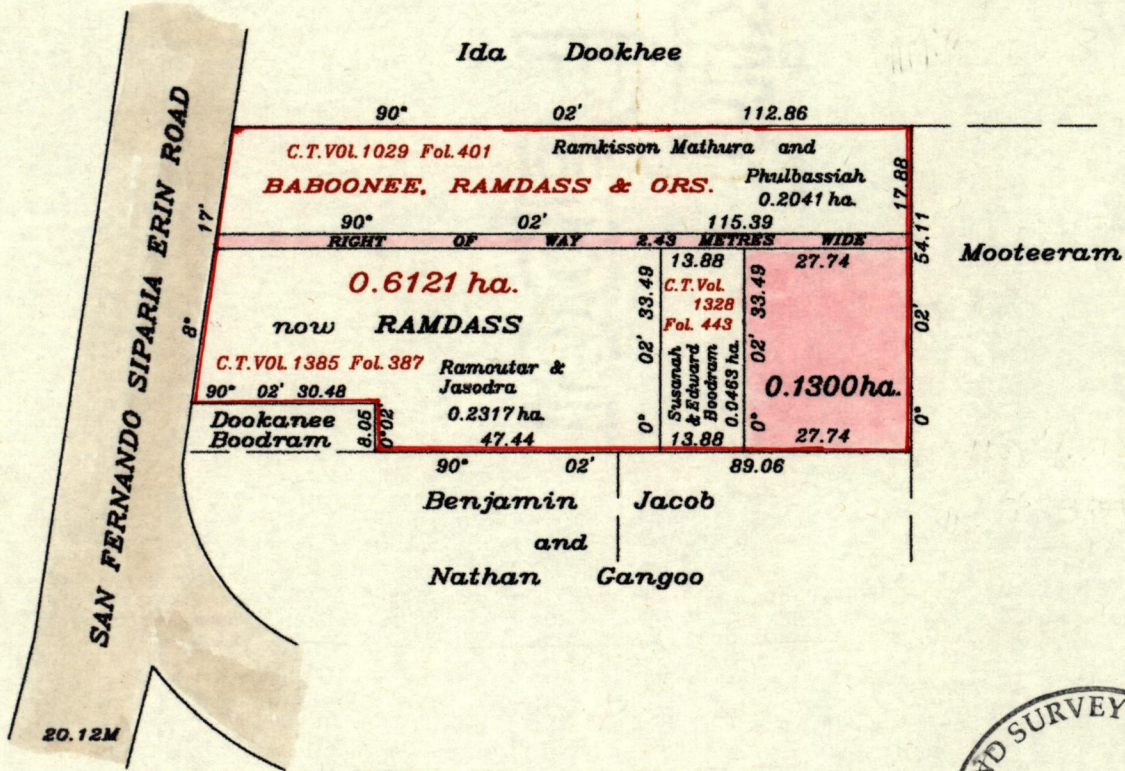

E. 669014  
N. 1124410

Orig Bk 1003.224  
1515:129  
Ramdass

Approved *[Signature]*  
Director of Surveys  
2603.10.03

SCALE 1 : 1250  
Distances are in metres

To obtain compass bearings subtract 2 minutes

This is a true copy of a diagram of Point Six one two one hectare originally transferred to BABOONEE, RAMDASS & ORS. shewing a portion coloured pink and containing Point one three zero zero hectare being the remainder after three previous transfers of other portions of the land

In accordance with Reg. 25(1) of the Land Surveyors' Regulations 1998, I certify that this plan is correct.

Checked by *[Signature]* 17.9.02.  
Entered on *[Signature]*

Trinidad & Tobago  
Land Surveyor

*[Signature]*  
26th March, 2003.

County of St. Patrick  
Town of St. Patrick  
Cadastral Sheet 2181 638  
1A

"H"

R.P.O. Vol. 511 fol. 219  
C.T. Vol. 520 fol. 8

This is the Remaining Portion Plan referred to as marked "H" in the attached MEMORANDUM OF ASSENT made by BALDATH MAHABIR, PRABHUDATH MAHABIR and SURUJDATH MAHABIR.

Handwritten mark resembling a stylized 'G' or '9'.

Handwritten signature of the Attorney-at-Law.

Attorney-at-Law.

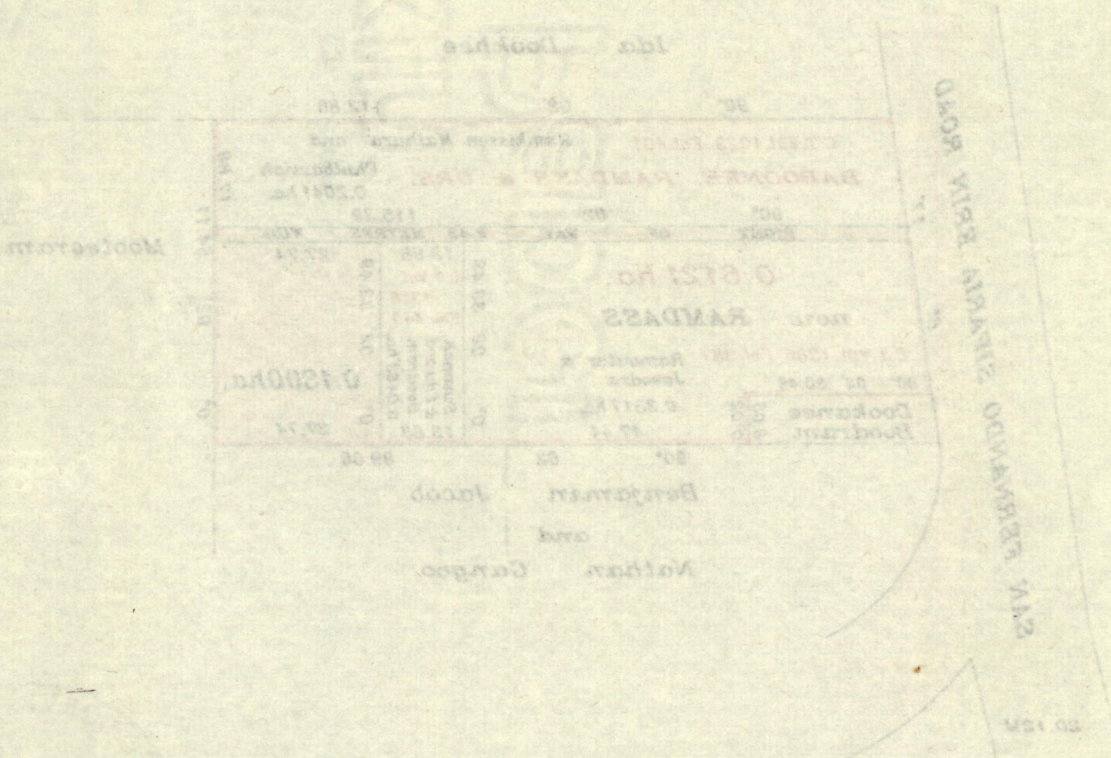

SCALE 1 : 1250  
Distances are in metres

Approved  
Director of Surveys

9 SEP 2003  
Lands and  
Surveys  
Division

Checked by  
Entered on  
Tribhamb & Toppo  
Land Surveyor  
8003