

REMAINING PORTION

R.P.O. Vol.

Fol.

Cadastral Sheet I.17.P 1F  
5/d

C.T. Vol. 2833

Fol. 221

Ward of Tobago

Vol. 5082 Fol. 433

Parish of St. Patrick

VIDE BK.1179 FOL.43  
BK.1132 FOL.24

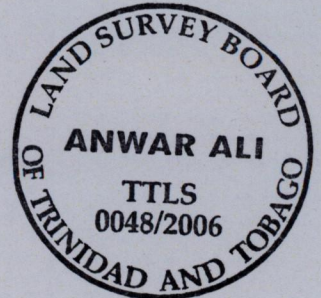
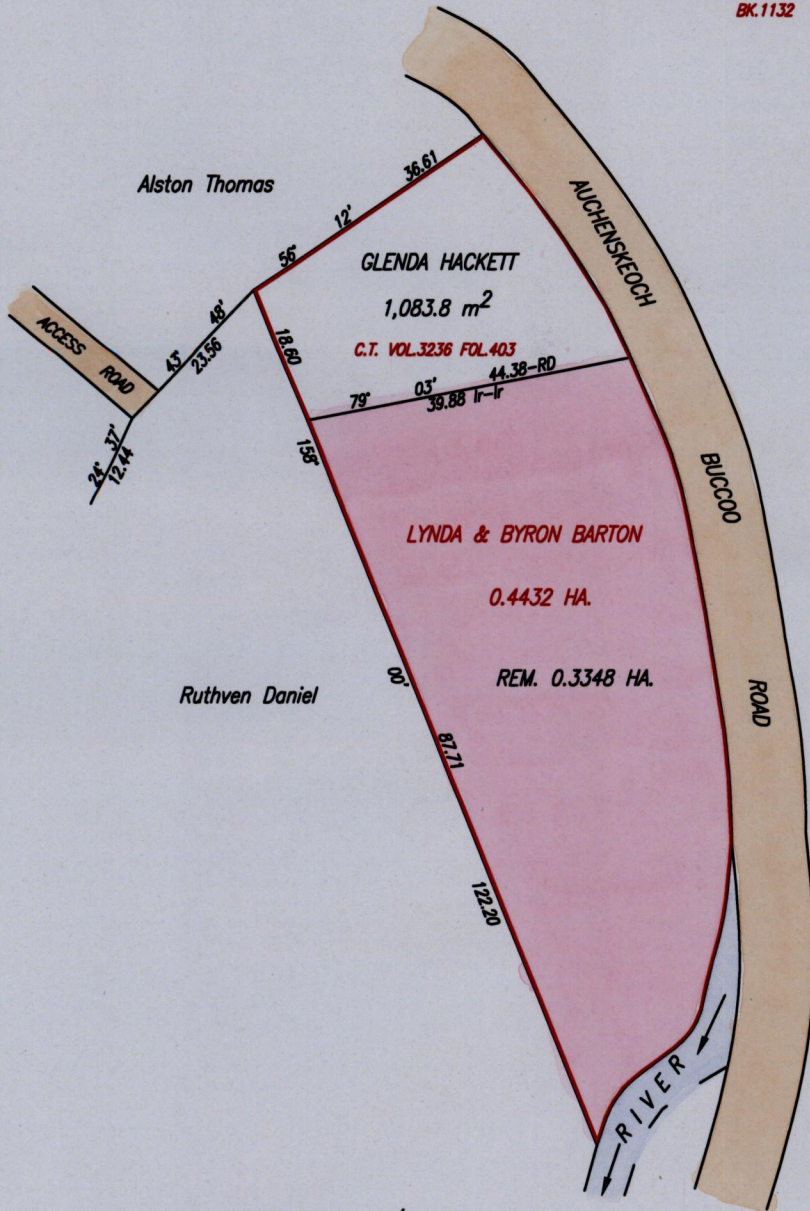

SCALE 1:1000

Distances are in metres

Approved

*[Signature]*  
 Director of Surveys  
 2006/4/21

Bearings are based on Solar Observations

This is a true copy of a diagram of zero point four four three two hectare originally transferred to Lynda and Byron Barton, showing a portion coloured pink and containing zero point three three four eight hectare being the remainder after one previous transfer of another portion of the land.

In accordance with Regulation 25 (1) of the Land Surveyors Regulations 1998, I certify that this plan is correct.

Checked by *m.o.b/04/16*

*[Signature]*

Entered on . . . . .

Trinidad & Tobago Land Surveyor. . . . . 6th April 2006.

PATH=ADA004 E;/TOBAGO/BARTON DWG.

