

Vol. 4618 Fol 175

R.P.O. VOL. 933

C.T. VOL.

Vide S.O. 27/39

Bk.797 Fol.280

Vide Bk.1179 Fol.45

Vide Bk.1103 Fol.195

FOL. 247

FOL.

REMAINING PORTION

Ward of Tabago

Parish of St. Mary

Cadastral Sheet I.19.E.

GOODWOOD

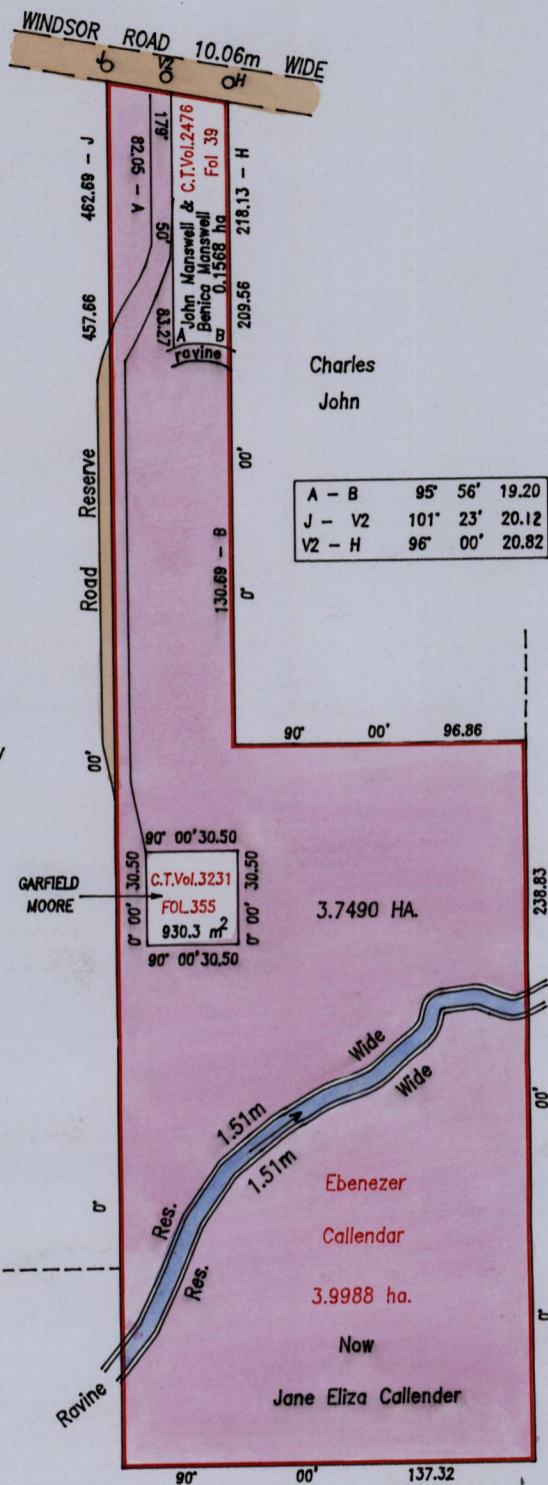

Goodwood Estate then John A. Dick now Viscount Robley

Goodwood Estate now State

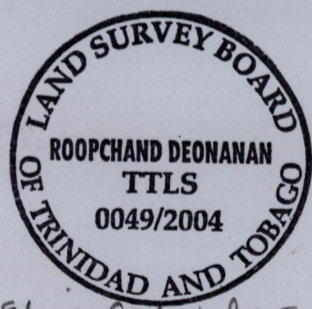

Jane Eliza Callender

Goodwood Estate now State

SCALE 1/2500
Distances are in metres

Approved *[Signature]*
Director of Surveys
2004-6-22

This is a true copy of a diagram of three point nine nine eight eight hectares, originally granted to Ebenezer Callender showing a portion coloured pink containing three point seven four nine zero hectares being the remainder after two previous transfers, of other portions of the land. In accordance with Regulation 25 (1) of The Land Surveyors' Regulations 1998, I certify that this plan is correct.

Checked by *ML 15-6-04*

[Signature]

Entered on Trinidad & Tobago Land Surveyor. 7th April 2004