

R.P.O Vol. Fol.
C.T Vol. 2796 Fol. 279
Vol. 4894 Fol. 329

Cadastral Sheet 1.21.A. ^{1E}/_{5/b/4}
Ward of Tobago
Parish of St. Patrick

U.P.R.N.....
BON ACCORD

Vide Plan EH.97

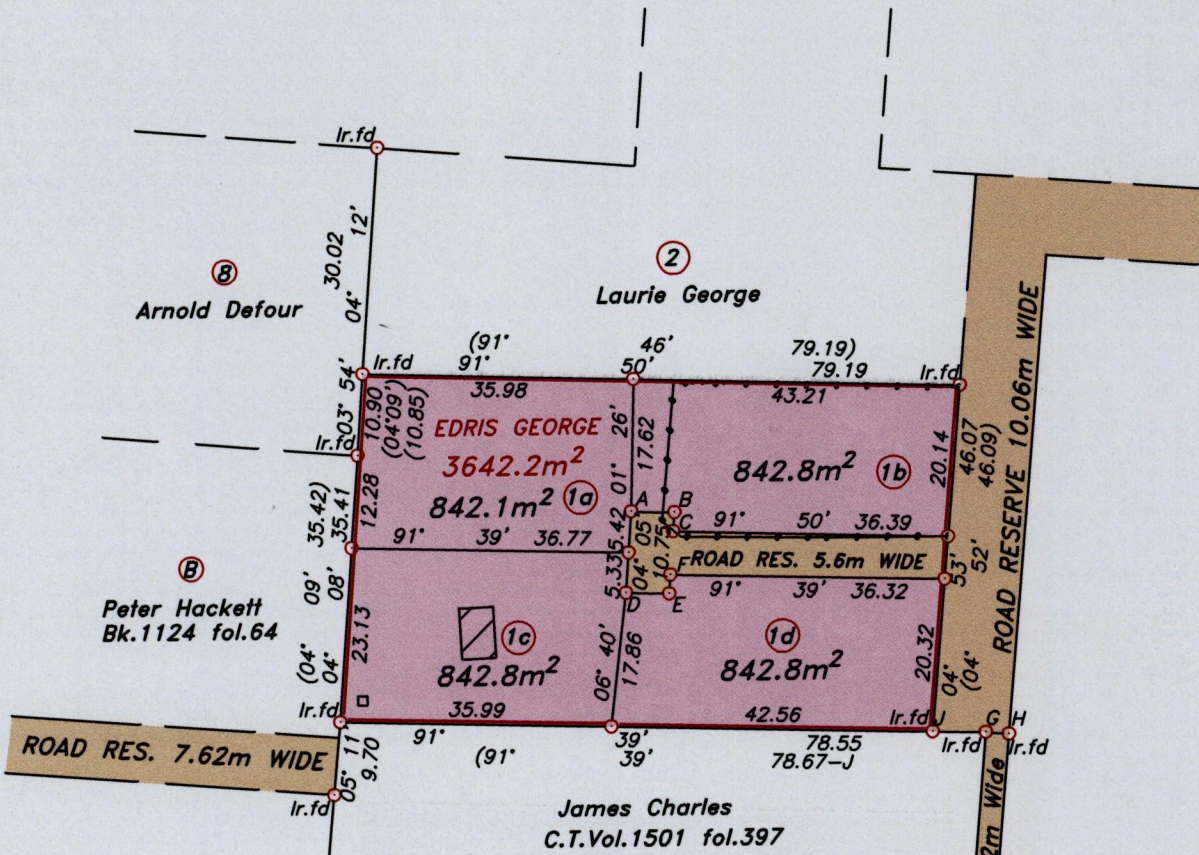

LEGEND

LINE	AZIMUTH	DISTANCE
A-B	91° 50'	5.72
B-C	184° 05'	2.50
D-E	91° 39'	5.73
E-F	04° 05'	2.50
G-H	95° 01'	3.04
J-G	91° 25'	7.02

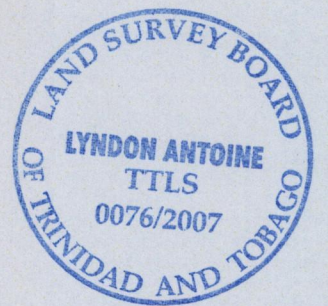
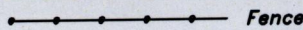

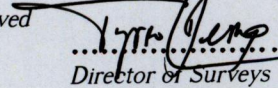
Approved 
Director of Surveys
2007.04.05

○ Denotes iron put, except otherwise stated.

Bearings are grid based on solar observations

Distances are in metres

SCALE 1:1000

PLAN of 4 parcels of land coloured pink in the Ward of Tobago
Containing together three thousand three hundred and seventy point five square metres.
Surveyed by me, with due authority on 22nd September 2005

In accordance with Regulation 25 (1) of the Land Surveyors' Regulations 1998, I certify that this plan is correct.

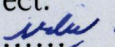
Checked by  3/4/07
Entered.....

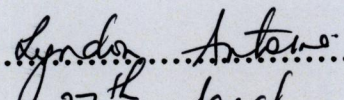
27th March

Trinidad & Tobago Land Surveyor.....2007.