

R.P.O. Vol. 239 Fol. 429

REMAINING PORTION

Cadastral Sheet I.21.B. & C, F&G

C.T. Vol. 3942 Fol. 277

Ward of Tobago

Parish of St. Patrick.

Vol. 4823 Fol. 7

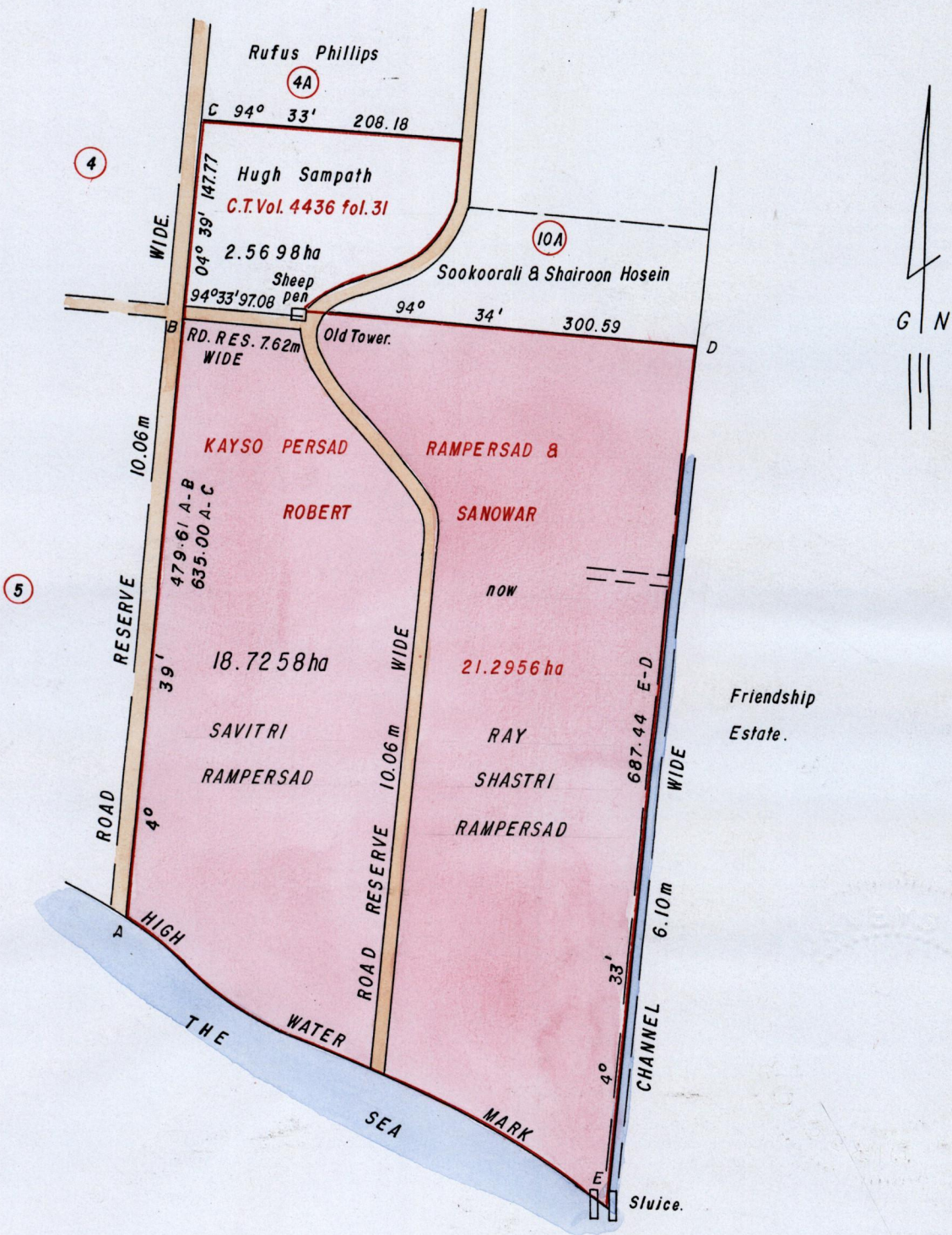

SAVITRI & RAY SHASTRI RAMPERSAD.

SCALE 1:5000  
Distances are in Metres

Approved *[Signature]*  
Director of Surveys  
2004.2.11

This is a true copy of a diagram of twenty one point two nine five six hectares originally transferred to KAYSO PERSAD RAMPERSAD AND ROBERT SANOWAR, showing a portion coloured pink and containing eighteen point seven two five eight hectares. after one previous transfer of another portion of land. In accordance with Regulation 25(1) of the Land Surveyors' Regulations 1998, I certify that this plan is correct.

Checked by *[Signature]* 3M 14/01/04.  
Entered on . . . . . Trinidad & Tobago Land Surveyor *[Signature]* 12<sup>th</sup> August 2003

