

1300

36

R.P.O. Vol Fol

C.T. Vol 2090 Fol 271

Vd. 4607 Ad. 505

Cadastral Sheet I.17.K. $\frac{2G}{3/d/1}$

Ward of Tobago

Parish of St. Andrew

Remaining Portion

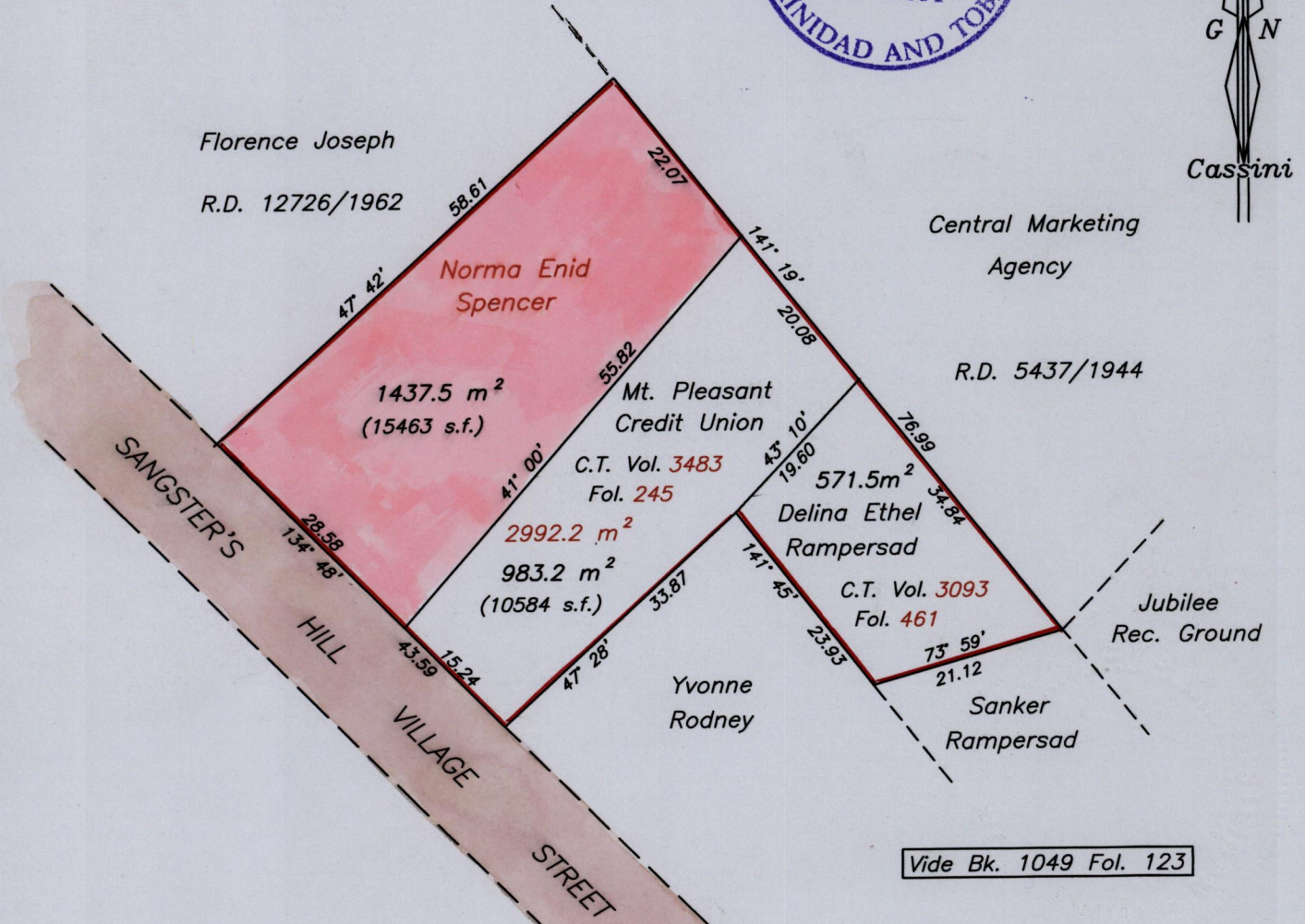
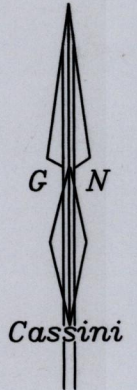
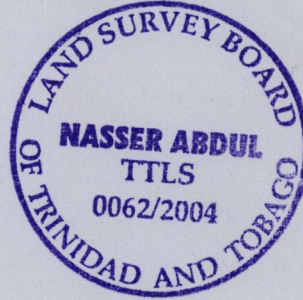

Approved *[Signature]*
Director of Surveys
2004-6-25

Vide Bk. 1049 Fol. 123

SCALE 1/750
Distances are in metres

Neville Anthony Parker & Aethnae Frances Parker

Bearings are Cassini Grid based on Solar Observations

This is a true copy of a diagram of two nine nine two point two square metres originally transferred to Norma Enid Spencer showing a portion coloured pink and containing one four three seven point five square metres being the remainder after (2) two previous transfers of another portion of the land. In accordance with Regulation 25 (1) of the Land Surveyors' Regulations 1998, I certify that this plan is correct.

Checked by *[Signature]* 15-6-04

Entered on.....

[Signature]
Trinidad & Tobago Land Surveyor.....2004