

Cadastral Sheet I.19.E. 2J  
1/d/4  
Ward of Tobago  
Parish of St. Mary

Vide S.O. 27/39  
Bk. 797 Fol. 280  
Vide Bk. 1179 Fol. 45  
Vide Bk. 1103 Fol. 195

INSET

R.P.O. Vol. 933 Fol. 247  
C.T. Vol. 4708 Fol. 241

Coordinates of T2 (Ir.f.d): 0757323mE, 1239244mN  
U.T.M. 20 Napanima (+/- 5.00m)  
G.P.S. Direct Observation

LEGEND

A1 - a	249' 31'	44.32
a - b	264' 47'	85.59
b - LP#22G	132' 24'	21.33
b - e	335' 01'	31.14
e - T2	172' 42'	22.68
H2 - T2	181' 02'	44.40

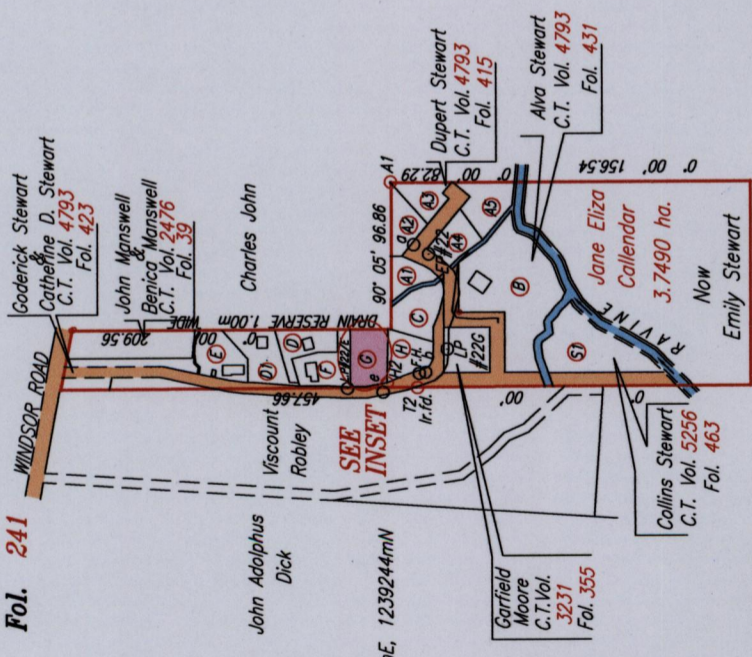

SCALE 1:5000  
Distances are in METRES

Approved . . . . .  
Director of Surveys

○ Denotes iron put except where otherwise stated

Bearings are Cassini Grid based on Solar Observations

PLAN of a Parcel of land coloured pink in the Ward of Tobago

Containing nine hundred and thirty-three point eight square metres

Surveyed by me, with due authority, in June 2013

Certified Correct in accordance with Regulation 25 (1) of The Land Surveyors Regulations 1998,

Checked by . . . . .

Entered on . . . . .

Trinidad & Tobago Land Surveyor  
C:\LESS 2013\TOBAGO\STEWART, DUPERT. LOT #6.933.3sqm.dwg . . . . . 2014  
FILE NC:TS054

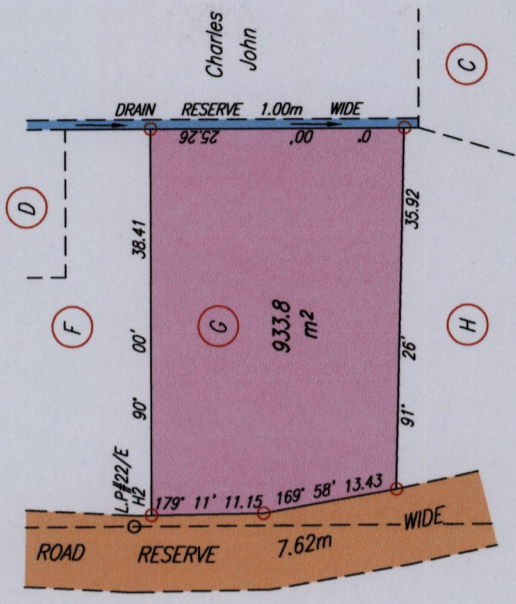
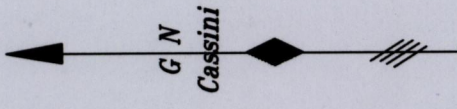

SCALE 1:750

Distances are in METRES

LEGEND

From	To	Bearing	Distance
H2	LP#22/E	326° 37'	2.01

