

To be brought under the provisions of the Real Property Ordinance

Cadastral Sheet L19.E
Ward of Tobago
Parish of St. Mary

GOODWOOD

Coordinates of J1 (r. Pt.) 758048mE, 12338967mN
U.T.M. 20 WGS 84 (+/- 5.00m)
G.P.S. Direct Observation

Approved
Michael Murray
Director of Surveys

Denotes Iron put except where otherwise stated
Bearings are Cassini Grid based on Solar Observations

PLAN of 2 Parcels of land coloured pink in the Ward of Tobago

Containing two hundred and twenty two point nine square metres at (M1)
and four hundred and thirty one point zero square metres at (M2)

Surveyed by me, with due authority, in 5th April 2009 & 2nd July 2009 for Michael Murray
Certified Correct in accordance with Regulation 25 (1) of The Land Surveyors Regulations 1998,

Checked by TTLS

Entered on

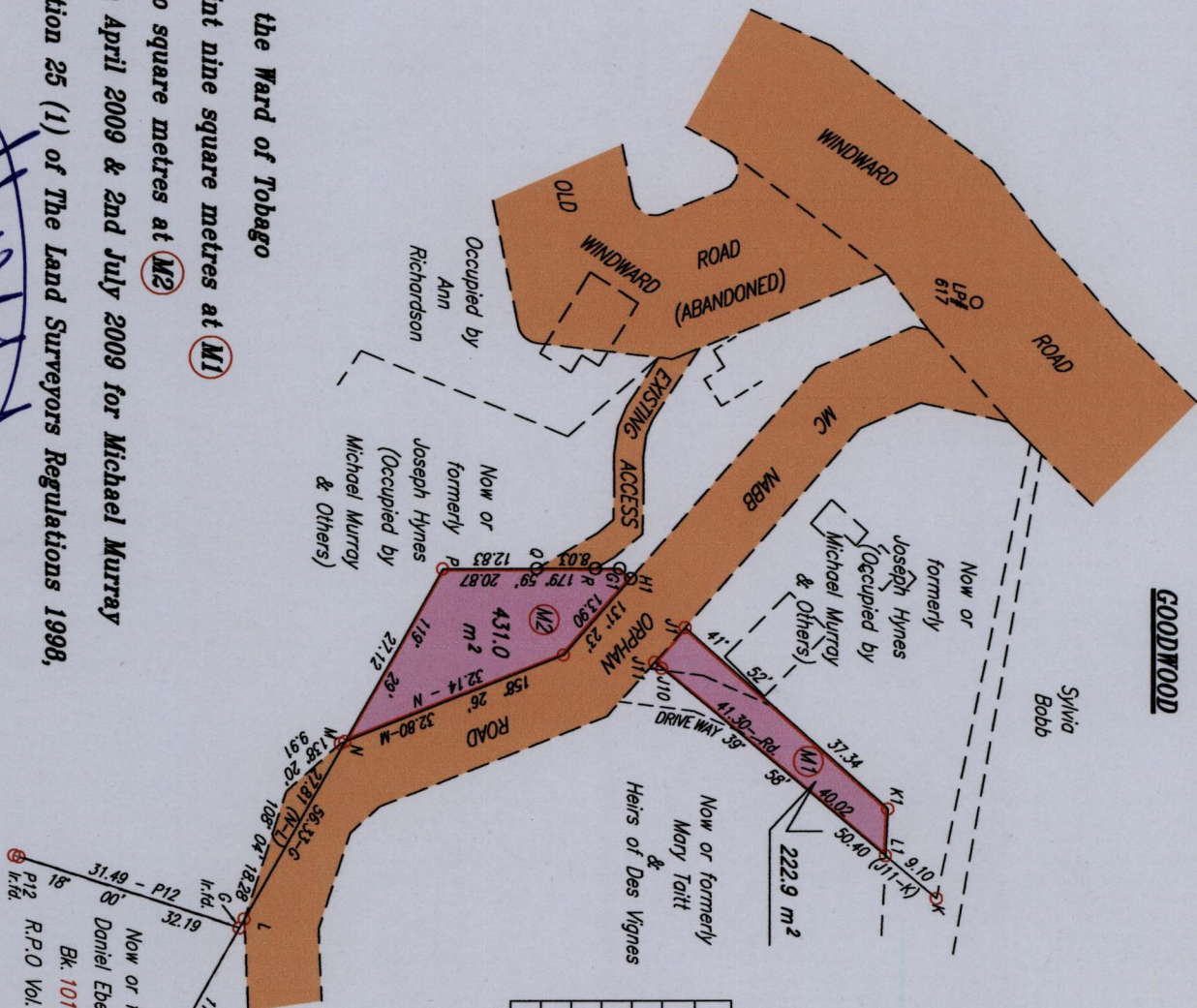

From	To	Bearing	Distance
R - G1	G1 - H1	359° 59'	3.33
G1 - H1	H1 - J1	41° 52'	2.05
H1 - J1	J1 - J11	41° 52'	10.06
J1 - J11	J11 - L1	131° 23'	6.33
L1 - L11	L11 - L111	92° 59'	6.36
L111 - L1111	L1111 - L11111	321° 28'	60.44

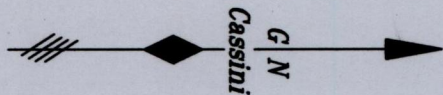

SCALE 1:1000
Distances are in METRES

Now or formerly
Daniel Ebenezer Thomas
Bk. 1010 Fol. 149
R.P.O. Vol. 708 Fol. 217



13000

1300/162

162