

1300 156

R.P.O. Vol.

Fol.

Cadastral Sheet I.21.A. 1E
5/b/3

C.T. Vol. 1444

Fol. 287

Ward of Tobago

Parish of St. Patrick

Note :

Lots 8, 9A, 10 & 7A to be Amalgamated
Lots 7B, & 9B to be Amalgamated

Vide : Plan P.A. 223
Plan D.K. 15
Bk.1179 Fol.13
Bk.926 Fol.2

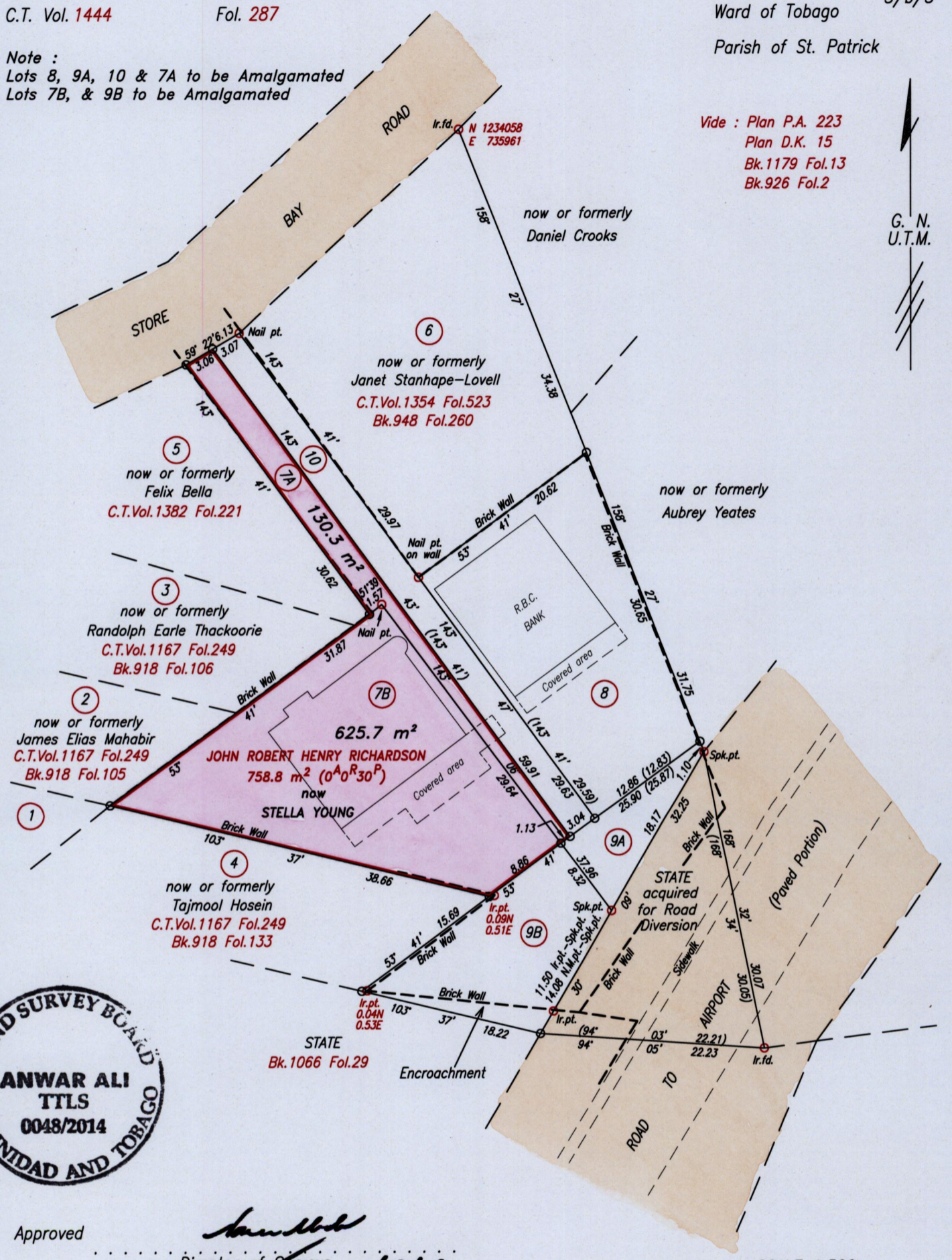
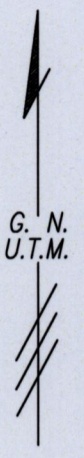

Approved

[Signature]
Director of Surveys

SCALE 1:500
Distances are in metres

o Denotes No mark put except where otherwise stated
Co-ordinates are Naparima/UTM, derived using handheld GPS (+/-5m)
Bearings are U.T.M. grid based on Solar Observations
PLAN of 2 Parcels of land coloured pink in the Ward of Tobago
Containing together seven hundred and fifty six square metres
Surveyed by me, with due authority, on March 15th 2014
Certified Correct in accordance with Regulation 25 (1) of the Land Surveyors Regulations 1998

Checked by. NW 12.08.2014

[Signature]

Entered on. Trinidad & Tobago Land Surveyor. 29th May 2014.
FILE PATH = ADA002 D:\TOBAGO\CHRISTINE YHAP-FINAL.DWG.