

1300/131

13000

131

To be brought under the provisions of the Real Property Ordinance

CHARLOTTEVILLE

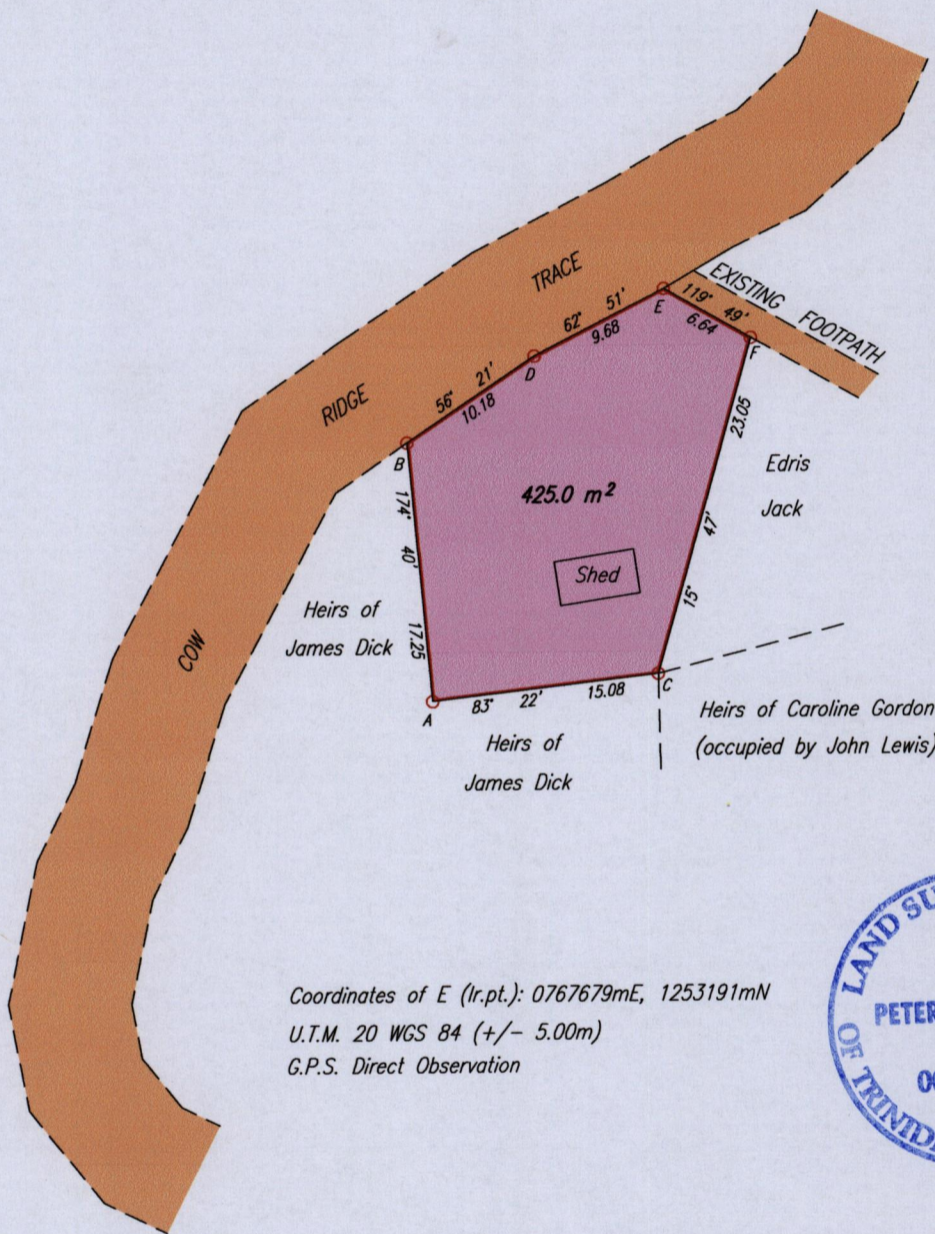

Coordinates of E (lr.pt.): 0767679mE, 1253191mN
U.T.M. 20 WGS 84 (+/- 5.00m)
G.P.S. Direct Observation

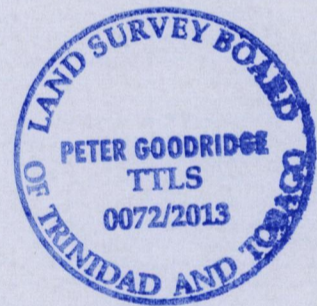

Approved by *[Signature]*
Director of Surveys *[Signature]*

SCALE 1:500

Distances are in METRES

- Denotes Iron put except where otherwise stated
- Bearings are Cassini Grid based on Solar Observations

PLAN of a Parcel of land coloured pink in the Ward of Tobago

Containing four hundred and twenty five point zero square metres

Surveyed by me, with due authority, on 24th October 2012 and 7th November 2012 for

Veronica Smith and Eston Smith

Certified Correct in accordance with Regulation 25 (1) of The Land Surveyors' Regulations 1998,

Checked by

[Signature] TTLS

Entered on

Trinidad & Tobago Land Surveyor

C:\LESS 2012\TOBAGO\SMITH,ESTON,BELLE AIR ST.CHARLOTTEVILLE.dwg.

4th April 2013

FILE NO: TS099