

13000

REMAINING PORTION PLAN

Cadastral Sheet I.16.H. 1C
3/d

110

C.T. Vol. 4034

Fol. 513

Ward of Tobago

Parish of St. Patrick

Vol. 5490

Fol. 15

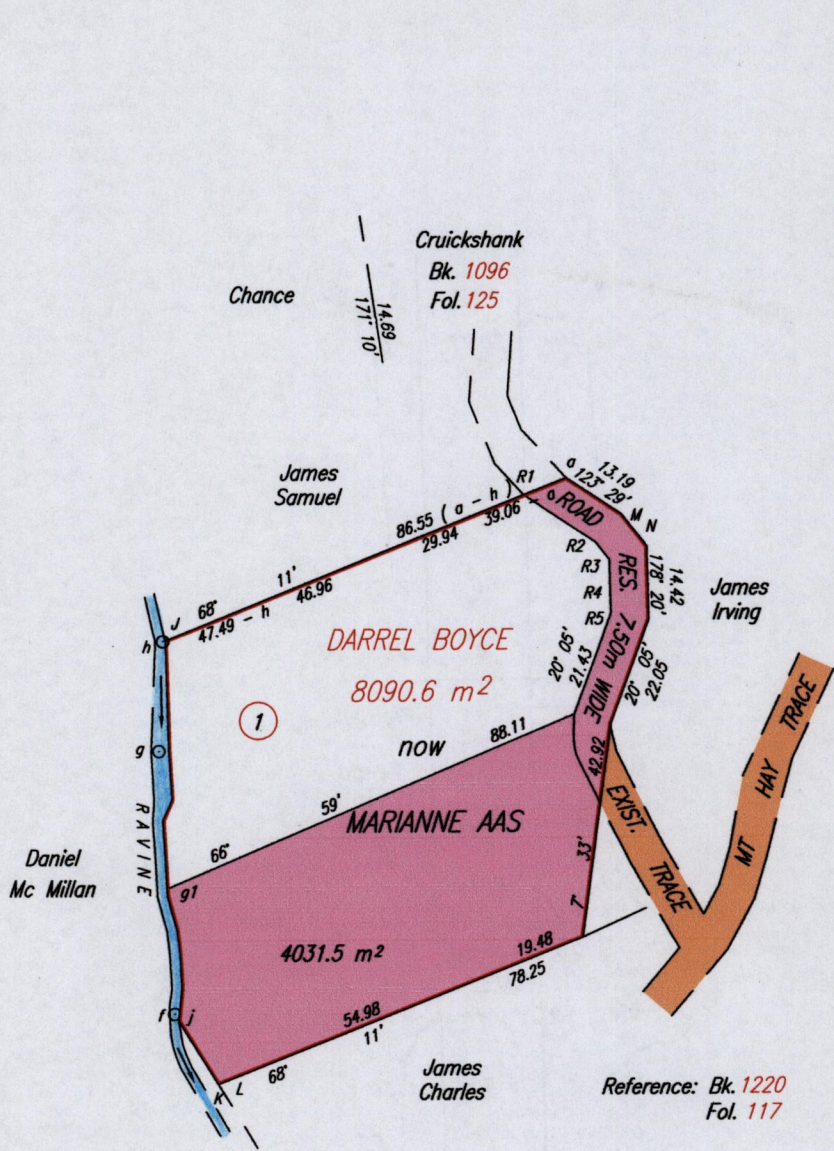

LEGEND

K - L	68° 11'	3.79
K - j	328° 26'	15.04
j - f	328° 26'	1.50
f - a	356° 43'	52.30
a - h	2° 07'	21.93
q1 - a	356° 43'	27.40
M - N	142° 03'	8.10
a - R1	248° 11'	9.12
R1 - R2	123° 29'	17.16
R2 - R3	142° 03'	4.42
R3 - R4	178° 20'	7.20
R4 - R5	178° 20'	3.32

Reference: Bk. 1220
Fol. 117

Lot#	C.T.	Vol.	Area	Name
1	4523	57	4059.1 m ²	Susanne Pleines

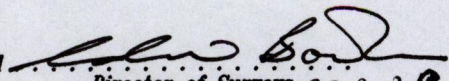

Approved 
Director of Surveys 2012.2.9

SCALE 1:1500
Distances are in METRES

This is a true copy of a diagram of eight thousand and ninety point six square metres originally transferred to Darrel Boyce showing a portion coloured pink and containing four thousand and thirty one point five square metres being the remainder after one previous transfer of another portion of the land In accordance with Regulation 25 (1) of The Land Surveyors' Regulations 1998, I certify that this plan is correct.

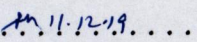
Checked by  11.12.19
Entered on

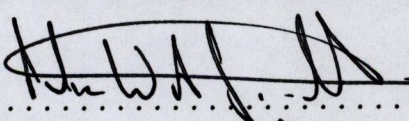
 TTLS
15th December 2011
Trinidad & Tobago Land Surveyor
C:\LESS 2011\TOBAGO\AAS,MARIANNE-BLACK ROCK REM POR.dwg. FILE NO:TA017

110

1300

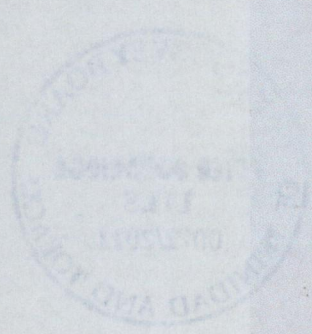
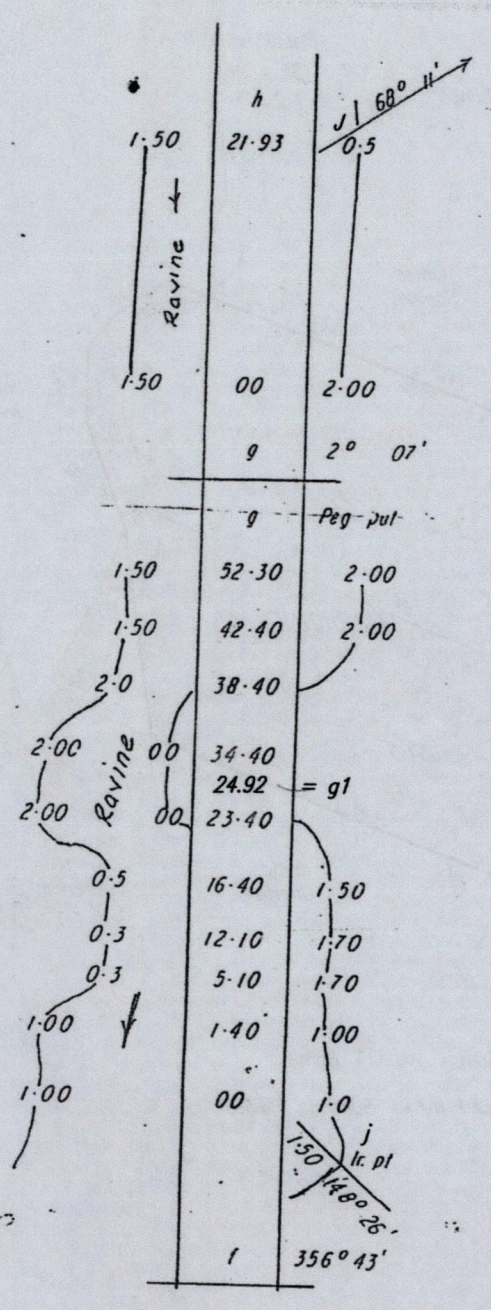

[Handwritten signature]

1395/132
Now 1300/110