

U.P.R.N.....
 R.P.O Vol. Fol.
 C.T Vol. 2920 Fol. 441
 Vol. 5161 Fol. 361
 Vide plan FJ 79

Cadastral Sheet I.21.D 1J
 2/b
 Ward of Tobago
 Parish of St. Andrew
 LOWLANDS

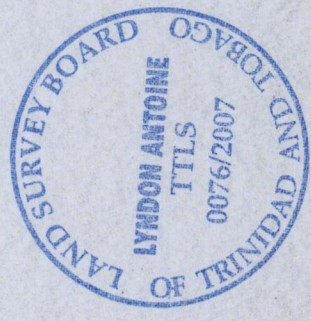
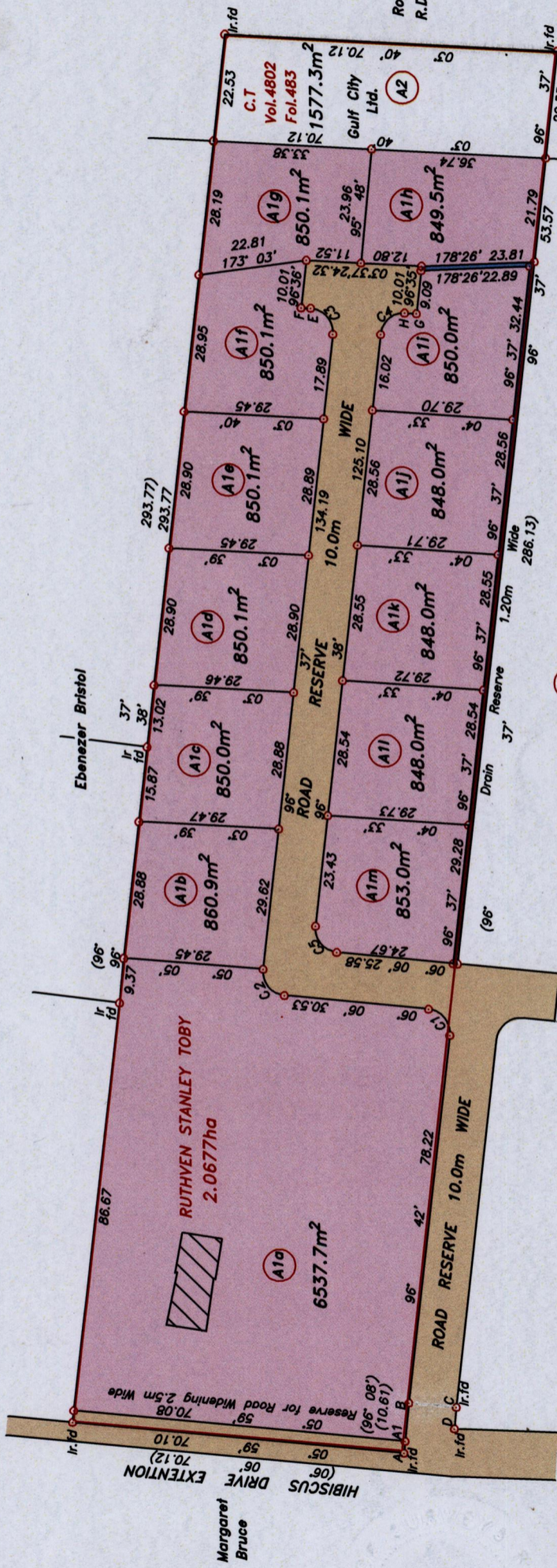

LINE	DIRECTION	DISTANCE
A-B	96° 01'	10.61
B-C	186° 01'	10.06
C-D	275° 22'	4.58
E-F	03° 28'	2.00
G-H	03° 38'	2.51
A-A1	96° 01'	2.50

CURVE	DELTA ANGLE	CHORD DIRECTION	RADIUS	CHORD LENGTH
C1	45° 15'	51° 21'	9.23	7.10
C2	45° 15'	51° 21'	9.23	7.10
C3	46° 22'	50° 08'	9.19	7.24
C4	47° 19'	138° 35'	8.41	6.75
C5	90° 32'	51° 22'	5.00	7.10

SCALE 1:1250
 Distances are in metres

Approved: *Lynda Camp*
 Director of Surveys 2007.12.18
 Denotes iron putt, except otherwise stated.
 Bearings are grid based on solar observations

PLAN of 13 parcels of land coloured pink in the Ward of Tobago
 Containing together one point six seven four six hectares.
 Surveyed by me, with due authority on 20th September 2005 & 3rd July 2006
 In accordance with Regulation 25 (1) of the Land Surveyors' Regulations 1998, I certify that this plan is correct,
 Checked by *Lynda* 11/12/07
 Entered.....

Trinidad & Tobago Land Surveyor..... August 2007.
 path: \\casli-server\06SURVEY\7088\T08B\F08B\F08B.DWG

11/11/07

1300

1005

Cassini
 G N

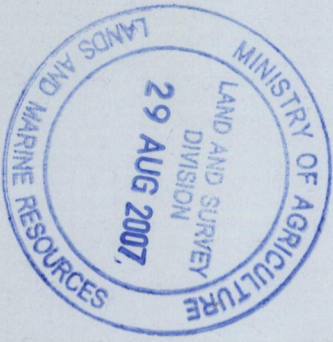

No.	CT VOL & Fol	NAMES
A1a		
A1b	CT. VOL. 5268 FOL. 33	IRNE DOLORES GONZALES
A1c	CT. VOL. 5268 FOL 33	IRNE DOLORES GONZALES
A1d		
A1e		
A1f		
A1g		
A1h		
A1i	5188 Fol 115	Sean Leonard.
A1j		
A1k	5188 Fol 125	Colin & Charlene Taylor Basso.
A1l		
A1m	5188 Fol 135	LAWRISTON LEWIS ASSOCIATES LTA

