

1292

67

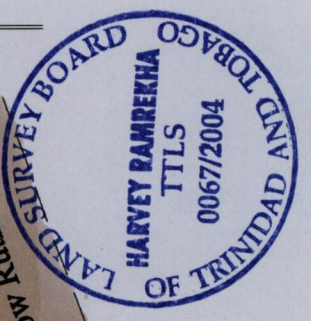
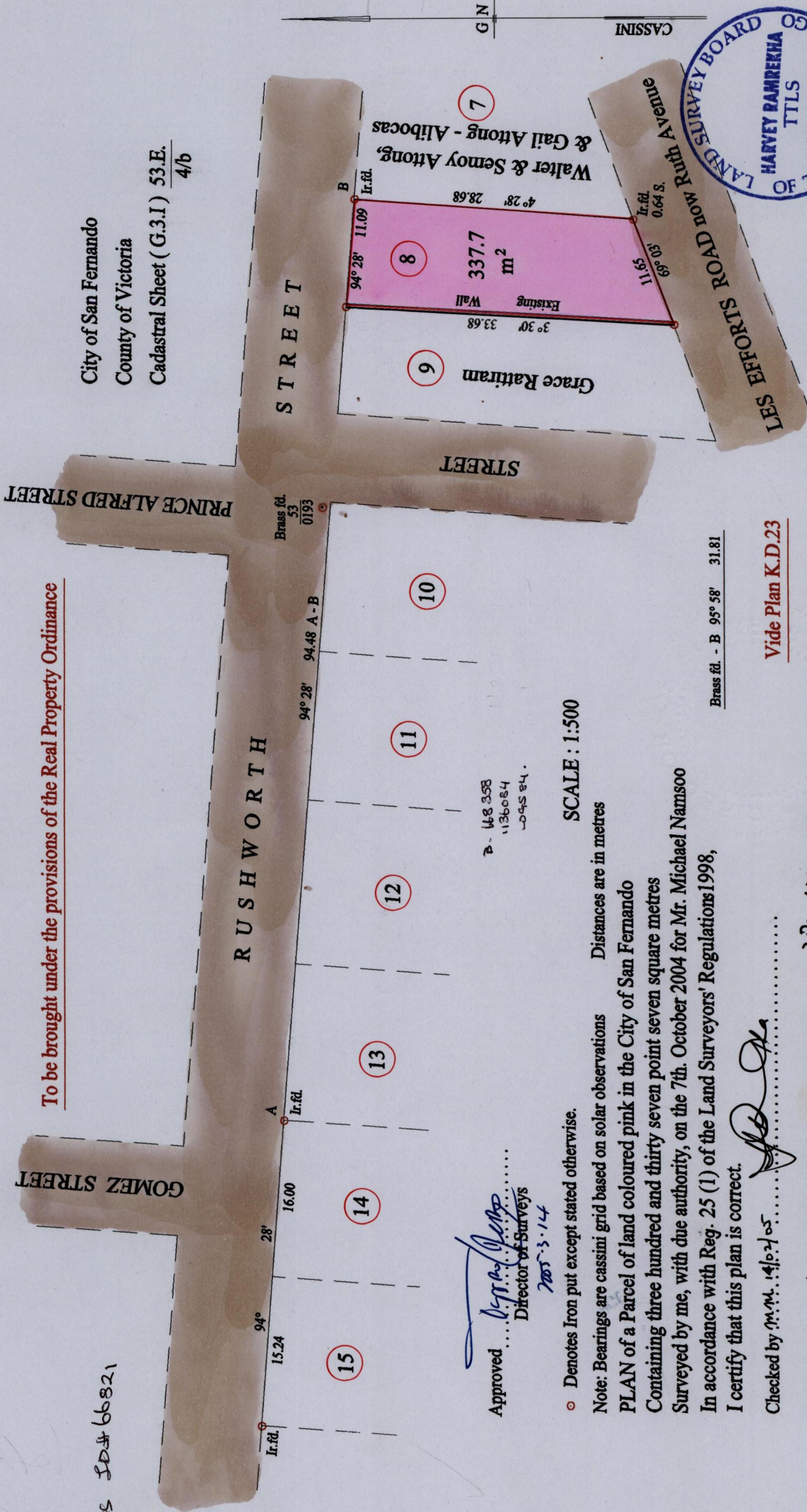

To be brought under the provisions of the Real Property Ordinance

City of San Fernando
County of Victoria
Cadastral Sheet (G.3.I) 53.E.
4/b

Brass 50# 66821

RUSHWORTH

Brass fld. 53 0193

Ir. fld. A

16.00

15.24

Ir. fld.

94° 28' 94.48 A-B

94° 28' 94.48 A-B

94° 28' 94.48 A-B

94° 28' 94.48 A-B

Approved *[Signature]*
Director of Surveys
2005-3-14

P. 48 358
1136084
1045 84.

○ Denotes Iron put except stated otherwise.

SCALE : 1:500

Note: Bearings are cassini grid based on solar observations Distances are in metres

PLAN of a Parcel of land coloured pink in the City of San Fernando
Containing three hundred and thirty seven point seven square metres
Surveyed by me, with due authority, on the 7th. October 2004 for Mr. Michael Namsoo
In accordance with Reg. 25 (1) of the Land Surveyors' Regulations 1998,
I certify that this plan is correct.

Brass fld. - B 95° 58' 31.81

Vide Plan K.D.23

Checked by M.M. 14/02/05 *[Signature]*

Entered on 045-11-06-2005 Trinidad & Tobago Land Surveyor *[Signature]* 27/10/2004