

Not Located

1202

12949

4

Process # 66718

To be brought under the Provisions of the
Real Property Ordinance

Vide Bk. 639 fol.183
Vide Bk. 969 fol. 50

Ward of Siparia

County of St.Patrick

Cadastral Sheet G.12.A. 63D
2/a

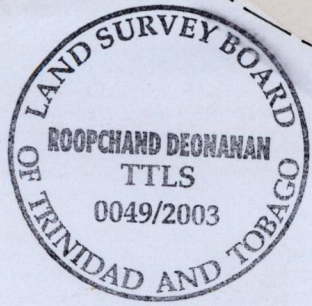
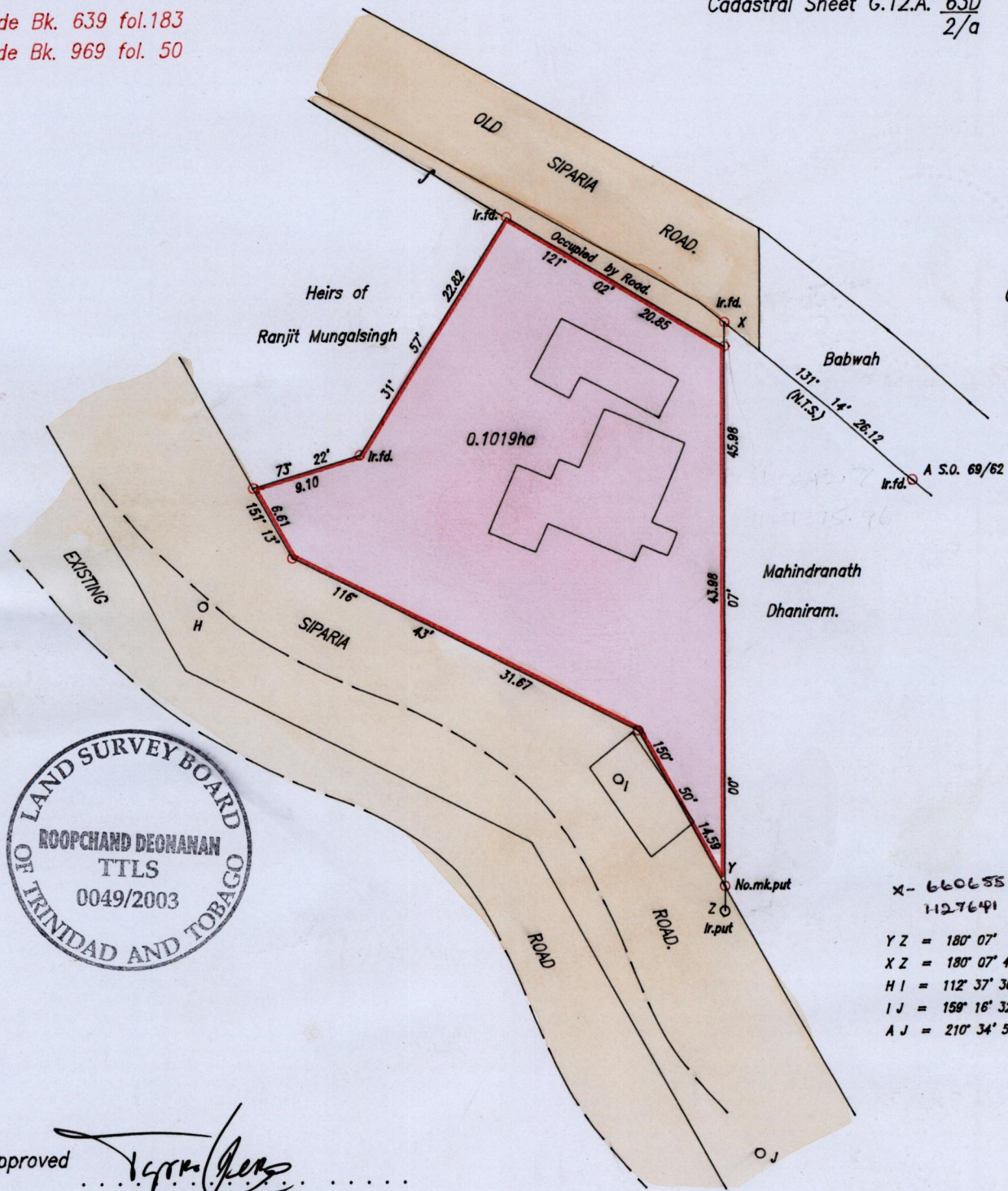

X- 660655
11276491

YZ = 180° 07' 2.00
XZ = 180° 07' 47.98
HI = 112° 37' 36.61
IJ = 159° 16' 32.79
AJ = 210° 34' 50.22

Approved *[Signature]*
Director of Surveys
2004.9.2

SCALE 1:500
Distances are in Metres

○ Denotes Iron put except otherwise stated.
Bearings are based on Solar Observations

PLAN of a Parcel of land coloured pink in the Ward of Siparia
Containing zero point one zero one nine hectare.
Surveyed by me, with due authority, on 26th September & 3rd October, 2002 for Sumatee Ramsoondarsingh.
In accordance with Regulation 25(1) of the Land Surveyors' Regulations 1998,
I certify that this plan is correct.

Checked by *[Signature]* *[Signature]*

Entered on *[Signature]* - Trinidad & Tobago Land Surveyor . . . 19 . . . December . . . 2003

PATH = E:\700 C:\Drawings\s.ramslgh.dwg.