

Process ID# 67229

To be brought under the Provisions of the
Real Property Ordinance.

Vide Bk. 1105 fol. 21
" " 1248 " 78

Cadastral Sheet G.4.O. 54D
Ward of Savana Grande.
County of Victoria

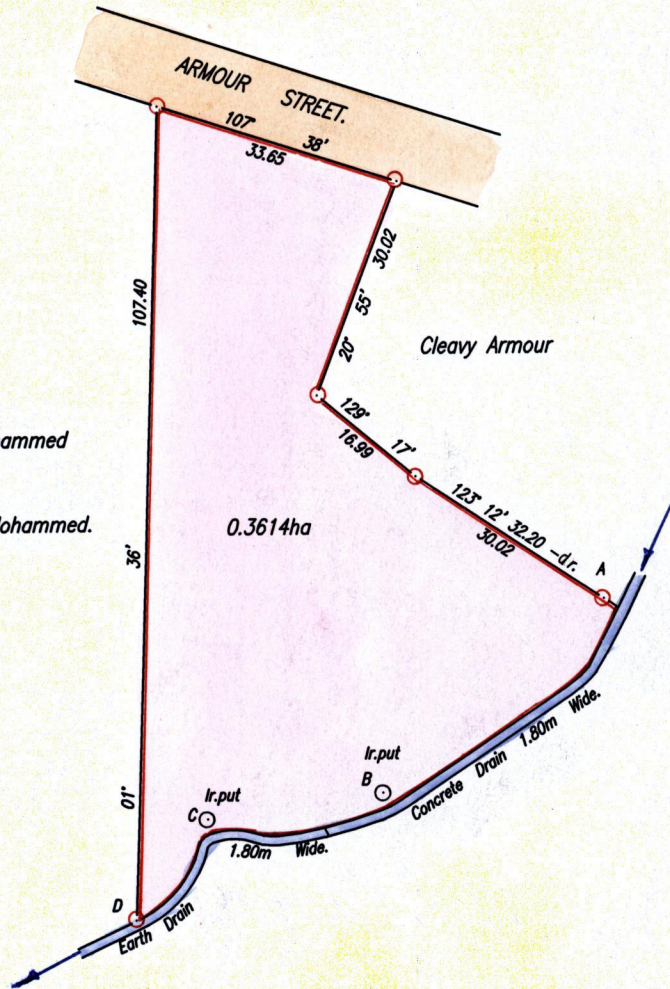

John Mohammed
&
Normer Mohammed.

0.3614ha

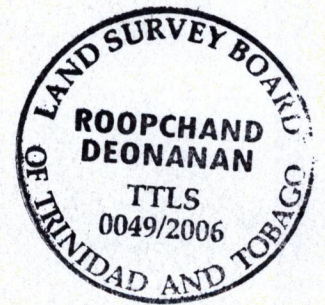

D- 678283
1135266
W9584

Approved *[Signature]*
Director of Surveys
2006.11.03

SCALE 1:1000
Distances are in Metres

○ Denotes Iron found except otherwise stated.

Bearings are Cassini Grid based on Solar Observations.

PLAN of a Parcel of land coloured pink in the Ward of Savana Grande.
Containing zero point three six one four hectare.

Surveyed by me, with due authority, on 12th. December, 2005 for Cleavy Armour.
In accordance with Regulation 25(1) of the Land Surveyors' Regulations 1998,
I certify that this plan is correct.

Checked by *[Signature]* 20/1/06

Entered *[Signature]* 17 February 2006
Trinidad & Tobago Land Surveyor
PATH = EV700 D:\Drawings06\C.Armour.dwg.

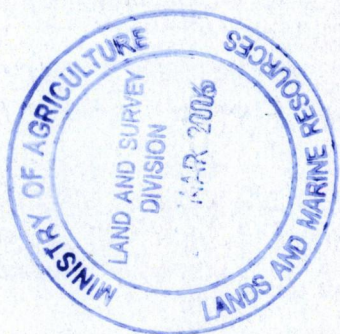
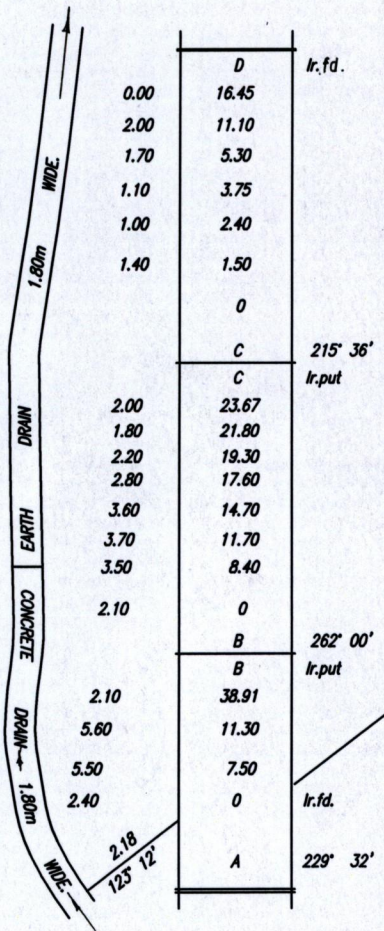

1292/213