

To be brought under the provisions of the Real Property Ordinance.

Ward of Savana Grande
County of Victoria
Cadastral Sheet G. 4. O., 54D
4/02

Process: JD# 67264

Vide: Bk. 1205 / 17
Bk. 1176 / 149
Bk. 1049 / 175

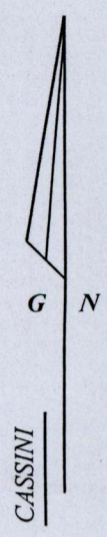
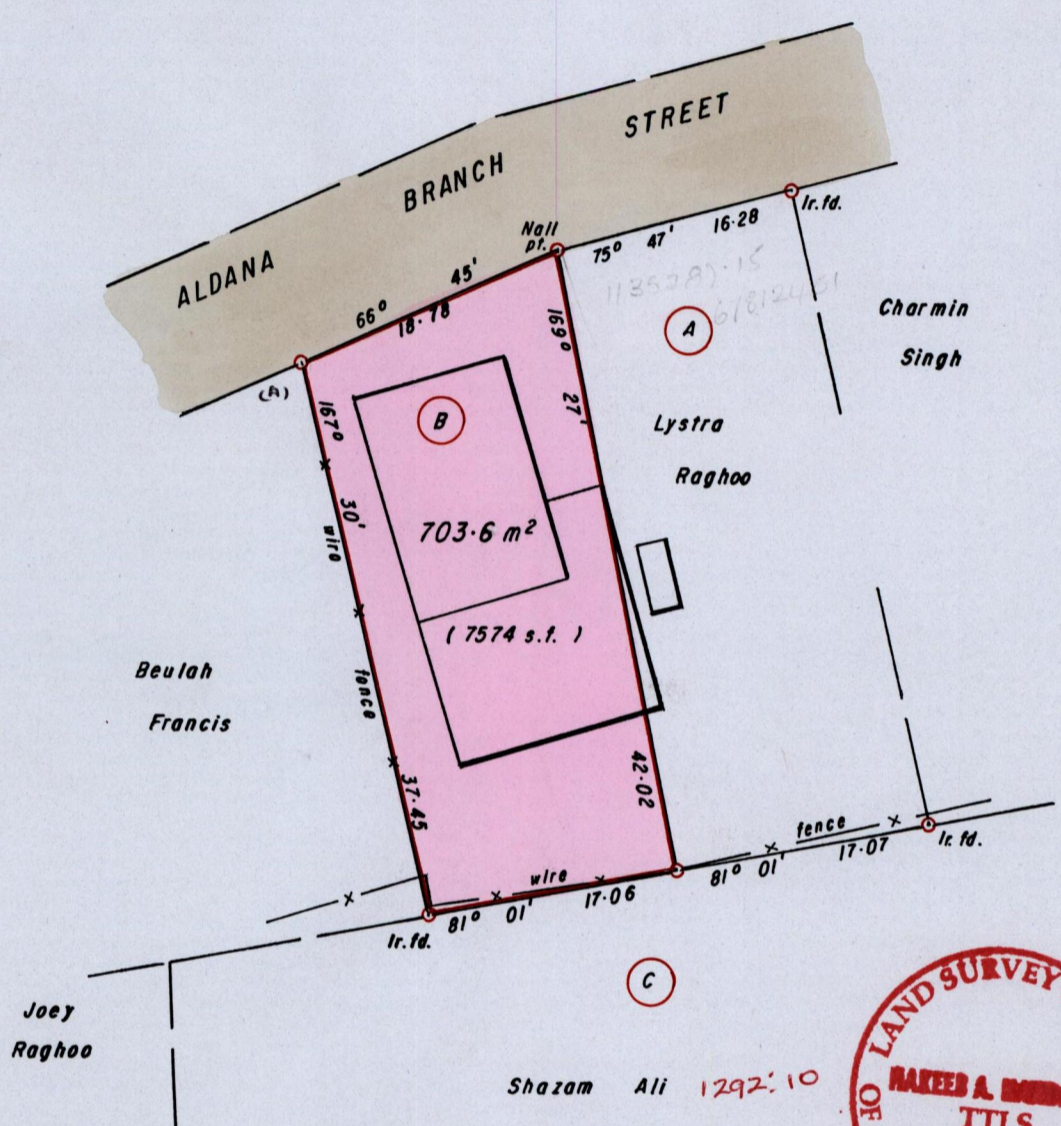

(A) - 678114
1136507
WGS 84

Shazam Ali 1292.10

SEE 1292:20.

Approved [Signature]
Director of Surveys
2004.10.15

○ Denotes Iron put unless otherwise stated
Bearings are Cassini Grid based on Solar Obs.
SCALE 1 / 500
Distances are in METRES

Note: To Obtain compass bearings add/subtract minutes

PLAN of a Parcel of land coloured PINK in the Ward of Savana Grande
Containing seven hundred and three point six square metres
Surveyed by me, with due authority, on the 14th. July 2004 for Lystra Raghoo
In accordance with Regulation 25 (1) of the Land Surveyors' Regulations 1998,
I certify that this plan is correct.

Checked by mm. 06/09/04

Hakes Nardella

Entered CMS 14.06.2013

Trinidad and Tobago Land Surveyor 06 August 2004