

1292

187

To be brought under the provisions of the Real Property Ordinance

Ward of St. Anns

County of St. George

Process ~~1292~~ L7409

Cadastral Sheet B.17.F., 13F
3/a



"BOURG MULATRESSE"

Bk. 513 : 266
Bk. 1046 : 127

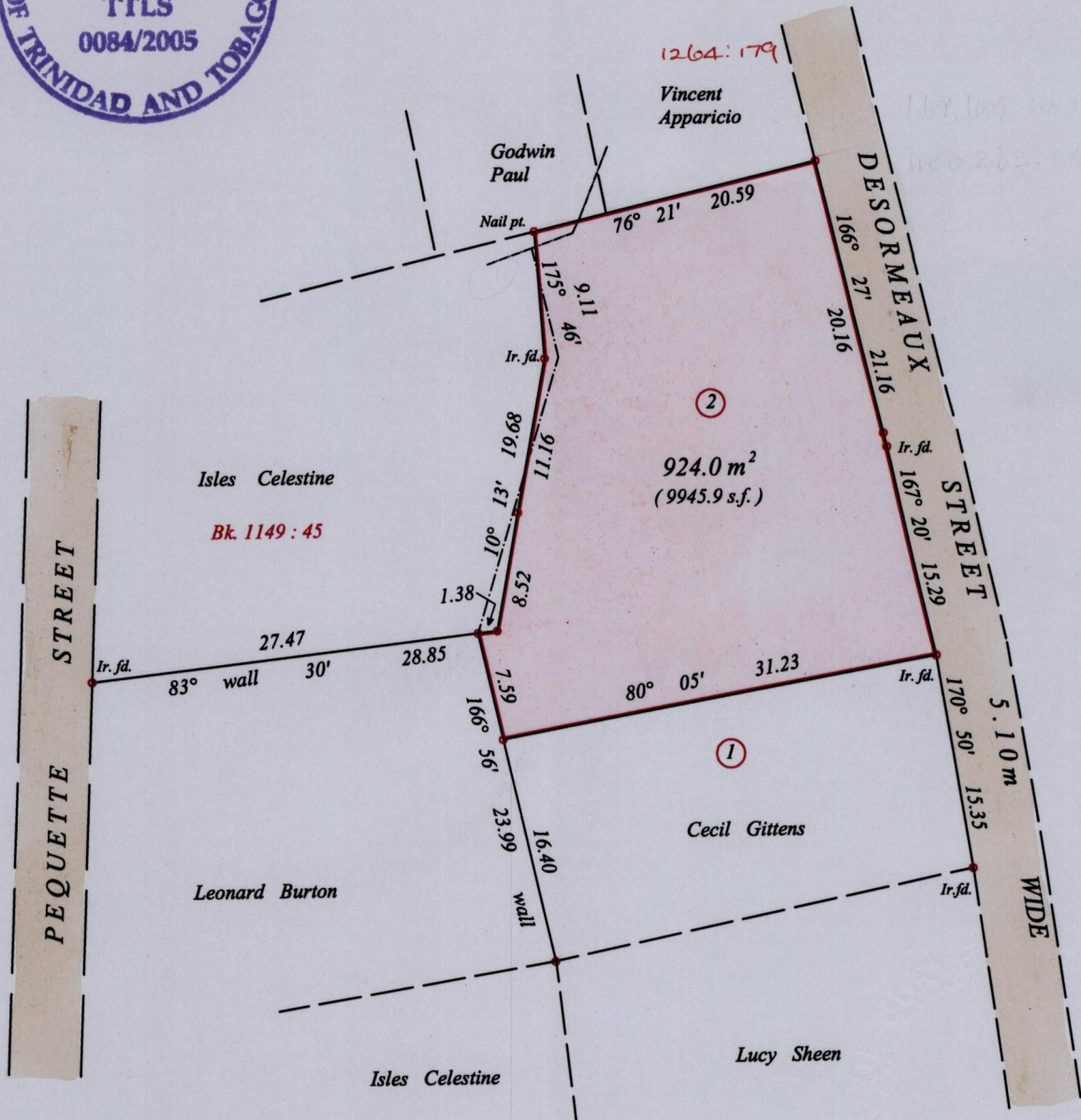

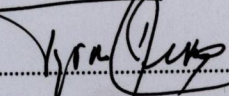
Approved 
Director of Surveys
2006.6.1

SEE 1264: 15

fence
See fol. 15
SCALE 1 / 500
o denotes Iron put unless otherwise stated

Bearings are Cassini Grid based on Solar Observations

Distances are in metres

Plan of a Parcel of land coloured pink in the Ward of St. Anns

Containing nine hundred and twenty four square metres

Surveyed by me, with due authority, on April 07, 2001 for Cecil Gittens

In accordance with Regulation 25(1) of the Land Surveyors' Regulations 1998, I certify that this plan is correct.

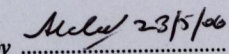
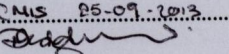
Checked by 
Entered 

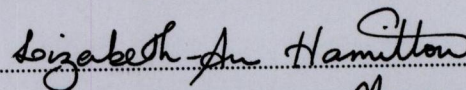
Trinidad and Tobago Land Surveyor November 16 2005