

1292

161

Process L~~o~~# 67119

Ward of Pointe a Pierre
County of Victoria
Cadastral Sheet D.22.G., $\frac{53 C}{1/b}$

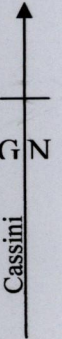

To be brought under the Provisions of the
REAL PROPERTY ORDINANCE

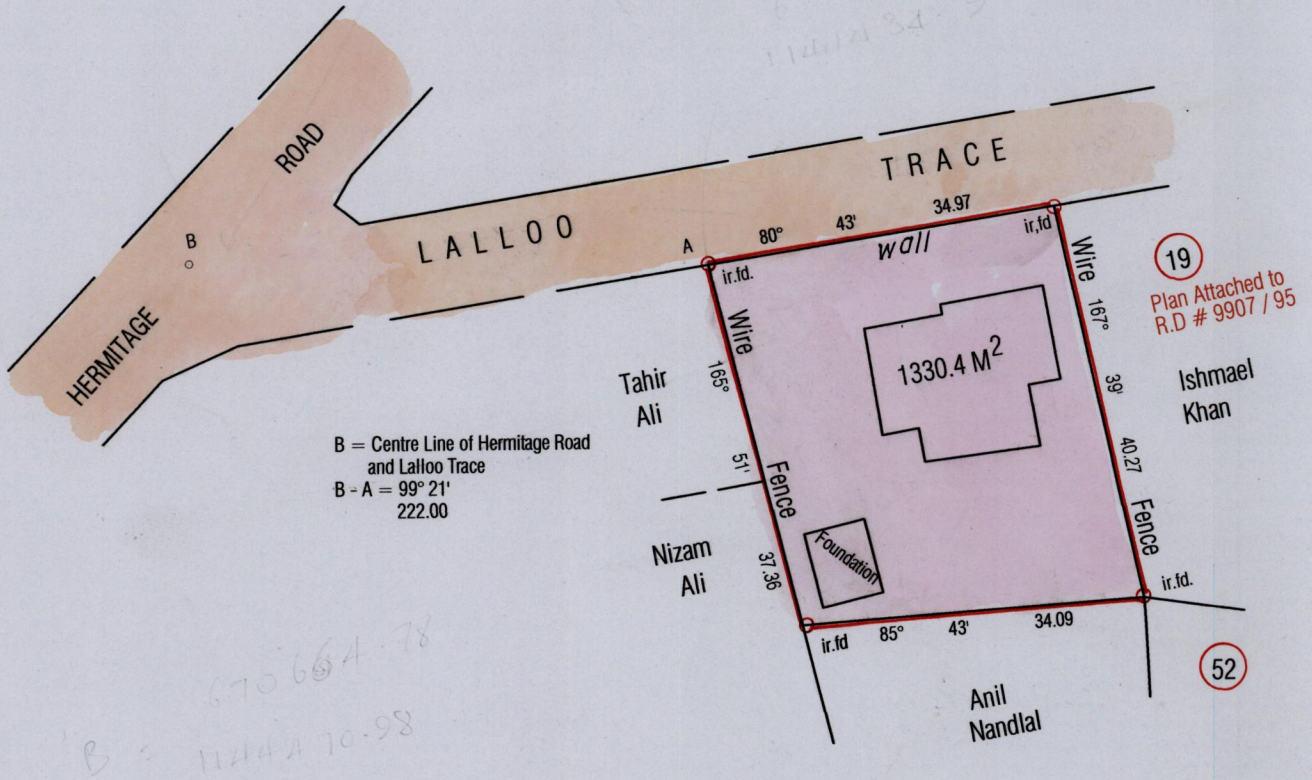

Approved Director of Surveys 2006-3-1

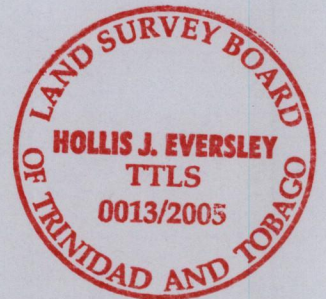

- Denotes iron put except otherwise stated
- Bearings are Cassini Grid based on Solar Obs.

SCALE 1:750

Note: To obtain compass bearings add/subtract minutes Distances are in metres

PLAN of a Parcel of land coloured pink in the Ward of Pointe a Pierre
Containing one thousand three hundred and thirty point four square metres
Surveyed by me, with due authority on 2nd March 2005 at the request of Baldeo Nandlal

In accordance with Regulation 25 (1) of the Land Surveyors' Regulations 1998, I certify
that this plan is correct.

Checked by 15-07-06

Entered on 15-07-13 Trinidad and Tobago Land Surveyor 22nd March 2005