

To be brought under the Provisions of the
Real Property Ordinance

Cadastral Sheet D.17.G. $\frac{43F}{1/b}$ & $\frac{43C}{3/d}$
Ward of Couva
County of Caroni
Vide : Bk. 1181 Fol. 15

Process JCB66830

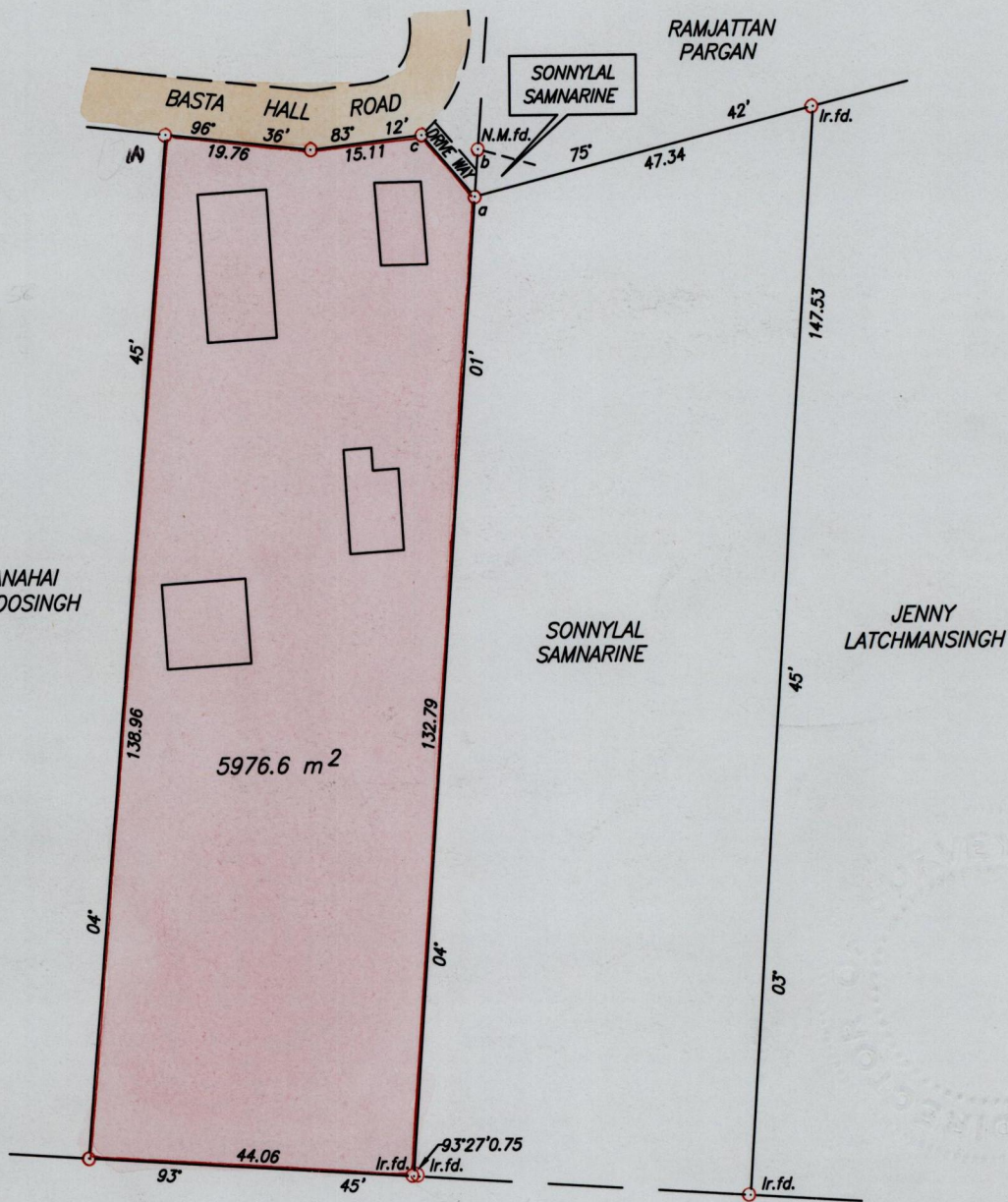

1A) - 670880
1150255
WGS 84.

ESPERANZA ESTATE
then
NATIONAL POULTRY COMPANY LTD.
BK. 1150 FOL. 115

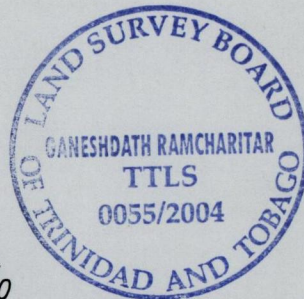

Approved

[Signature]
Director of Surveys
2005.9.19

a-b 04°04' 6.42
c-a 139°47' 11.02

SCALE 1/1000

Distances are in metres

○ Denotes Iron put except otherwise stated
Bearings are Cassini Grid based on Solar Observations

Plan of a Parcel of land coloured pink in the Ward of Couva
Containing five thousand nine hundred and seventy six point six square metres
Surveyed by me, with due authority, on November 9th. 2004 for Sumaria Madho Seelochan,
In accordance with Regulation 25 (1) of the Land Surveyors' Regulations 1998,
I certify that this plan is correct.

Seizdath Seelochan &
Davananan Bridgelal
Suedan Sohan Seelochan

Entered on

Checked by *13.9.05*

[Signature]
Trinidad & Tobago Land Surveyor 2004

ENTERED: CHS 01-07-2013