

R.P.O. Vol. 23 Folio 565  
C.T. Vol. 2001 Folio 299

Cadastral Sheet G.8.N. & 63C  
Ward of Naparima  
County of Victoria

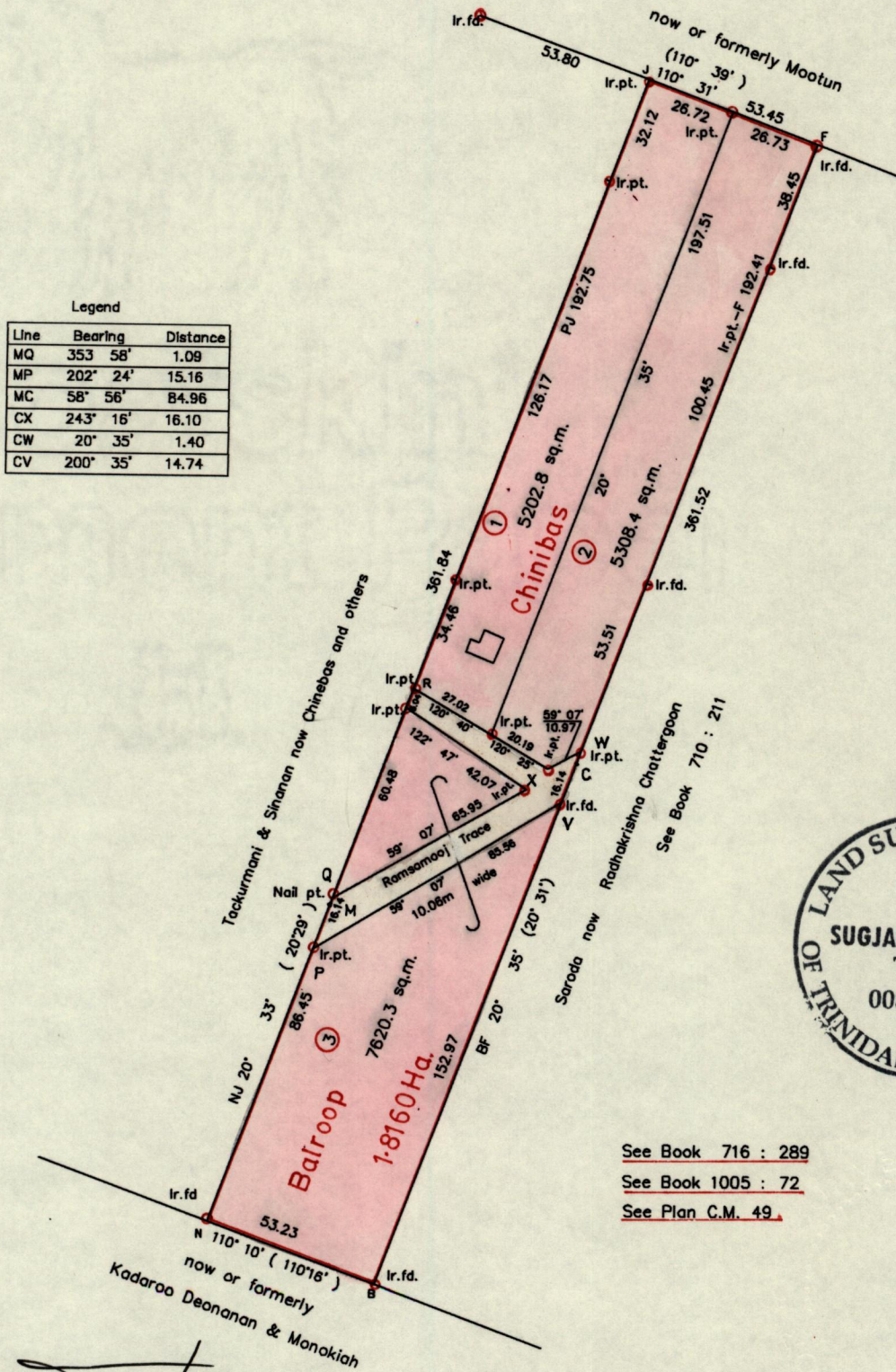

Legend

Line	Bearing	Distance
MQ	353° 58'	1.09
MP	202° 24'	15.16
MC	58° 56'	84.96
CX	243° 16'	16.10
CW	20° 35'	1.40
CV	200° 35'	14.74

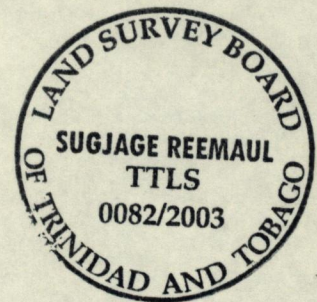

See Book 716 : 289  
See Book 1005 : 72  
See Plan C.M. 49.

Approved *[Signature]*  
Director of Surveys 2004.3.9

Scale 1 : 2000  
Distances are in Metres

Note : Bearings are Cassini Grid based on Solar Observations  
Plan of three parcels of land coloured pink in the Ward of Naparima  
Containing together One point eight one three one hectares  
Surveyed by me with due authority in March 2002

In accordance with Reg. 25 (1) of the Land Surveyors' Regulations 1998,  
I certify that this plan is correct

Trinidad and Tobago Land Surveyor *[Signature]* date 13<sup>th</sup> August, 2002

Checked by *[Signature]* 17 Nov 02

Entered.....