

R.P.O Vol. 125 Fol. 687

C.T. Vol. 2419 Fol. 165

U.P.R.N. No.

Ward of Siparia  
County of St. Patrick  
Cadastral Sheet G. 17. A.

73A  
2/a&c

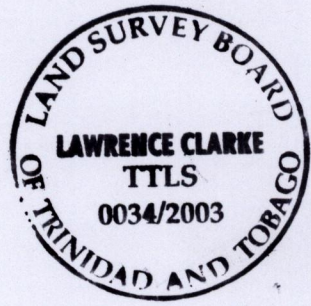
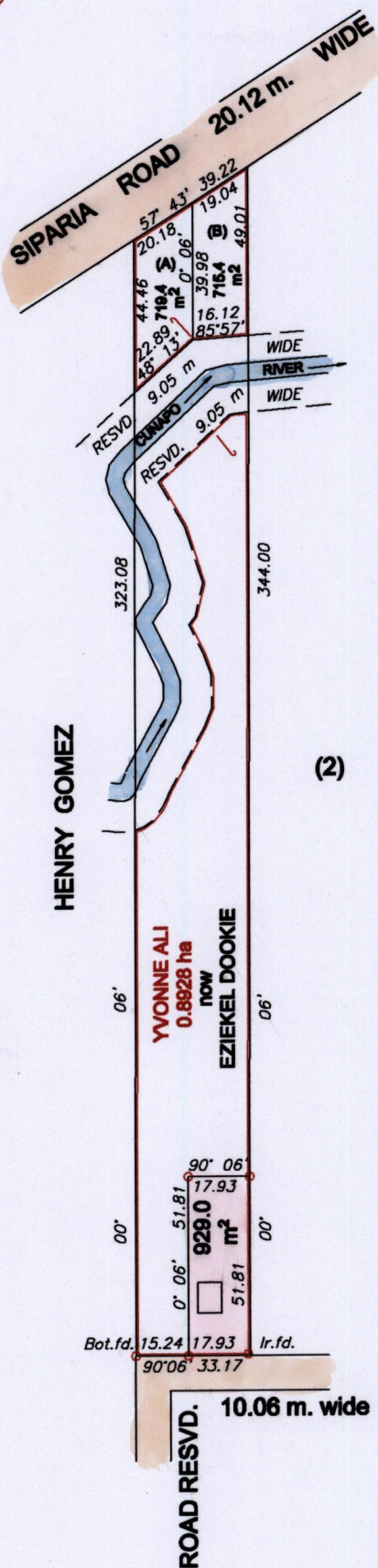

See Bk. 1103 Fol. 186  
Bk. 1256 Fol. 81

Approved *[Signature]*  
Director of Surveys  
2004.3.3

SCALE 1/2000

Denotes Iron put except stated otherwise.

Note : To obtain compass bearing subtract 6 minutes. Distances are in metres  
 Plan of a Parcel of land coloured pink in the Ward of Siparia  
 Containing nine hundred and twenty nine square metres.  
 Surveyed by me, with due authority, in October 2000  
 In accordance with Regulation 25 (1) of the Land Surveyors' Regulations 1998,  
 I certify that this plan is correct.

Checked by *[Signature]*  
Entered .....  
 Trinidad & Tobago Land Surveyor... *[Signature]* 2003  
 3<sup>rd</sup> December 2002