

R.P.O. Vol. 50 Fol. 437

C.T. Vol. 3128 Fol. 431

Ward of St. Anns

County of St. George

Cadastral Sheet B.17.1 $\frac{13E}{4d}$

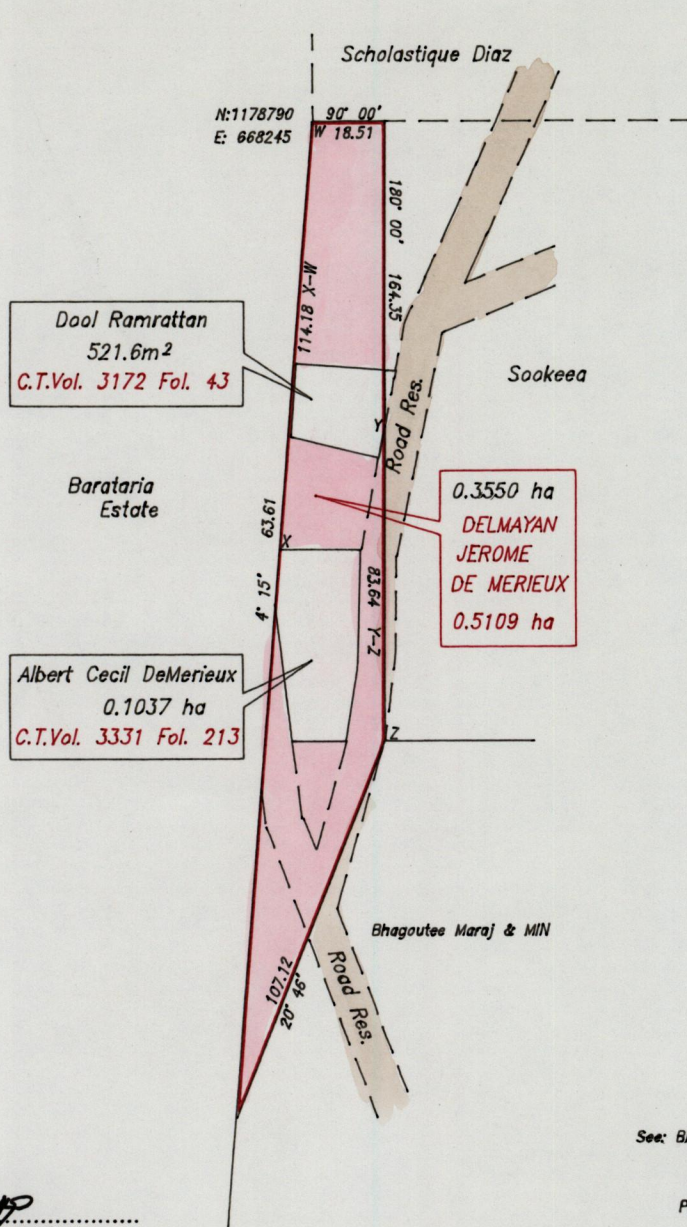

Approved
[Signature]
Director of Surveys
2004.10.13

See: Bks. 63/24
780/8
1155/263
Plan: JA121

Co-ordinates scaled from 1/10,000 ward sheet
Bearings are Cassini grid based on Magnetic Needle

Note: To obtain compass bearings subtract 0 minutes.

SCALE 1/2000

Distances are in metres

This is a true copy of a diagram of zero point five one zero nine hectares originally transferred to Delmayan Jerome De Merieux, shewing a portion coloured pink containing zero point three five five zero hectares being the remainder after two previous transfers of other portions of the land. the dividing lines having been run in accordance with regulation 25 (1) of the Land Surveyors' Regulations 1998,

I certify that this plan is correct.

Checked by *[Signature]* *[Signature]*

Entered..... Trinidad & Tobago Land Surveyor *10th October 2003*