

REMAINING PORTION

R.P.O. Vol.  
C.T. Vol. 2833

Fol.  
Fol. 221

Cadastral Sheet I.17. 1F  
57d  
Ward of Tobago  
Parish of St. Patrick

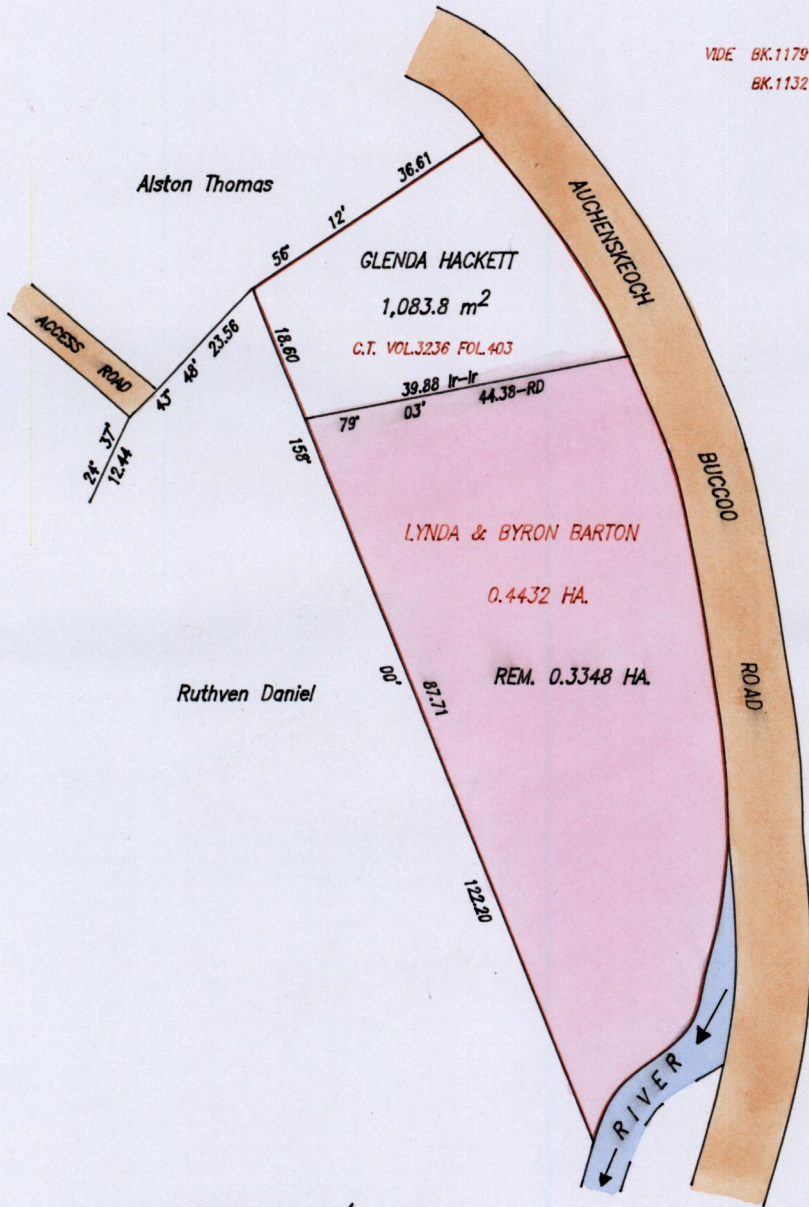

VIDE BK.1179 FOL.43  
BK.1132 FOL.24

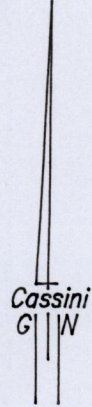

SCALE 1:1000

Distances are in metres

Approved

*[Signature]*  
 Director of Surveys

Bearings are based on Solar Observations

This is a true copy of a diagram of zero point four four three two hectare originally transferred to Lynda and Byron Barton ,showing a portion coloured pink and containing zero point three three four eight hectare being the remainder after one previous transfer of another portion of the land.

In accordance with Regulation 25 (1) of the Land Surveyors' Regulations 1998 , I certify that this plan is correct.

Checked by

*[Signature]* 14/01/04

*[Signature]*

Entered on . . . . .

Trinidad & Tobago Land Surveyor. . . . . 6th August 2003

PATH=C:\TOBAGO\BARTON.DWG

