

R.P.O. Vol. Fol.
C.T. Vol. 2790 Fol. 333

Ward of Siparia
County of St. Patrick
Cadastral Sheet G.13.G. 63F
1/d

See Bk. 780 : 144

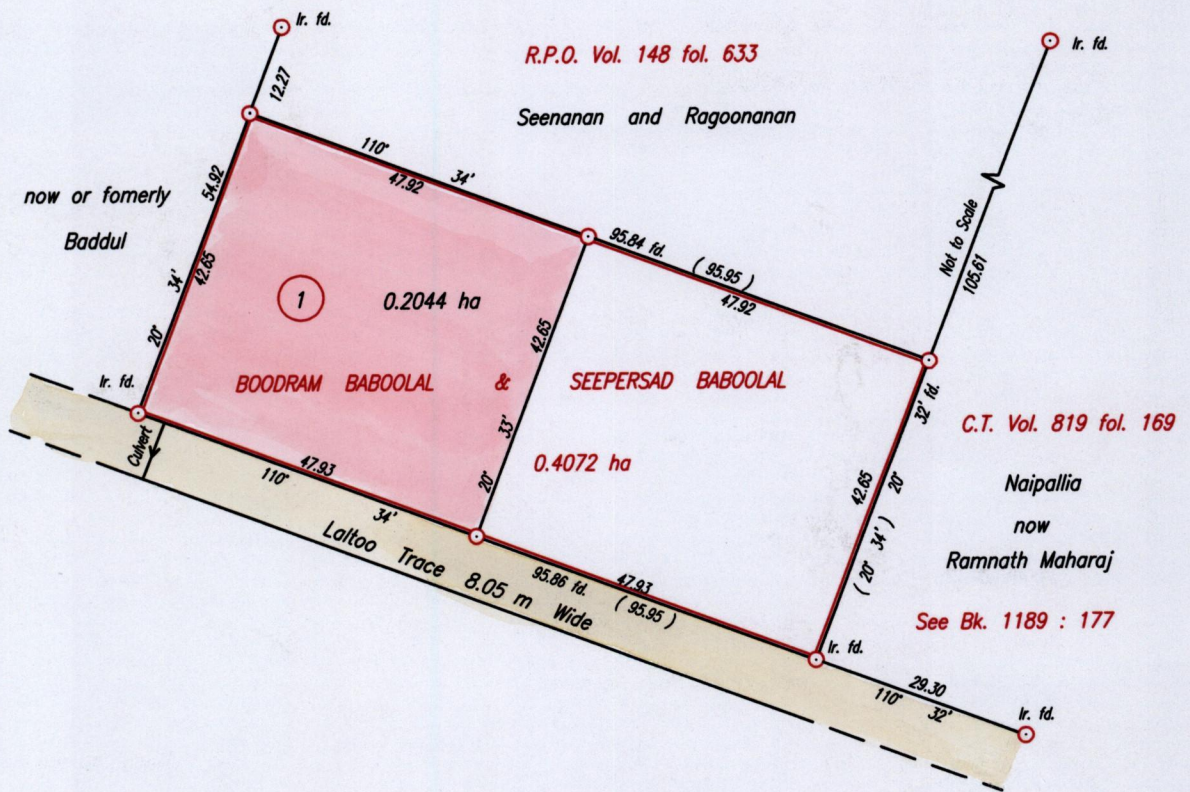

Approved *[Signature]*
Director of Surveys.
10.7.2004

SCALE 1:1000

○ Denotes iron put except otherwise stated.
Bearings are Cassini Grid based on Solar Observations.

Distances are in Metres

Plan of a Parcel of land coloured pink in the Ward of Siparia
Containing zero point two zero four four hectares.

Surveyed by me, with due authority, in September, 2002 .

In accordance with Regulation 25(1) of the Land Surveyors' Regulations 1998,
I certify that this plan is correct.

Checked by *[Signature]* 25.04.04
Entered

[Signature]
Trinidad & Tobago Land Surveyor 12th March . . .2004

