

R.P.O. Vol. 108 Fol. 81
 C.T. Vol. 3441 Fol. 135
 C.T. Vol. 477 Fol. 57
 U.P.R.N. No.

Ward of Siparia
 County of St. Patrick
 Cadastral Sheet C.17.F.
 T3-A
 4/a&b

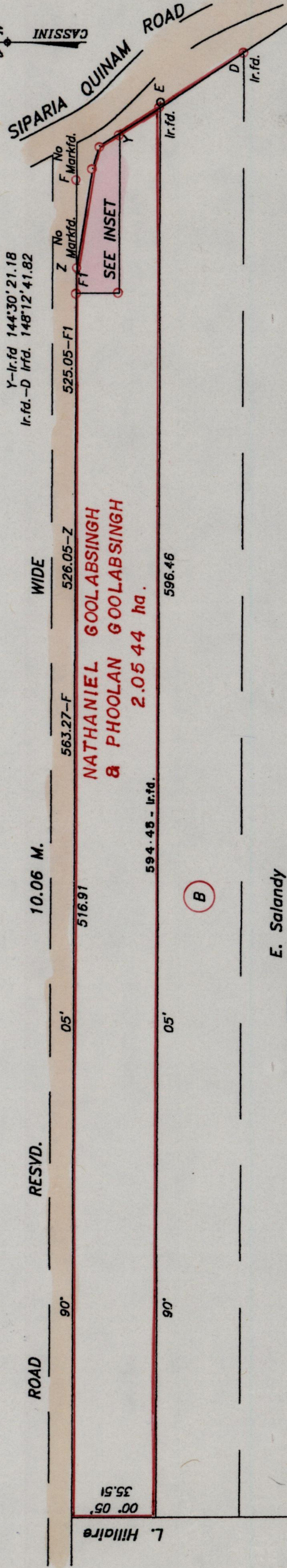

1289 242

SCALE 1/750

E. Salandy

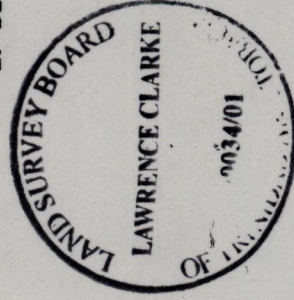

Bk. Fol.
 SCALE 1/2000

Approved *[Signature]*
 Director of Surveys
 2024 6 22

○ Denotes Iron put except stated otherwise
 Note: To obtain compass bearing subtract 5 minutes
 Plan of a Parcel of land coloured pink in the Ward of Siparia
 Containing nine hundred and twenty nine point one square metres.
 Surveyed by me with due authority, in July 1999
 In accordance with Regulation 25 (1) of the Land Surveyors' Regulations 1998,
 I certify that this plan is correct.

Checked by *[Signature]*
 Entered on.....
 Trinidad & Tobago Land Surveyor. *[Signature]*.....2002!