

Ward of Siparia
County of St. Patrick
Cadastral Sheet C.13.1.
63.E
4/6

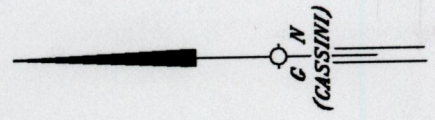

REMAINING PORTION PLAN

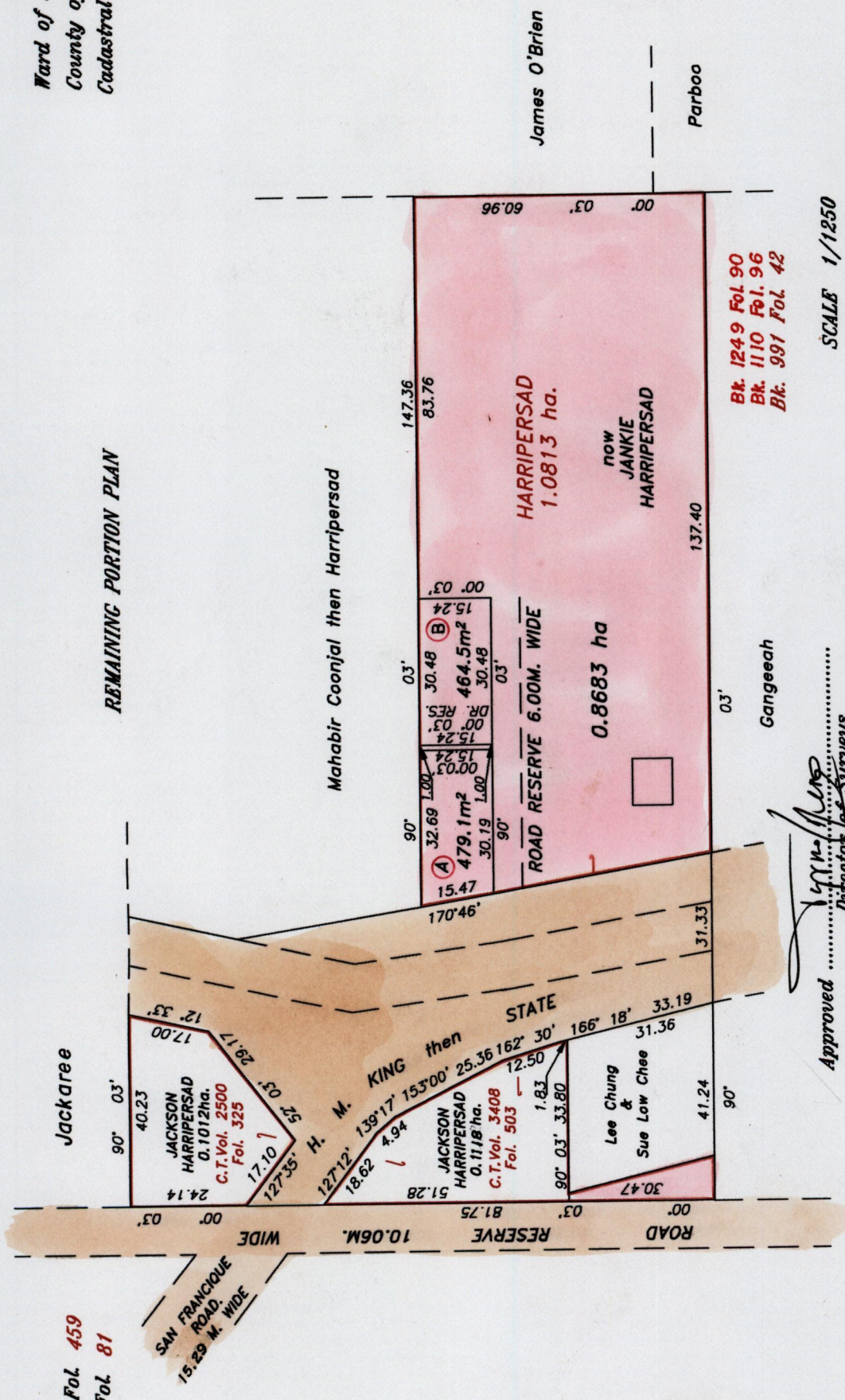

SCALE 1/1250

Note : To obtain compass bearings subtract 3 minutes
This is a true copy of a diagram of one point zero eight one three hectares originally, transferred to , shewing a portion coloured pink and containing zero point eight three hectare being the remainder after (2) two previous transfers of other portions of land.
In accordance with Regulation 25 (1) of the Land Surveyors Regulations 1998,
I certify that this plan is correct.

Approved
Director of Surveys

25.04.5.24

Checked by M.M. 1.4.05/09
Entered
Trinidad & Tobago Land Surveyor. 18. P. M. ... 2003

R.P.O Vol. 59 Fol. 459
C.T. Vol. 2189 Fol. 81
U.P.R.N. No.