

REMAINING PORTION

R.P.O. Vol. 164 Fol. 393

C.T. Vol. 1242 Fol. 167

Ward of Siparia

County of St. Patrick

Cadastral Sheet (G.13.E.) 63.E.

2/c

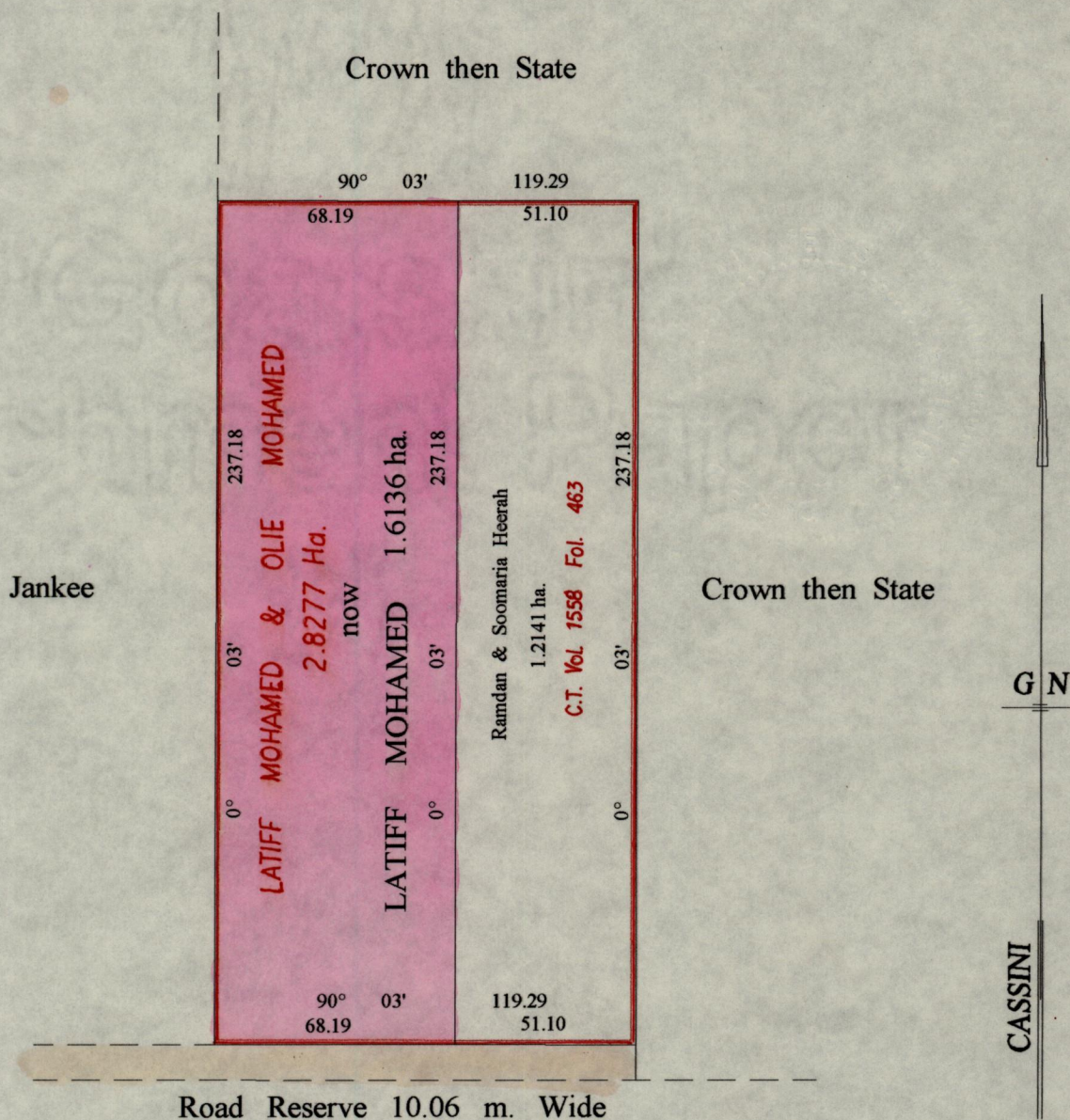

Vide Bk. 948 fol. 137

Vide Bk. 983 fol. 23

Approved *[Signature]*
Director of Surveys

SCALE : 1:2000

Note: Bearings are cassini grid based on solar observations Distances are in metres

This is a true copy of a diagram of two point eight two seven seven hectares, originally transferred to Latiff Mohamed & Olie Mohamed, shewing a portion coloured pink and containing one point six one three six hectares being the remainder after one (1) previous transfer of another portion of the land. In accordance with Regulation 25 (1) of the Land Surveyor s'Regulations 1998, I certify that this plan is correct.

Checked by *[Signature]*

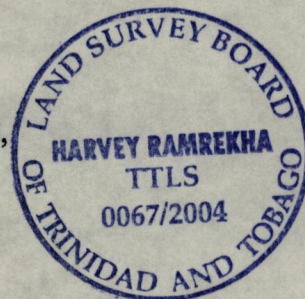

Entered on Trinidad & Tobago Land Surveyor 9. 02 . 2004