

S.O. 764/20
R.P.O. Vol. 493 Fol. 267

Cadastral Sheet B.25.P, 25D
Ward of Tamana 2/c
County of St. Andrew
Bk. 213 fol. 401

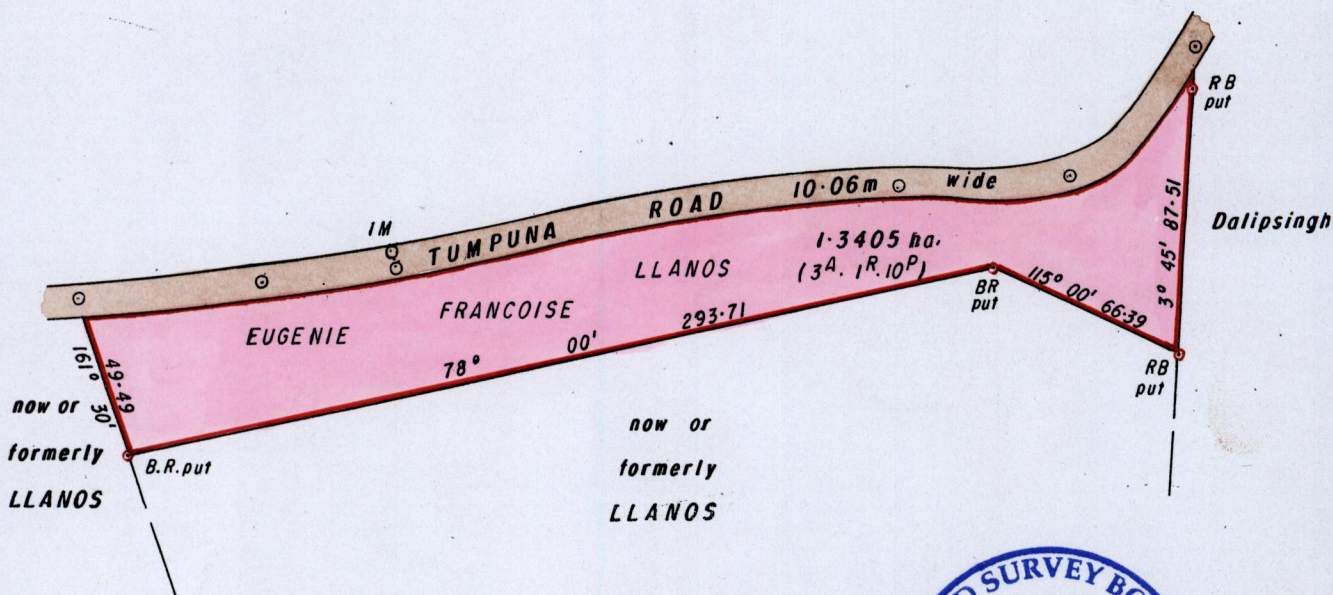

Approved *[Signature]*
Director of Surveys
2004.5.10

SCALE: 1/2500
Distances are in metres

• Denotes Ir.put unless otherwise stated

PLAN of a Parcel of land coloured pink in the Ward of Tamana
Containing one point three four zero five hectares

Prepared by me, from a survey done by Mr. J. Dumanoire in Oct. 1919 for a Vesting order
In accordance with Regulation 25 (1) of the Land Surveyors' Regulations 1998,

I certify that this plan is correct

Checked by *[Signature]* 2004.5.10

Entered on.....

Bhaghirathi Maharaj
Trinidad & Tobago Land Surveyor..... 10/05/2004