

R.P.O Vol 10 Fol 559

C.T. Vol 587 Fol 339

U.P.R.N. No.

Vol. 4889 Fol. 401

Process ID# 65750

REMAINING PORTION

Cadastral Sheet 63D, G.11.H
1/d

Ward of Siparia

County of St. Patrick

Bk 721 Fol 292

Bk 1163 Fol 154

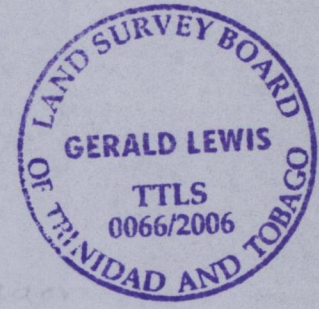
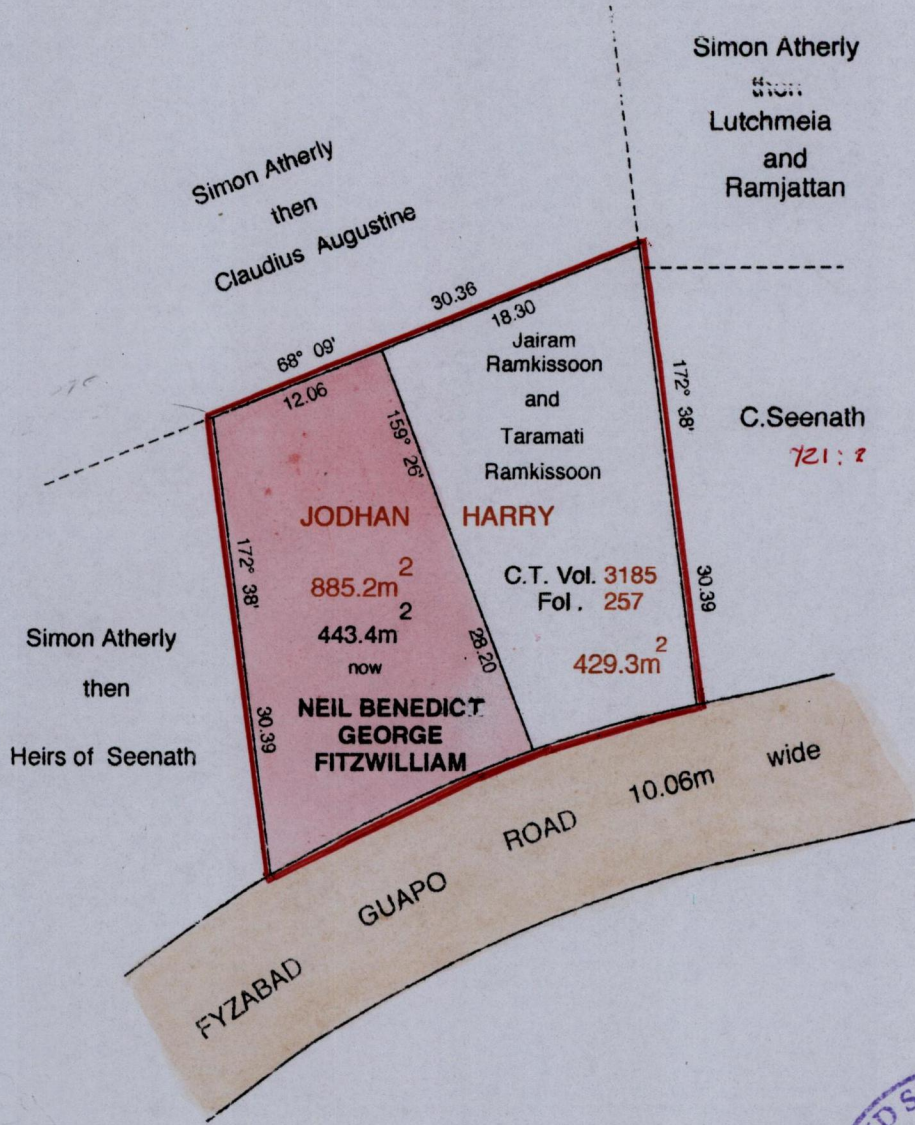
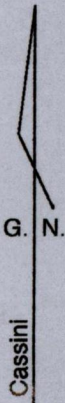

Approved *[Signature]*
Director of Surveys
2006-12-11

Neil Benedict George Fitzwilliam
Distances are in Metres
SCALE 1 : 500

This is a true copy of a diagram of **eight hundred and eighty five point two square metres** originally transferred to **JODHAN HARRY**, showing a portion coloured *pink* and containing **four hundred and forty three point four square metres** being the remainder after **one** previous transfer of another portion of the land. In accordance with Regulation 25(1) of the Land Surveyors' Regulations 1998, I certify that this plan is correct.

Checked by *mm 7/12/06*
Entered by *[Signature]*

[Signature]
Trinidad and Tobago Land Surveyor *18/07/2006*