

R.P.O. Vol. 227 Fol. 593  
C.T. Vol. 2618 Fol. 451  
Vol. 4976 Fol. 463

REMAINING PORTION

Ward of Savana Grande  
County of Victoria  
Cadastral Sheet ( G.15.B. ) 64.E.  
2/a

Process ID# 65631

CASSINI  
GN

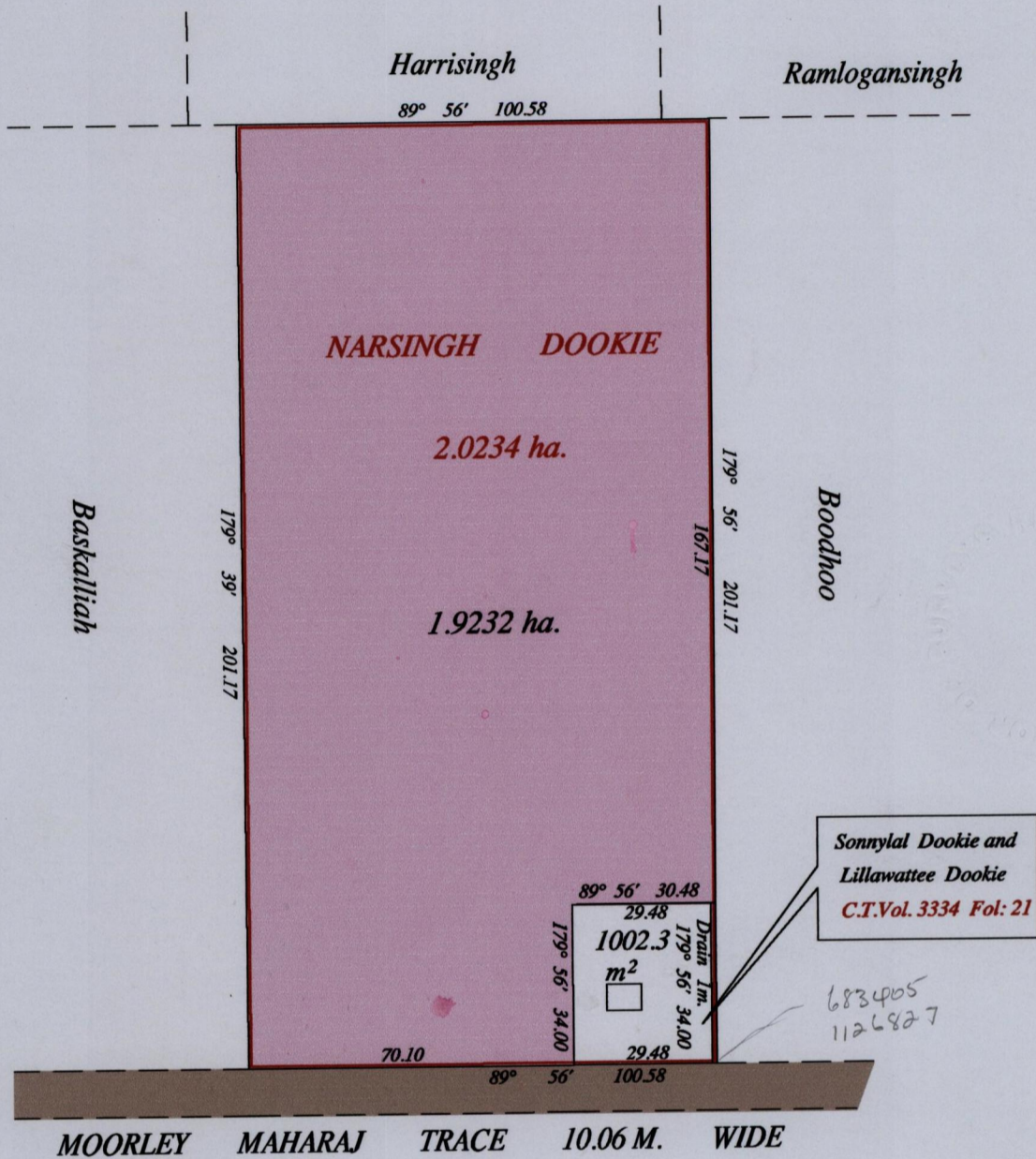

Lenny Ronny Baboolal

Vide Bk. 1189 fol. 26

Original Bk 306:121

Approved *[Signature]*  
Director of Surveys

SCALE : 1:1500

Note: Bearings are cassini grid based on solar observations Distances are in metres

This is a true copy of a diagram of two point zero two three four hectares, originally transferred to Narsingh Dookie, shewing a portion coloured pink and containing one point nine two three two hectares being the remainder after one (1) previous transfer of another portion of the land. In accordance with Regulation 25 (1) of the Land Surveyors' Regulations 1998, I certify that this plan is correct.

Checked by *[Signature]*

*[Signature]*

Entered on L.A.S. *[Signature]* Trinidad & Tobago Land Surveyor ..... 2007

