

R.P.O. Vol. 151 Fol. 45
 C.T. Vol. 1252 Fol. 279
 U.P.R.N. No.

Bl. 4495 fol. 299

Process ID # 65893

STATE

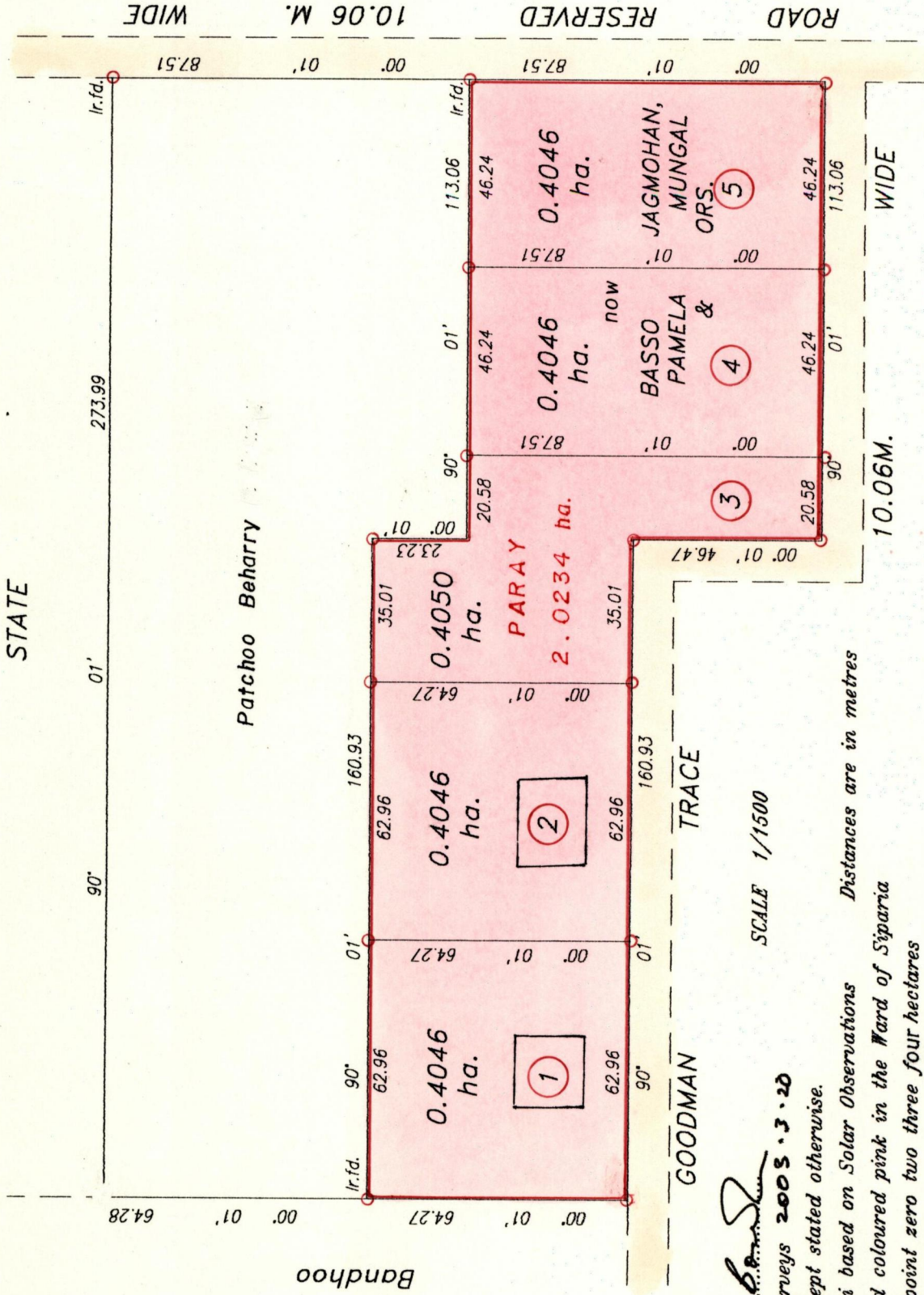

Approved
[Signature]
 Director of Surveys 2003.3.20

○ Denotes Iron put except stated otherwise.
 Bearings are Grid Cassini based on Solar Observations
 Plan of 5 Parcels of land coloured pink in the Ward of Siparia
 Containing together two point zero two three four hectares
 Surveyed by me with due authority, in August 2000
 In accordance with ~~the~~ Regulations (1) of the Land Surveyors' Regulations 1998,
 I certify that this plan is correct.

Checked by *[Signature]*

Enter on *[Signature]*

CMS 25-04-2013

Ward of Siparia
 County of Victoria
 Cadastral Sheet C.18.D.
 BK. 903
 Fol. 159

RESERVED ROAD 10.06 M. WIDE

Patchoo Beharry

Bandhoo

GOODMAN

TRACE

10.06M. WIDE

SCALE 1/1500

Distances are in metres

1287

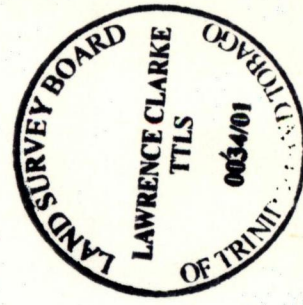
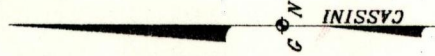

Trinidad & Tobago, Land Surveyor. 15th November 2001

50

No.	C. T. Volume	Name
1	Vol. 4495 fol. 305	Winston C. Pariag
2	Vol. 4495 fol. 321	Craugadaye Raghunath, Devika, Jagdish & Doolarie Balkaran
3	Vol. 4625 Fol. 259	Kelvin & Bhanmatie Pariag ✓
4	Vol. 4495 fol. 329	Pamela Mungab
5	Vol. 4495 fol. 313	Chandra Lochan, Maharani Ransubhag & Geeta Jagmohan

20 NOV 2001
Lands and
Surveys
Division

1271/282