

1287

223

Process ID# 65935

R.P.O Vol. 432

Fol 517

C.T Vol. 3395

Fol. 449

Ward of Siparia
County of St. Patrick
Cadastral Sheet G 14 B & F 64 D
1/b & d

Vol. 5079 fol. 37

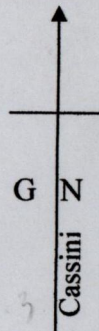

Bk. 950
Fol. 555

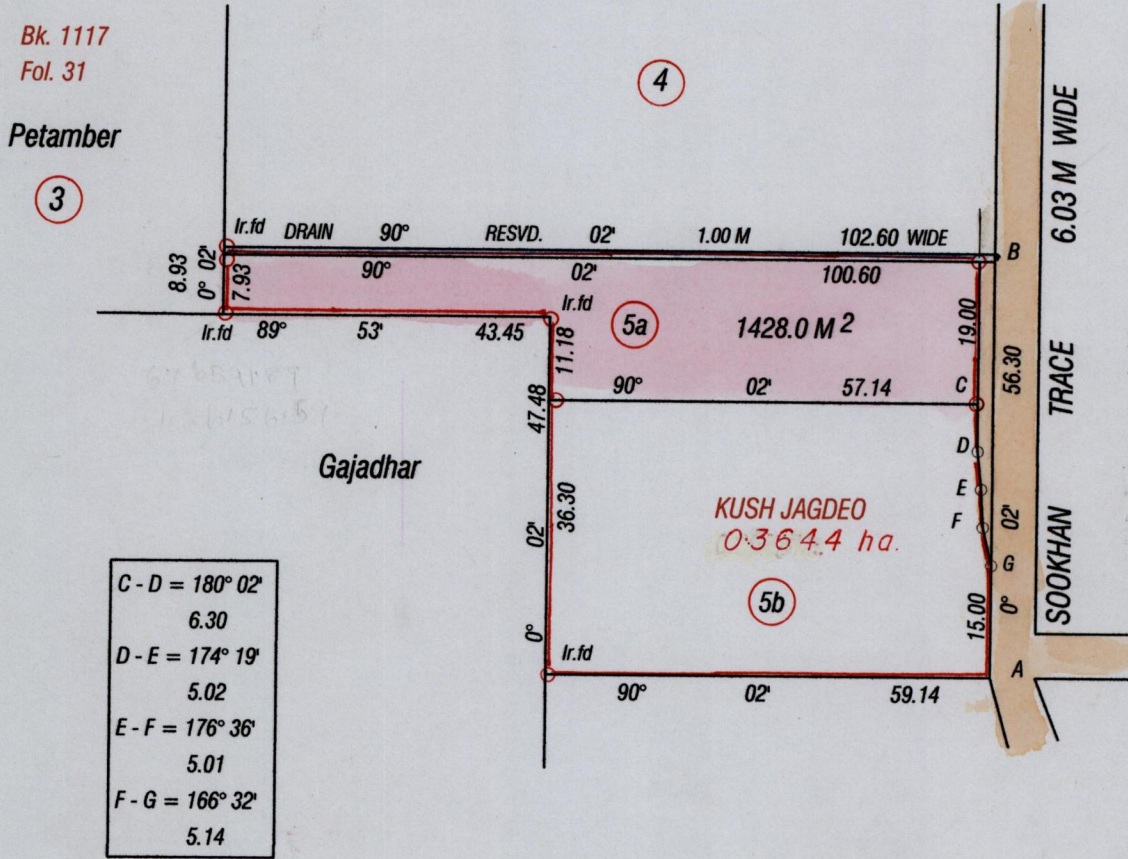

C - D = 180° 02'
6.30
D - E = 174° 19'
5.02
E - F = 176° 36'
5.01
F - G = 166° 32'
5.14

Lalla Jagdeo

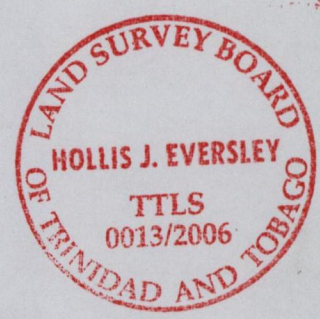

Approved.....
Director of Surveys
H.C. F. 2006

○ Denotes iron put except otherwise stated
Bearings are Cassini Grid based on Solar Obs
Note: To obtain compass bearings add/subtract minutes Distances are in metres

SCALE : 1/1000

PLAN of a Parcel of land coloured pink in the Ward of Siparia
Containing one thousand four hundred and twenty eight point zero square metres
Surveyed by me, with due authority, in January 2006
In accordance with Regulation 25 (1) of the Land Surveyors' Regulations 1998,
I certify that this plan is correct.

Checked by.....
Entered.....
Trinidad and Tobago Land Surveyor..... 2006