

Ward of Naparima
County of Victoria
Cadastral Sheet (G.8.N) 63.C.
3/c

Process No. 65858

R.P.O. Vol. 23 Fol. 569
C.T. Vol. 2132 Fol. 81
Vol. 4934 Fol. 337

5.03	XI	13.46	5.03
5.03		9.25	5.03
4.43	X	170° 50'	4.63
5.03	X	30.74	5.03
5.03		21.52	5.03
5.03		10.26 = W1	5.03
5.03		9.86	5.03
	W	177° 26'	

P.W.D. Survey No. 7 of 1938

Approved: *[Signature]*
Director of Surveys
12/07/09

Denotes Iron put except stated otherwise.
Note: Bearings are cassini grid based on solar observations
PLAN of a Parcel of land coloured pink in the Ward of Naparima
Containing one thousand three hundred and thirty point zero square metres
Surveyed by me, with due authority, in October 2005
In accordance with Regulation 25 (1) of the Land Surveyors' Regulations 1998,
I certify that this plan is correct.

Checked by: *[Signature]*
12/07/09

Entered on 04/15/05-07-2005 Trinidad & Tobago Land Surveyor *[Signature]* 17/3 Nov 2005

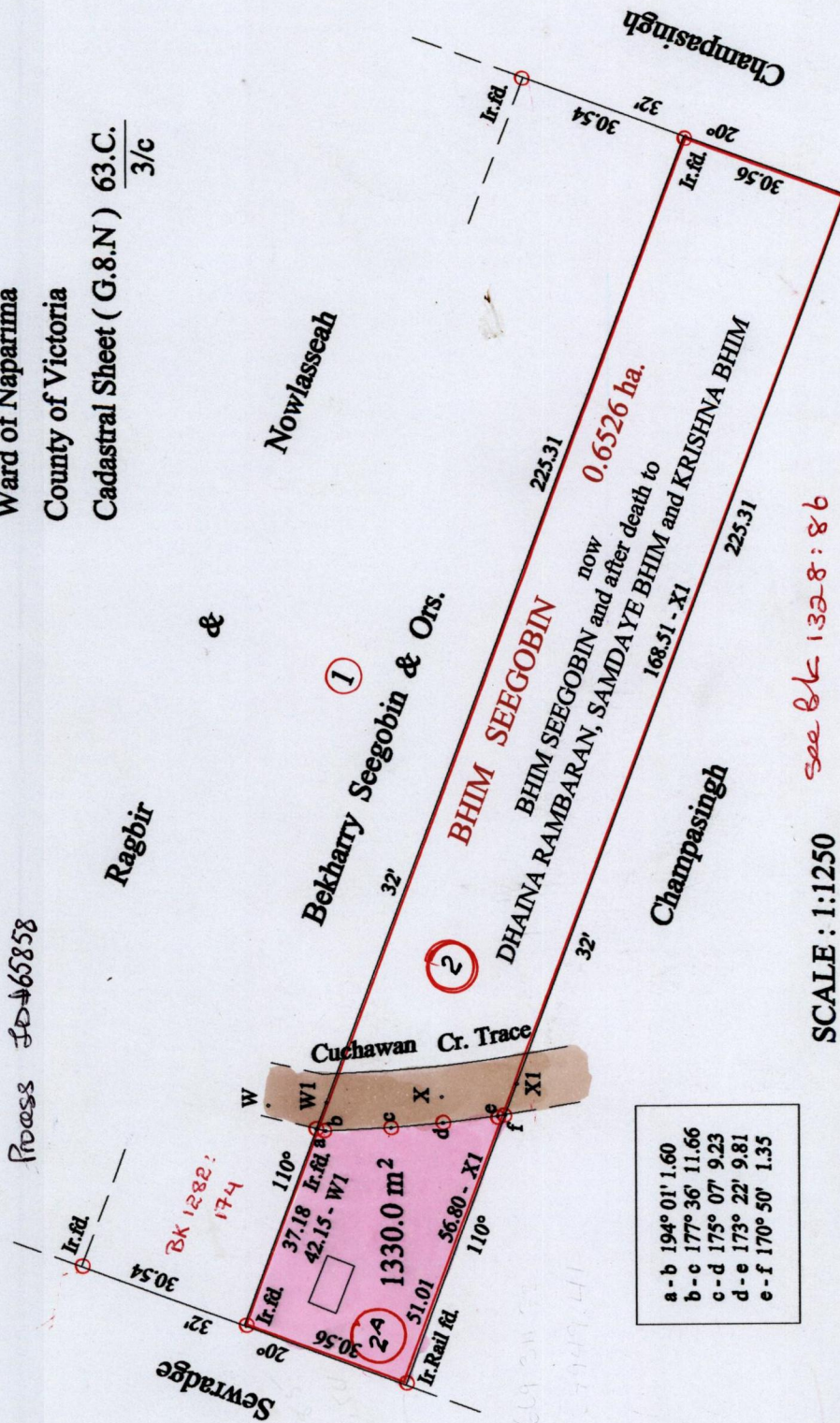

a - b	194° 01'	1.60
b - c	177° 36'	11.66
c - d	175° 07'	9.23
d - e	173° 22'	9.81
e - f	170° 50'	1.35

SCALE : 1:1250

see bk 1328:86

Dharan & Richard Rambaran

Vide Bk. 999 fol. 102 Original

