

Process **SP# 65850**

**1287**  
REMAINING PORTION

**198**

R.P.O. Vol. **141** Fol. **45**

Ward of Siparia

C.T. Vol. **1038** Fol. **427**

County of St. Patrick

U.P.R.N. No.:

Cadastral Sheet G.18.H.  $\frac{73C}{2/c}$

**Vol. 4916 Fol. 313**

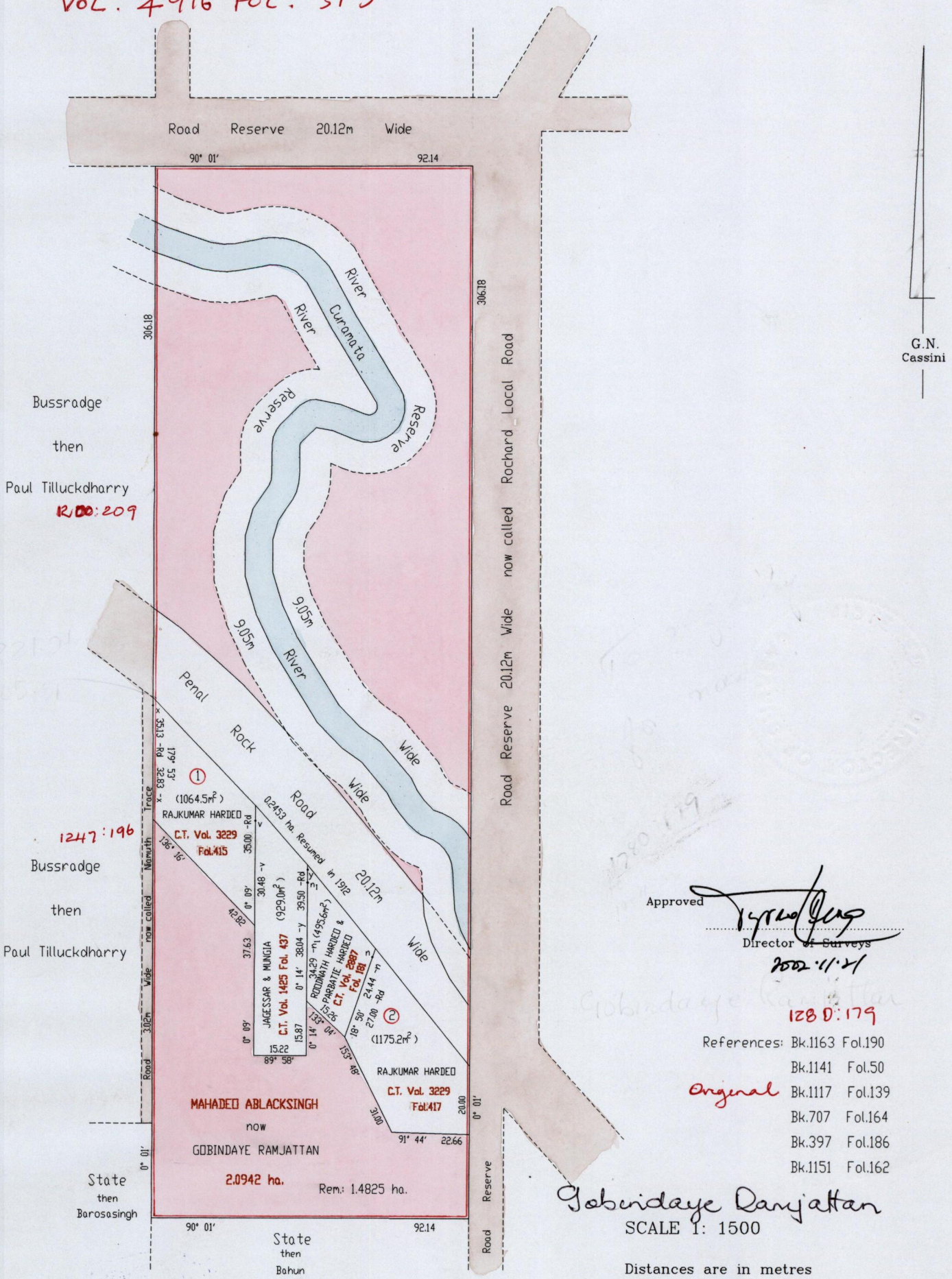

Approved *[Signature]*  
 Director of Surveys  
 2002-11-21

- References:
- Bk.1163 Fol.190
  - Bk.1141 Fol.50
  - Bk.1117 Fol.139
  - Bk.707 Fol.164
  - Bk.397 Fol.186
  - Bk.1151 Fol.162

*GoBINDAYE RAMJATTAN*  
 SCALE 1: 1500  
 Distances are in metres

This is a true copy of a diagram of two point zero nine four two hectares originally transferred to MAHADEO ABLACKSINGH, showing a portion coloured pink and containing one point four eight two five hectares being the remainder after one (1) Resumption and four (4) previous transfers of another portion of the land. In accordance with Regulation 25(1) of the Land Surveyors' Regulations 1998, I certify that this plan is correct.

Checked by *M.M. 12/11/02*  
 Entered *[Signature]*  
 24-05-13

*[Signature]*  
 Trinidad & Tobago Land Surveyor 8/11/2002

