

REMAINING PORTION

Ward of Siparia

County of St. Patrick

Cadastral Sheet (G.17. B & F.)

73 A
2/d

R.P.O. Vol. 11 fol. 127

C.T. Vol. 2986 fol. 219

Bk. 1211 fol. 162

Vol 4978 Fol 63

Process ID# 65820

State then
Jean Batiste Osendo

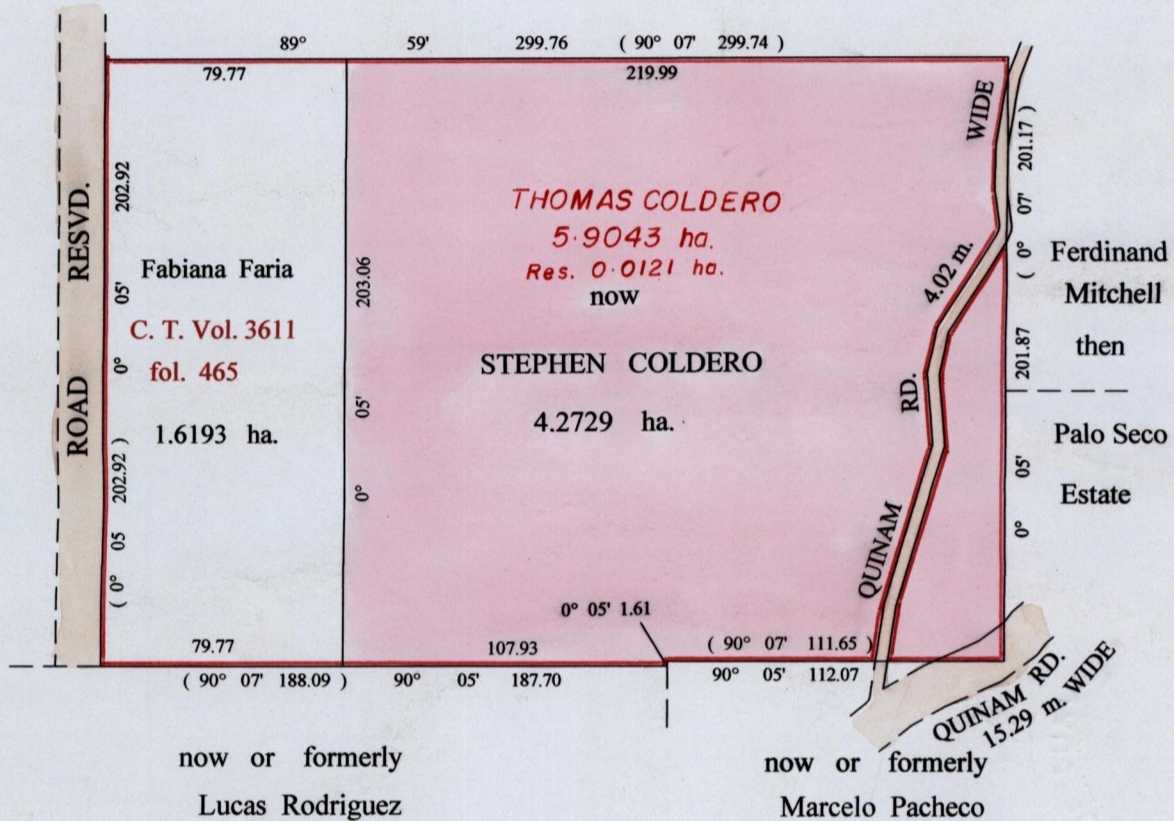

Approved *[Signature]*
Director of Surveys
2007-10-31

Original Bk 456:138
Stephen Coldero
Stephen Coldero

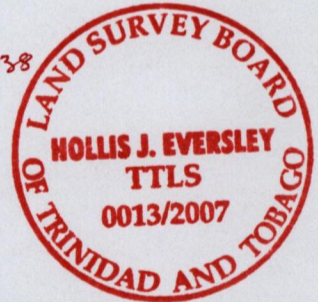

SCALE : 1: 2500

Note: Bearings are cassini grid based on solar observations Distances are in metres

This is a true copy of a diagram of five point nine zero four three hectares originally granted to THOMAS COLDERO, shewing a portion coloured pink and containing four point two seven two nine hectares being the remainder after one Resumption & one previous transfer of another portion of land. the dividing lines having been run in accordance with Regulation 25 (1) of the Land Surveyor's Regulations 1998. I certify that this plan is correct.

Checked by *[Signature]* 2007/10/23

Entered on *[Signature]* 22-05-13
Trinidad & Tobago Land Surveyor *[Signature]* 16th August 2007