

4189

1287

L. & S.—56

180

REMAINING PORTION

R.P.O. Vol. 169 Fol. 383

C. of T. Vol. 1471 Vol. 197

Cadastral Sheet (G. 13. G) 63.F 1/d.

Ward of Siparia

County of St. Patrick.

Vol. 4959 Fol. 113

Process ID# 65734

G N

VIDE BK. 935 FOL. 275 .

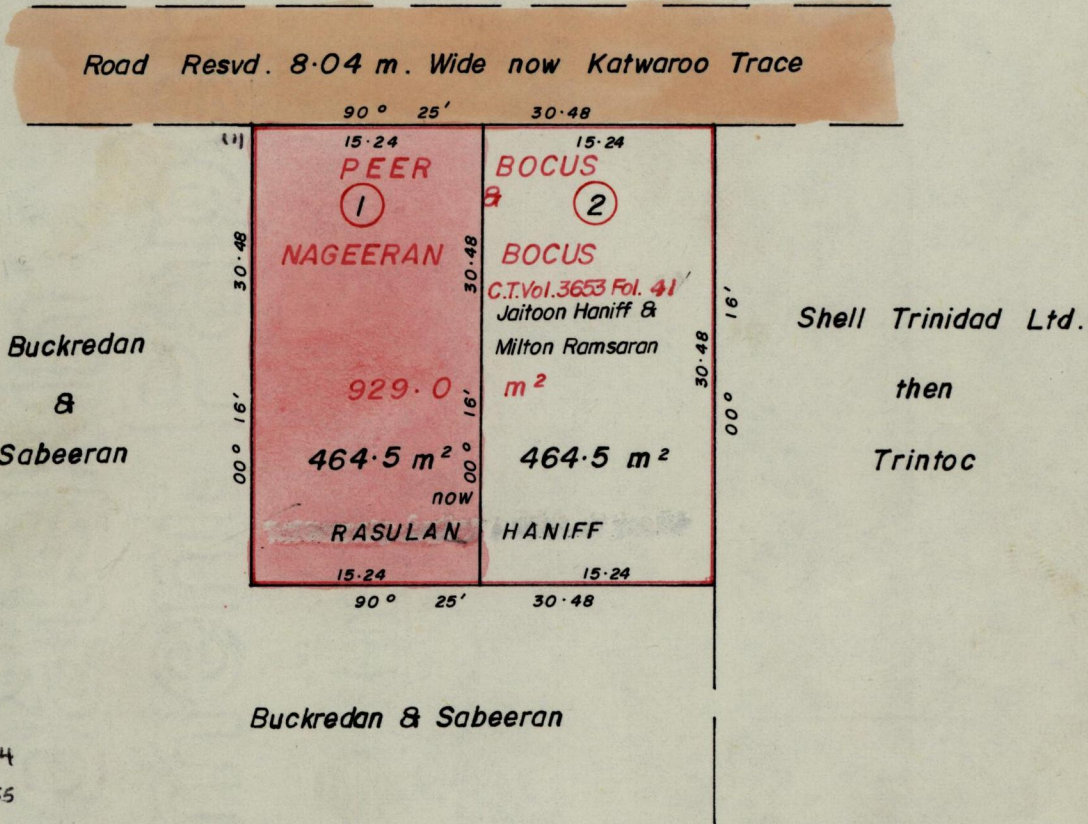

671018-64  
1125007-55  
2045 84

AMENA RAZACK

Orig. 1219 fol 54

Approved

*[Signature]*  
Director of Surveys  
95.062

Note: To obtain compass bearings <sup>add</sup> 2 minutes <sub>subtract</sub>

SCALE 1:500 .

Distances are in metres .

This is a true copy of a diagram of nine hundred and twenty nine square metres originally transferred granted to PEER BOCUS & NAGEERAN BOCUS , shewing a portion coloured pink and containing four hundred and sixty four point five sq. metres being the remainder after ( 1 ) one previous transfer of another portion of the land. the dividing lines having been run in conformity with Rule 76 under Sec. 7(a) of Cap. 27. No. 2 and duly certified by the Director of Surveys.

Checked by *[Signature]* 26 May 95

Entered on *[Signature]* 23-05-2013

*[Signature]* Harvey S. Ramzeekha  
Land Surveyor, Trinidad, 18-04-1995