

Process ID# 65668

Vd. 4771 Pol. 3A5

R.P.O. Vol. 693

Fol. 211

C.T. Vol. 2002

Fol. 521

Ward of Charuma
County of Nariva
Cadastral Sheet E. 21. I., 55 A

Ref. Bk. 635 fol. 119

2/d

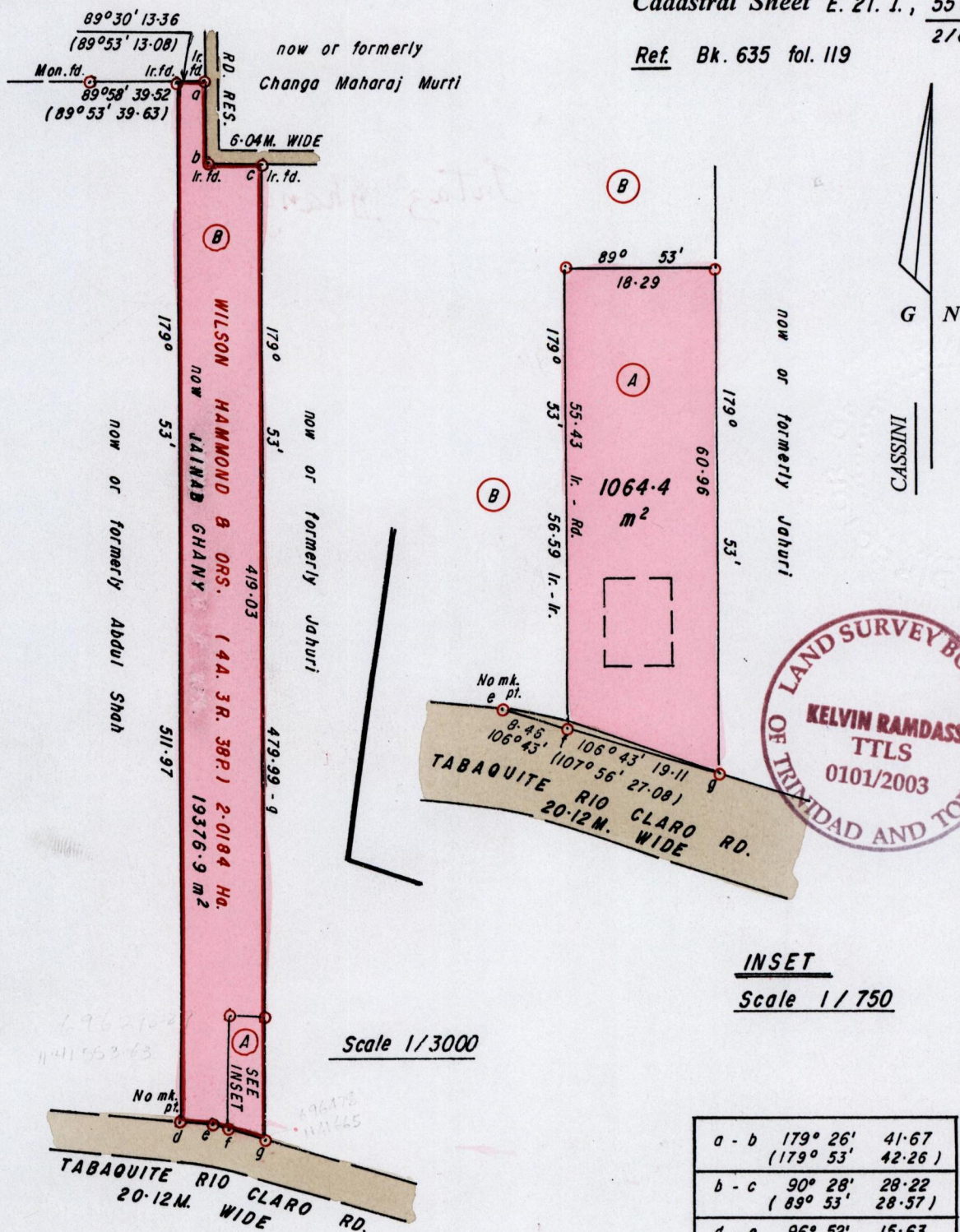

INSET
Scale 1 / 750

Scale 1 / 3000

Approved *[Signature]*
Director of Surveys
2004.10.15

○ Denotes Iron put unless otherwise stated
Bearings are Cassini Grid based on Solar Obs.
SCALE 1/3000 & 1/750 (INSET)
Distances are in METRES

Note: To Obtain compass bearings add/subtract minutes

PLAN of 2 Parcels of land coloured PINK in the Ward of Charuma
Containing together two point zero four four one hectares
Surveyed by me, with due authority, in August 2003
In accordance with Regulation 25 (1) of the Land Surveyors' Regulations 1998,
I certify that this plan is correct.

Checked by M.M. 21/9/04

[Signature]

Entered *[Signature]*

Trinidad and Tobago Land Surveyor *[Signature]* 22/12/2003

Lot A

Lot B Vol. 4771 Pl. 351

Intaz Ghany

14 JAN 2004
Lands and
Surveys
Division