

1287

169

REMAINING PORTION

Process ~~SD~~ 65666

R.P.O. Vol. 114 Fol. 633

C.T. Vol. 3896 Fol. 145

Vol 5030 Fol 175

Cadastral Sheet G 12 P, $\frac{63E}{4/c/3}$

Ward of Siparia

County of St. Patrick

Plan Ref. J.B. 104

Bk. 1238 fol 13

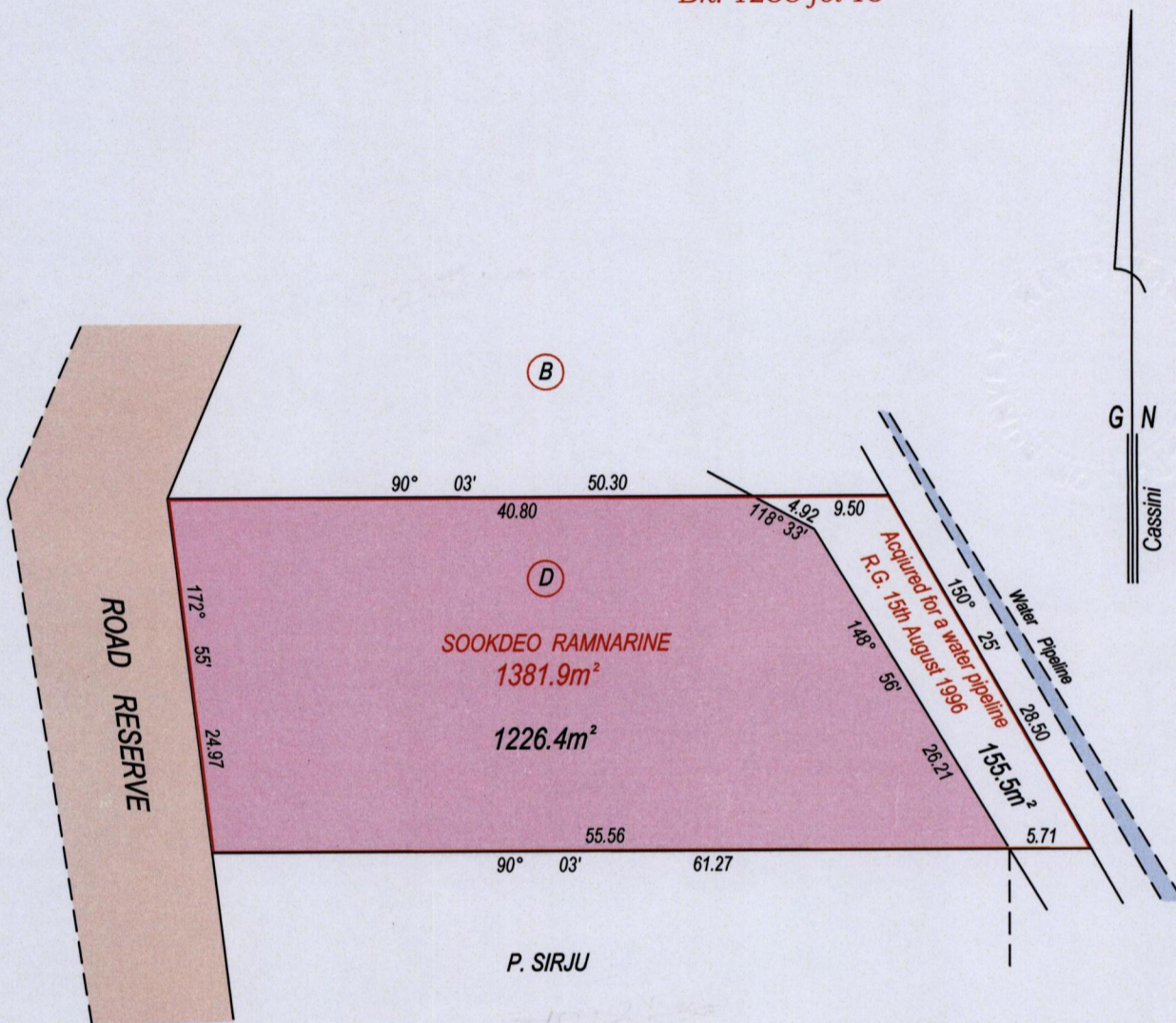

Approved

[Signature]
 Director of Surveys

2008 4 15

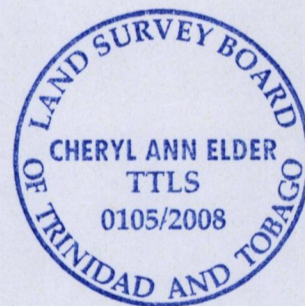

Sookdeo Ramnarine

SCALE : 1/500

Distances are in metres

To obtain compass bearings subtract 3 minutes

This is a true copy of a diagram of one thousand three hundred and eighty one point nine square metres originally transferred to SOOKDEO RAMNARINE showing a portion coloured pink and containing one thousand two hundred and twenty six point four square metres being the remainder after one acquisition

In accordance with Regulation 25(1) of the Land Surveyors' Regulations 1998.

I certify that this plan is correct.

Checked by *[Signature]* 2008 3 28

Entered on.....

[Signature]

 Trinidad & Tobago Land Surveyor

27th March, 2008

Vol. 5030 Fol. 175 Sookdeo Ramnarine

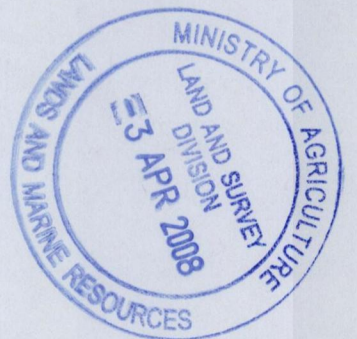

1418/08