

Process 122#65845

1287

147

R.P.O. Vol. 96 Fol. 101

Cadastral Sheet 72E, G16.M. 1/b,

C.T. Vol. 727 Fol. 367

Ward of Erin

County of St. Patrick

U.P.R.N. No.

VOL. 4177 Fol. 117

A. CHANGLING 407.3 m<sup>2</sup>  
C.T. Vol. 1037 Fol. 113

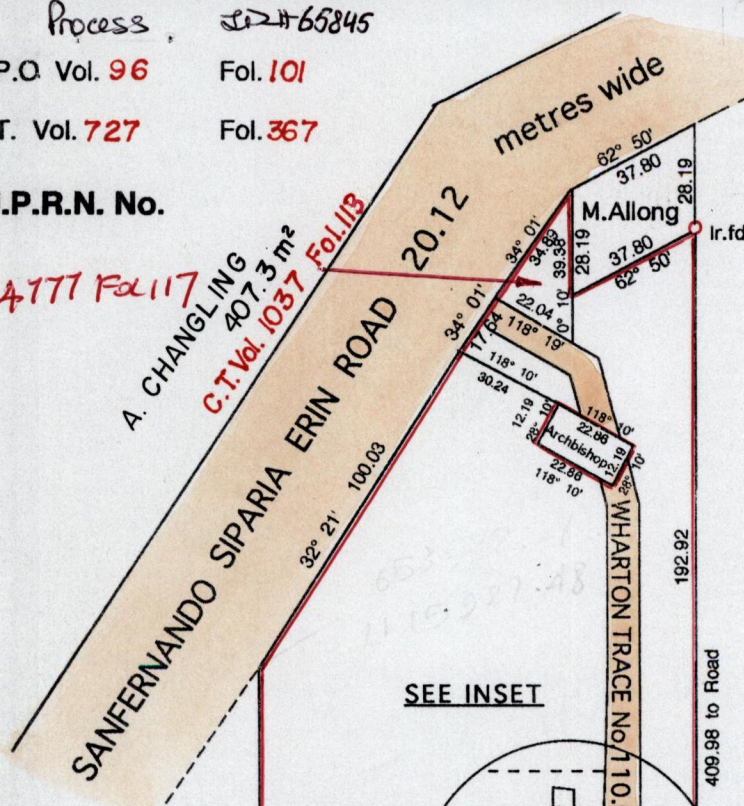

Louis Alcala then  
Palo Seco Agricultural Enterprises Limited

INSET

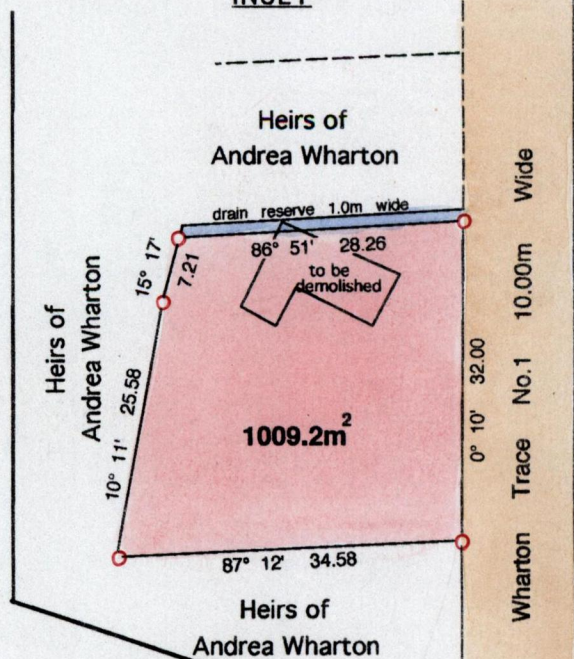

SCALE - 1 : 750

Venezuelan Consolidated Oilfields Limited now Palo Seco Agricultural Enterprises Limited

Louis Alcala then Palo Seco Agricultural Enterprises Limited

ANDREA WHARTON 3.8900 ha.

formerly Jules Figeroux

formerly Joseph Figeroux

Bk. 443 Fol. 248

Bk. 897 Fol. 140  
Bk. 435 Fol. 234&236

Approved: [Signature] Director of Surveys



Distances are in metres

SCALE 1 : 2000

Denotes Iron Put unless otherwise stated  
Bearings are Cassini Grid based on Solar Obs.

PLAN of a Parcel of land coloured pink in the Ward of Erin  
Containing one thousand and nine point two square metres  
Surveyed by me, with due authority, in February 2001

In accordance with Regulation 25(1) of the Land Surveyors' Regulations 1998, I certify that this plan is correct.

Checked by M.M. 2/2/04

[Signature]

Entered on [Signature]

Trinidad & Tobago Land Surveyor 3/1/04 2004

21-05-13