

1287

1287

13

L. and S.—53

Process ID#65623

Cadastral Sheet (C.22.H) 26A
3/c

U.P.R.N No

Ward of Manzanilla

R.P.O Vol. 20

Fol. 17

County of St. Andrew

C.T. Vol 3569

Fol. 421

Vol. 4283 fol. 147

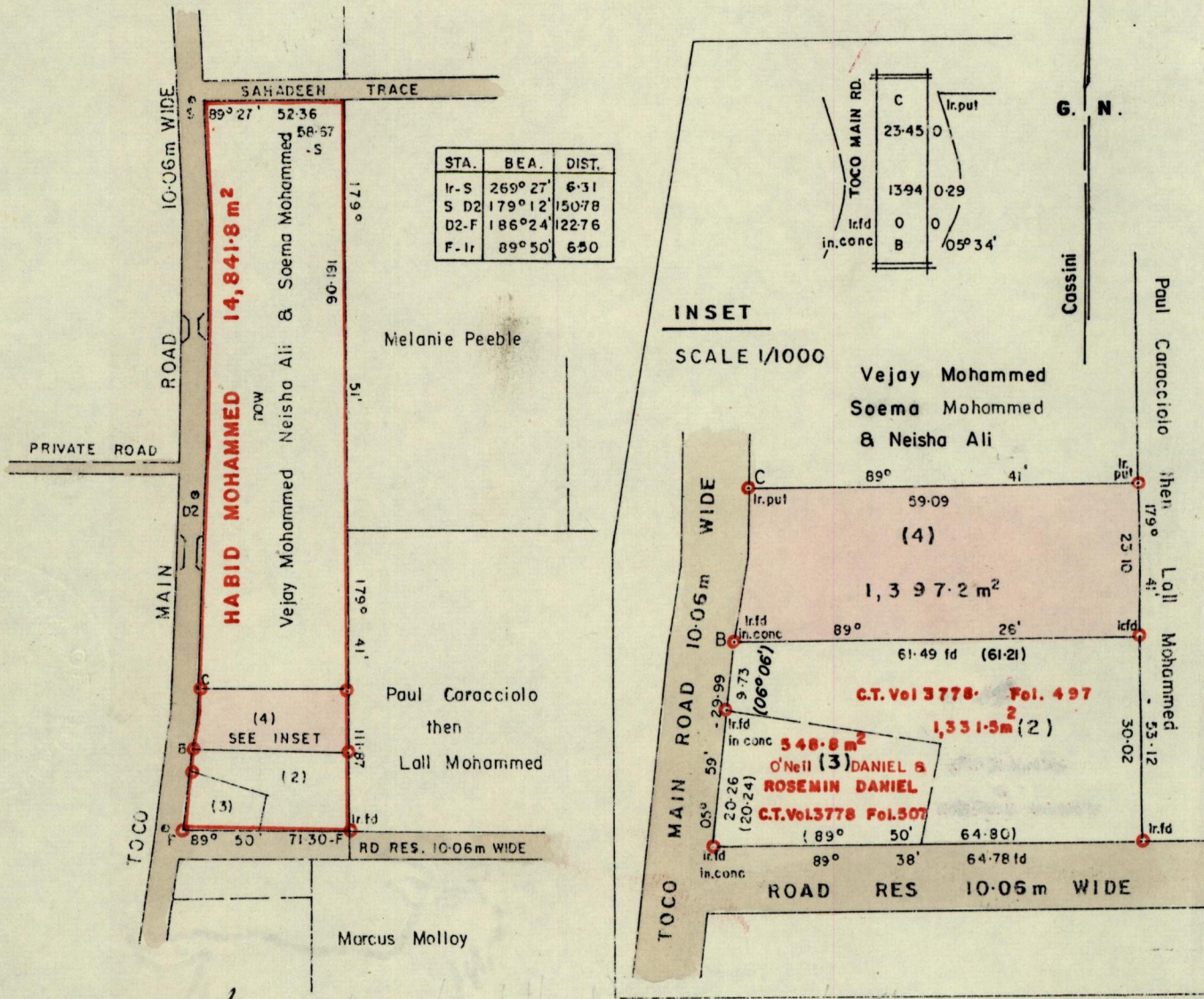

Approved *[Signature]*
Director of Surveys
2000-7-5

Church of the Nazarene of T&T
Church of the Nazarene
T&T

Bearings are based on solar observations.
SCALE 1 / 2500

ORIGINAL PLAN R.H. 263

In accordance with Rule 25(I) of the Land Surveyors Regulation 1998, I certify that this plan is correct.

Note: To obtain compass bearing subtract add 13 minutes Distances are in metres
PLAN of a Parcel of land coloured pink in the Ward of Manzanilla
Containing one thousand three hundred and ninety seven point two square metres

Surveyed by me, with due authority, in October 1999

Checked by *[Signature]* 26/05/00
Entered on *[Signature]* 26/05/00, Trinidad 20th May 2000.
and Tobago Land Surveyor.

